



2 BED APARTMENT WITHIN THE CITY

APARTMENT 1, MERCHANTS PLACE, MERCHANTGATE, YORK, YO1 9TU

Leasehold

savills

kitchen, dining, sitting room • 2 bedrooms •
bathroom

Local information

Merchant's Place is a sought-after development set alongside the River Foss and is ideally placed within the city walls with an abundance of amenities on the doorstep including several supermarkets, department stores, variety of excellent shops, fantastic restaurants and two theatres.

York's mainline railway station which offers regular services to major cities including Manchester, Edinburgh and London with some journeys taking less than two hours to Kings Cross.

About this property

This wonderful apartment is bright and spacious with a contemporary feel offering the best in city living with flexible and versatile accommodation.

The configuration of this apartment flows extremely well with a generous open plan living area, a well equipped kitchen, two bedrooms and a bathroom, ideal for entertaining and today's living. The property has the added benefit of secure gated access and below the building there is access to the bicycle store and in-house recycling facilities.

The apartment is certain to appeal to both investors and private buyers.

Tenure

Leasehold

Viewing

Strictly by appointment with Savills





APARTMENT 1, MERCHANTS PLACE,
MERCHANTGATE, YORK, YO1 9TU



savills

savills.co.uk

Savills York
01904 617 820
york@savills.com

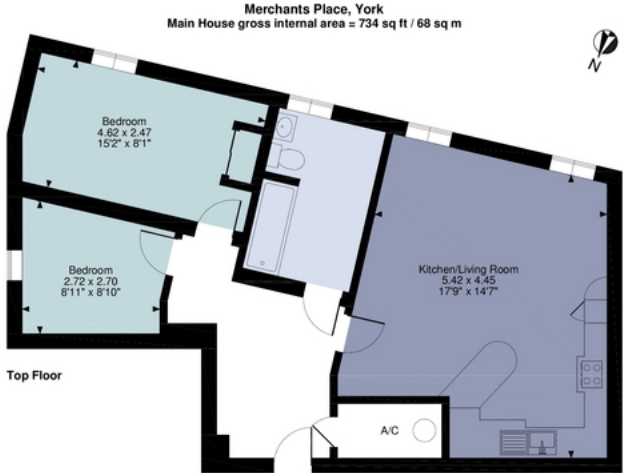

FOR ILLUSTRATIVE PURPOSES ONLY - NOT TO SCALE
The position & size of doors, windows, appliances and other features are approximate only.
© ehouse. Unauthorised reproduction prohibited. Drawing ref. dig/8398682/MSS

Energy Efficiency Rating		
	Current	Potential
Very energy efficient - lower running costs		
(92-100) A		
(81-91) B		
(69-80) C	76	77
(55-68) D		
(39-54) E		
(21-38) F		
(1-20) G		
Not energy efficient - higher running costs		
England, Scotland & Wales		EU Directive 2002/91/EC

Important notice: Savills, their clients and any joint agents give notice that 1: They are not authorised to make or give any representations or warranties in relation to the property either here or elsewhere, either on their own behalf or on behalf of their client or otherwise. They assume no responsibility for any statement that may be made in these particulars. These particulars do not form part of any offer or contract and must not be relied upon as statements or representations of fact. 2: Any areas, measurements or distances are approximate. The text, photographs and plans are for guidance only and are not necessarily comprehensive. It should not be assumed that the property has all necessary planning, building regulation or other consents and Savills have not tested any services, equipment or facilities. Purchasers must satisfy themselves by inspection or otherwise. 91020110 Job ID: 136890 User initials: SL

