



REMARKABLE FAMILY HOME SET IN STUNNING GROUNDS

TREETOPS,
19 CHELOW LANE, BRADFORD, WEST YORKSHIRE, BD9 6AX

Freehold

savills



REMARKABLE FAMILY HOME SET IN STUNNING GROUNDS

TREETOPS, 19 CHELOW LANE,
BRADFORD, WEST YORKSHIRE, BD9 6AX

Freehold

3 reception rooms, office, meditation/prayer room ♦ breakfast kitchen with pantry ♦ 6 bedrooms (3 en suite) ♦ 2 bathrooms ♦ laundry room ♦ gym/swimming pool, showers & sauna ♦ double garage ♦ garden ♦ EPC rating = C

Situation

Chellow lane is a leafy and well regarded address on the western outskirts of Bradford, with the local beauty spot Chellow Dean Reservoir closeby. Within 2.5 miles of the property there are two golf clubs, the Royal Infirmary (0.5 mile) and the train station is less than 3 miles with regular services to Manchester, Leeds and York. Leeds Bradford Airport is 9.5 miles distant.

The property is situated within an area referred to as Bronte Country, with the birthplace of the Brontes only 2.5 miles away. The Yorkshire Dales National Park lies to the north (19 miles), offering some of the country's most striking countryside.

Description

Treetops is a remarkable house created by the current owners in 2002 and set in 1.25 acres of landscaped gardens with a "babbling brook" running across the bottom of the garden.

The ground floor accommodation offers reception rooms ideal for entertaining and family life. There is a generous kitchen breakfast room which opens onto a south west facing terrace overlooking the garden. The lower ground floor offers six bedrooms and five bathrooms including the impressive master suite with a dressing room and shower room with a door leading to a terrace.

The second lower ground floor has a large room that has been used as a gym/office with doors to the terrace and has an adjacent double shower room and sauna. There is potential for the swimming pool below the flooring to be reinstalled. Some notable features include; Indian polished granite tiling, American white oak, European oak, Floss Italian lighting, some of the fittings consist of Grohe taps, Jacuzzi showers and baths, as well as underfloor heating.

The house is approached through electric gates where there is a double garage and parking. The garden is stunning with lawns and mature trees and a stream.

Viewing:

Strictly by appointment with Savills



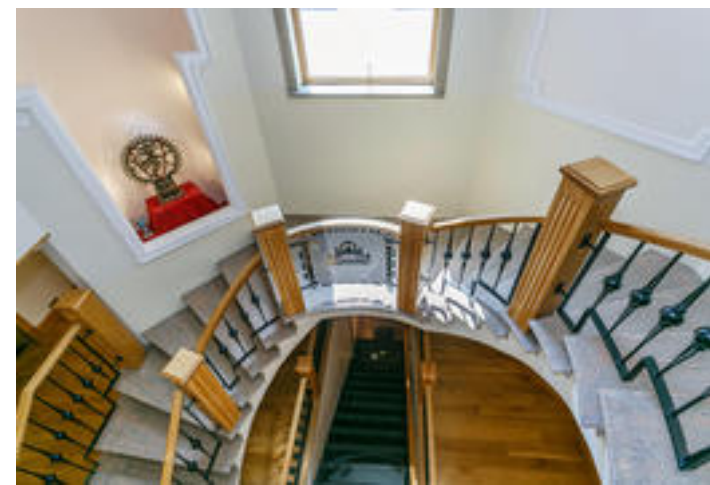



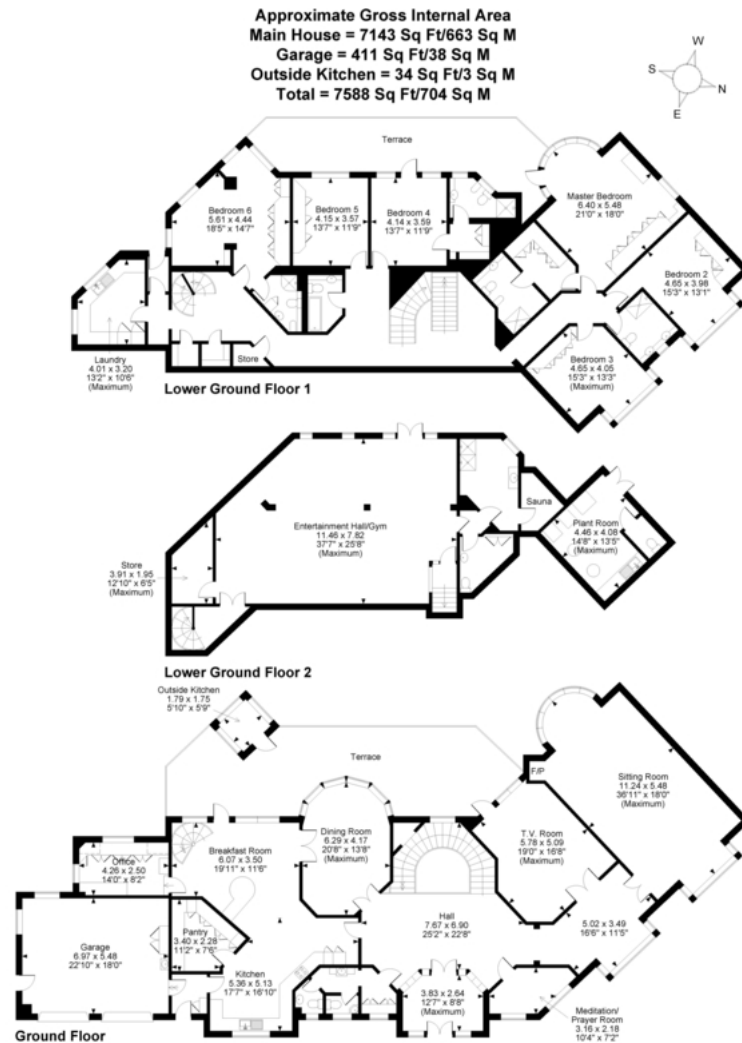

FOR ILLUSTRATIVE PURPOSES ONLY - NOT TO SCALE
The position & size of doors, windows, appliances and other features are approximate only.
Denotes restricted head height
© ehous. Unauthorised reproduction prohibited. Drawing ref. dig/8294559/MRB

Important notice: Savills, their clients and any joint agents give notice that 1: They are not authorised to make or give any representations or warranties in relation to the property either here or elsewhere, either on their own behalf or on behalf of their client or otherwise. They assume no responsibility for any statement that may be made in these particulars. These particulars do not form part of any offer or contract and must not be relied upon as statements or representations of fact. 2: Any areas, measurements or distances are approximate. The text, photographs and plans are for guidance only and are not necessarily comprehensive. It should not be assumed that the property has all necessary planning, building regulation or other consents and Savills have not tested any services, equipment or facilities. Purchasers must satisfy themselves by inspection or otherwise. 91023050 Job ID: 129176 User initials: JK

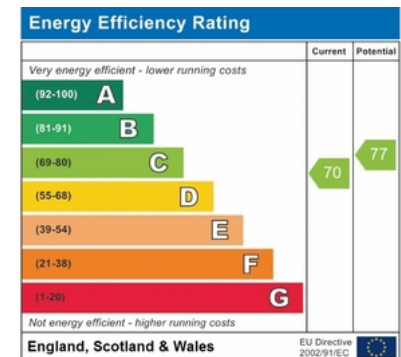

Savills York
york@savills.com
01904 617 820

savills.co.uk