



One bedroom Freehold townhouse close to Victoria

Greencoat Place, Westminster, London, SW1P

£750,000 Freehold



One bedroom house • Private entrance •
Ideal pied a terre • Freehold •
Close to Victoria Station

Local Information

Greencoat Place is a quiet and discreet street, between Victoria Street and Rochester Row.

Convenient for St James's Park and Victoria, this is a location that has seen significant regeneration and new development in recent years with Victoria Street now providing a significant lifestyle offer with an array of premium brand shops and restaurants including Jo Malone, Hugo Boss, The Ivy, and a Curzon Cinema.

Iconic landmarks locally include St James's Park, Westminster Abbey, Buckingham Palace and the Houses of Parliament, and transport connections are superb with mainline rail services including the Gatwick Express and Victoria Station and access to underground services on the Victoria, District and Circle and Jubilee Line all nearby.

St. James's Park Underground Station: approx 0.4 miles
Victoria Mainline Station: approx 0.4 miles

About this property

A discreet and contemporary house in the heart of Westminster, accommodation briefly comprises: a reception room, separate kitchen and bathroom. On the first floor there is large bedroom.

To our minds this is an ideal pied a terre.

Tenure
Freehold

Local Authority
Westminster Council

Energy Performance
EPC Rating = E

Viewing
All viewings will be accompanied and are strictly by prior arrangement through Savills Westminster & Pimlico Office.
Telephone: +44 (0) 203 430 6860.





Greencoat Place, Westminster, London, SW1P
Gross Internal Area 469 sq ft, 43.6 m²

Sales
Westminster & Pimlico
+44 (0) 203 430 6860
westminster@savills.com

 |  savills | savills.co.uk

Greencoat Place, SW1P

Gross internal area (approx) 43.57 sq m / 469 sq ft



Key :
CH - Ceiling Height

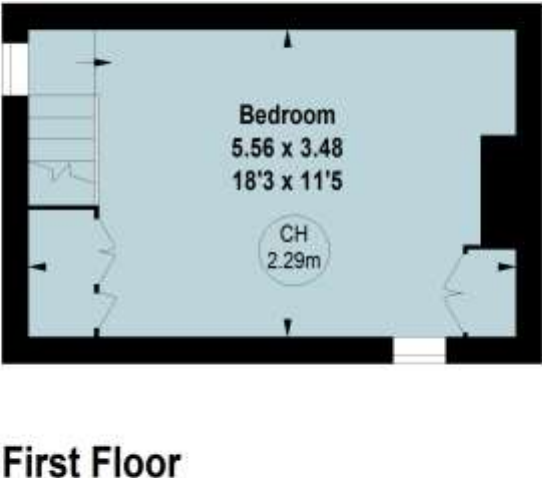
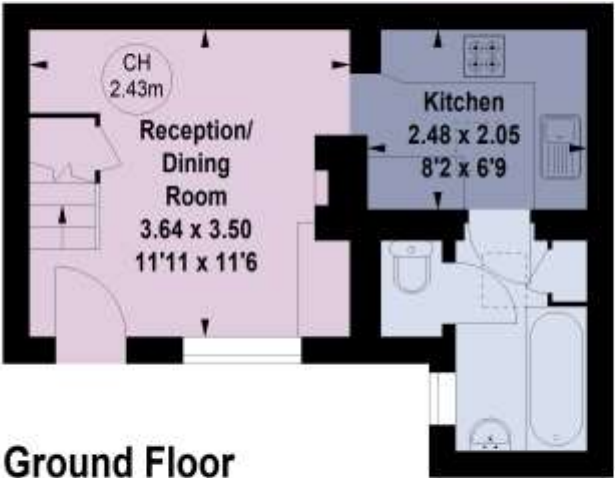

For Identification Only. Not To Scale.
© Click London Limited

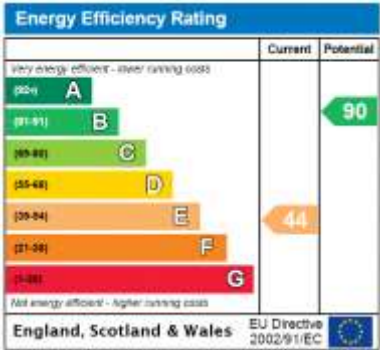

Important Notice Savills, its clients and any joint agents give notice that 1: They are not authorised to make or give any representations or warranties in relation to the property either here or elsewhere, either on their own behalf or on behalf of their client or otherwise. They assume no responsibility for any statement that may be made in these particulars. These particulars do not form part of any offer or contract and must not be relied upon as statements or representations of fact. 2: Any areas, measurements or distances are approximate. The text, photographs and plans are for guidance only and are not necessarily comprehensive. It should not be assumed that the property has all necessary planning, building regulation or other consents and Savills have not tested any services, equipment or facilities. Purchasers must satisfy themselves by inspection or otherwise. 20211007EMML

