



Fantastic apartment in riverside development

Riverlight Quay, Nine Elms, London, SW8

Leasehold



Open plan reception/
kitchen • 2 bedrooms • 2
bathrooms • Concierge •
Balcony

Local information

Riverlight Quay is positioned on the banks of the River Thames in Nine Elms. Residents benefit from 24 hour security and concierge service, as well as a range of on site amenities including a grocery store, cafes and restaurants and access to a private swimming pool and gym. Riverlight is located to benefit from the surrounding Nine Elms regeneration, including the new amenities at Battersea Power Station and future Northern Line extension.

About this property

This apartment is situated on the 7th floor of Riverlight Quay, with a sunny west facing aspect allowing plenty of natural light. Accommodation spans over 819 sq ft and is well arranged to provide two generous bedrooms, two bath/shower rooms and an open plan reception room/kitchen. Each room has access to one of two balconies.

These photos were taken in 2016.

Tenure

Leasehold

EPC rating = B

Riverlight Quay, Nine Elms, London, SW8



savills

savills.co.uk

Waterfront Team

Savills Battersea Bridge Road

020 8877 4823

waterfrontlondon@savills.com

Riverlight

Approx. Gross Internal Area 819 Sq Ft - 76.06 Sq M

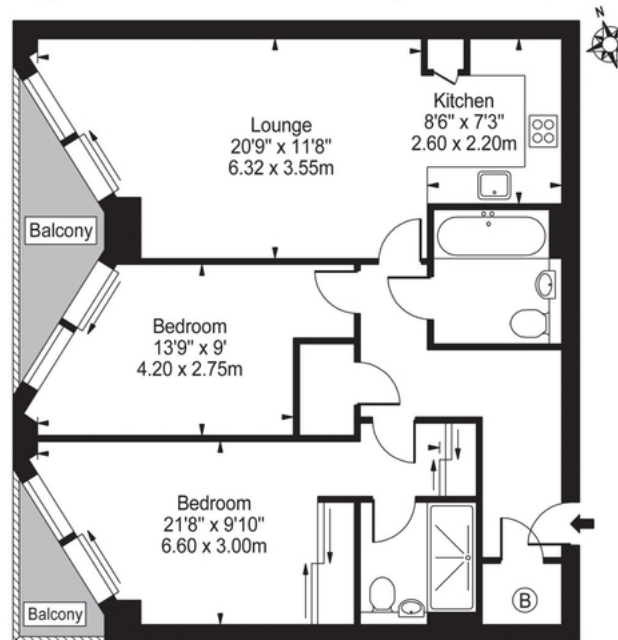

Seventh Floor

For Illustration Purposes Only - Not To Scale

This floor plan should be used as a general outline for guidance only and does not constitute in whole or in part an offer or contract. Any intending purchaser or lessee should satisfy themselves by inspection, searches, enquiries and full survey as to the correctness of each statement. Any areas, measurements or distances quoted are approximate and should not be used to value a property or be the basis of any sale or let.

Energy Efficiency Rating		Current	Potential
Very energy efficient - lower running costs			
(92-100) A			
(81-91) B		86	86
(69-80) C			
(55-68) D			
(39-54) E			
(21-38) F			
(1-20) G			
Not energy efficient - higher running costs			
England, Scotland & Wales		EU Directive 2002/91/EC	

Important notice: Savills, their clients and any joint agents give notice that 1: They are not authorised to make or give any representations or warranties in relation to the property either here or elsewhere, either on their own behalf or on behalf of their client or otherwise. They assume no responsibility for any statement that may be made in these particulars. These particulars do not form part of any offer or contract and must not be relied upon as statements or representations of fact. 2: Any areas, measurements or distances are approximate. The text, photographs and plans are for guidance only and are not necessarily comprehensive. It should not be assumed that the property has all necessary planning, building regulation or other consents and Savills have not tested any services, equipment or facilities. Purchasers must satisfy themselves by inspection or otherwise. 02027012 Job ID: 144047 User initials: TO

