



CHARMING COTTAGE IN DELIGHTFUL LOCATION

QUINCE COTTAGE, LOVEL ROAD, WINKFIELD SL4 2EU

Freehold



SUPERB GARDEN PERFECT FOR ENTERTAINING

QUINCE COTTAGE LOVEL ROAD, WINKFIELD SL4 2EU

Reception hall ♦ 2 reception rooms ♦
kitchen/breakfast room ♦ 4 bedrooms (1
ensuite) ♦ shower room ♦ garage ♦ off-
street parking ♦ garden ♦ EPC rating = D

Situation

Quince Cottage is situated in a semi-rural location, to the west of Windsor Forest and Great Park, within easy reach of Windsor and Ascot, both of which offer an extensive range of shopping and leisure facilities.

For the commuter, the M4 (Junction 6) is about 5 miles away. Rail connections to London (Waterloo) are available from Ascot and Windsor and to London (Paddington) from Windsor (via Slough). Crossrail, the new high-speed service is due to begin running from Maidenhead in 2019.

Description

Quince Cottage is a superbly presented character home. The wonderful rear garden has a large sun terrace which enjoys views over the grounds of Winkfield Lodge.



Ground Floor

- Reception hall
- Triple aspect drawing room with feature fireplace and French doors opening onto the sun terrace
- Charming sitting room with front facing views, feature fireplace, original beams and plate rail
- Spacious kitchen/dining room with a comprehensive range of units, integrated appliances and two skylights. Large dining space with two sets of French doors opening onto the garden terrace
- Cloakroom

First Floor

- Charming master bedroom with French doors opening to a Juliet balcony with wonderful views and en suite bathroom
- Pretty bedroom 2 has large windows with double aspect views and a pitched beamed ceiling
- 2 further beautifully presented bedrooms
- Fully tiled family shower room

To the front of the property is a gravelled driveway which provides access to the garage and parking for several cars. To the rear the pretty garden has well planted beds and an immaculate lawn. The large decked sun terrace provides a wonderful space to enjoy outdoor entertaining whilst enjoying the glorious views.

NB: We wish to inform buyers of this property that the seller is an employee of Savills.



Level Road, Winkfield, Windsor, SL4

Gross internal floor area (approx):

181.5 sq m / 1954 sq ft (Includes Garage)

For identification only - Not to scale

Niche Communications

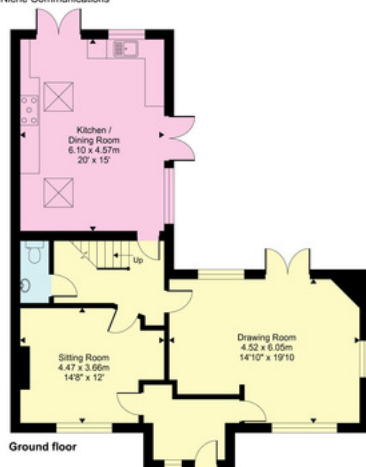

Savills Windsor
windsor@savills.com
01753 834 600

savills.co.uk

Important notice: Savills, their clients and any joint agents give notice that 1: They are not authorised to make or give any representations or warranties in relation to the property either here or elsewhere, either on their own behalf or on behalf of their client or otherwise. They assume no responsibility for any statement that may be made in these particulars. These particulars do not form part of any offer or contract and must not be relied upon as statements or representations of fact. 2: Any areas, measurements or distances are approximate. The text, photographs and plans are for guidance only and are not necessarily comprehensive. It should not be assumed that the property has all necessary planning, building regulation or other consents and Savills have not tested any services, equipment or facilities. Purchasers must satisfy themselves by inspection or otherwise. 81021170 Job ID: 125710 User initials: JF

