



## Delightful period cottage in the heart of Bray

**Jersey Cottage, High Street, Bray, Berkshire SL6 2AH**

Freehold



Reception vestibule • 2 reception rooms • kitchen/ breakfast room • 3 bedrooms • family bathroom • 2 cloakrooms • garage • garden

### Local information

Jersey Cottage is situated at the heart of the picturesque culinary village of Bray and is close to the renowned Michelin starred restaurants, the Fat Duck, Waterside Inn and Hinds Head. Maidenhead offers a wide range of shopping and leisure amenities, with further amenities being available in Windsor.

There is extensive schooling in the area including Oldfield School, Braywick Court Free School, Holyport College sponsored by Eton College, St. Piran's, Highfield Preparatory School and Claire's Court in the local area. As well as Upton House and St. George's in Windsor, Papplewick and St. Mary's in Ascot and Eton College. NB. Please refer to schools directly for admissions policies.

For the commuter rail access to London (Paddington) is available from Maidenhead; Crossrail, the new high speed service, is due to begin running soon. The M4 is easily accessible, leading to Heathrow Airport, Central London, the West Country and the M25.

### About this property

Jersey Cottage is set in the heart of picturesque Bray village. The property offers stylish character accommodation over two floors.

Entered via the entrance vestibule the reception hall is currently being used a study space with a view to the front of the property. The delightful

sitting room also has front facing views and a feature fireplace. The kitchen/dining room has a comprehensive range of country style units, central island, integrated appliances, contrasting worktops, side access door and views over the garden. The kitchen is open plan to the dining room which has French doors opening onto the garden terrace. A cloakroom completes the accommodation on this floor.

On the first floor, there is an attractive master bedroom with high ceiling, garden views and bespoke fitted wardrobes. Two further beautifully presented bedrooms and a modern family bathroom with twin vanity sinks, bath tub and separate shower complete the accommodation on this floor.

To the front of the property is access to the garage parking. To the rear of the property is a delightful walled garden. Landscaped to include a well-kept lawn with sleeper edged borders which have been thoughtfully planted to enhance this charming space. A paved sun terrace adjoining the house is the perfect spot for outdoor entertaining. Additionally there are two useful store rooms to the rear of the garage.

### Tenure

Freehold

### Local Authority

Royal Borough of Windsor & Maidenhead







**Jersey Cottage, High Street, Bray, Berkshire SL6 2AH**  
**Gross internal area (approx)** 1641 sq ft  
**Garage** 170 sq ft  
**Total** 1811



**Suzy Lambert**  
Savills Windsor  
**01753 834 600**  
windSOR@savills.co.uk

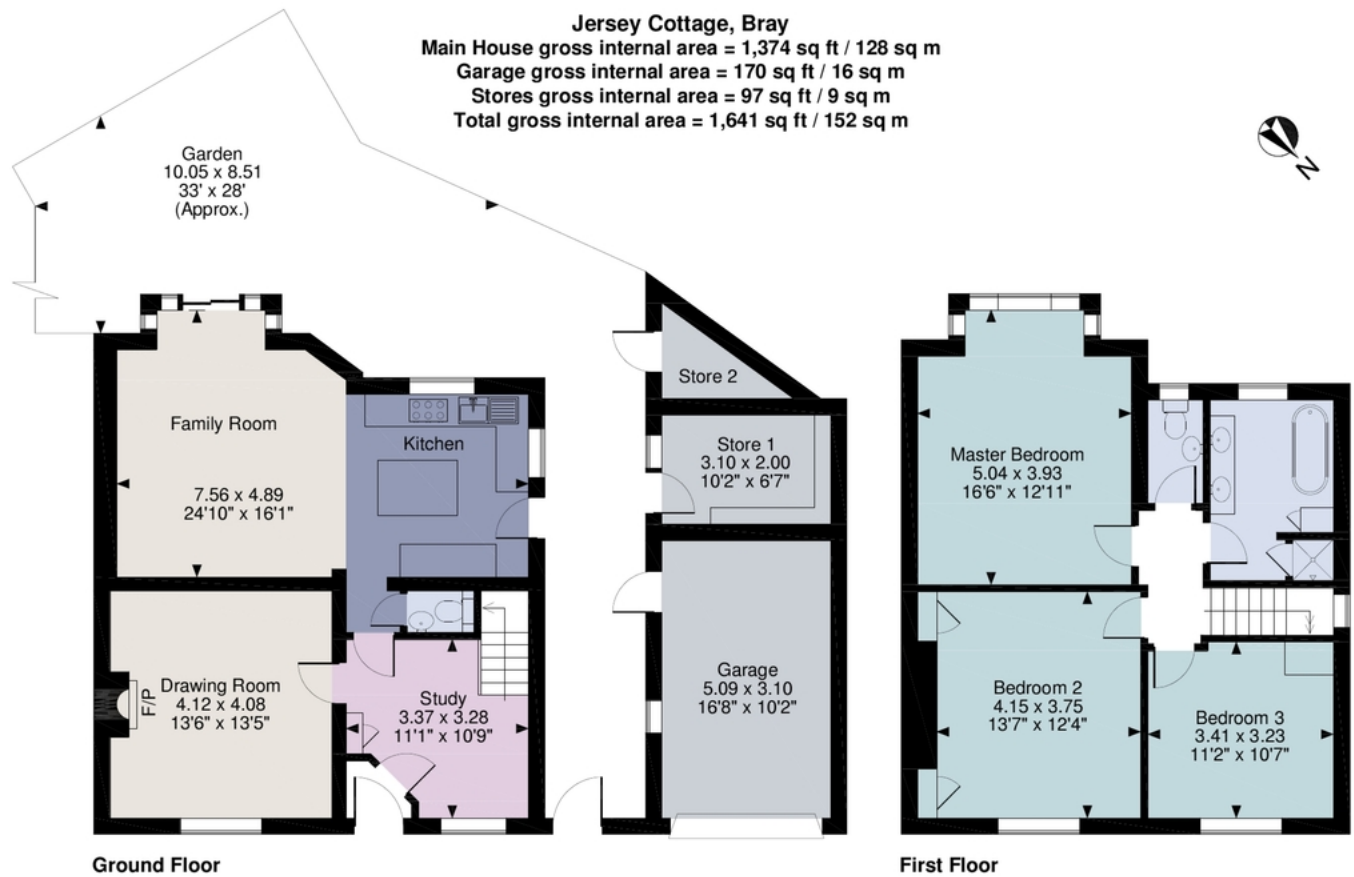

**FOR ILLUSTRATIVE PURPOSES ONLY - NOT TO SCALE**  
The position & size of doors, windows, appliances and other features are approximate only.  
© ehouse. Unauthorised reproduction prohibited. Drawing ref. dig/8135457/JBN

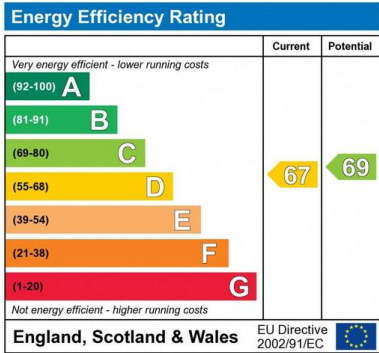

**Important notice:** Savills, their clients and any joint agents give notice that 1: They are not authorised to make or give any representations or warranties in relation to the property either here or elsewhere, either on their own behalf or on behalf of their client or otherwise. They assume no responsibility for any statement that may be made in these particulars. These particulars do not form part of any offer or contract and must not be relied upon as statements or representations of fact. 2: Any areas, measurements or distances are approximate. The text, photographs and plans are for guidance only and are not necessarily comprehensive. It should not be assumed that the property has all necessary planning, building regulation or other consents and Savills have not tested any services, equipment or facilities. Purchasers must satisfy themselves by inspection or otherwise. 91027003 Job ID: 133661 User initials: JF

