



Stunning modern townhouse close to town centre

17 Kensington Mews, Windsor, Berkshire SL4 3FA

Freehold



Reception hall • 2 Reception rooms • 4 bedrooms (3 en suite) • Family bathroom • Cloakroom • Garden • 2 off street parking spaces

Local information

Kensington Mews is a gated development situated off St. Leonards Road, to the south of Windsor town centre which offers an excellent range of shopping and leisure facilities, numerous bars and restaurants.

There are rail connections from Windsor Riverside station to London Waterloo and to London Paddington from Windsor Central (via Slough). The M4 is available via junction 6, which provides access to Heathrow Airport, Central London and the M25.

Sporting facilities in the area include golf at Datchet, Hawthorn Hill, the Royal Berkshire, Wentworth and Sunningdale; horse racing at Windsor and Ascot; watersports on Bray and Dorney Lakes; rowing and boating on some stretches of the River Thames.

Extensive schooling in the region include St. George's, Upton House in Windsor; Eton College; St. John's Beaumont in Old Windsor; Bishopsgate; Papplewick, Heathfield, St. Mary's and St. George's in Ascot.

About this property

The flexible living space has been created to satisfy the needs of a modern lifestyle and is suitable for both informal family life and entertaining.

Situated on the ground floor is a sleek modern kitchen/breakfast room and an elegant sitting room that opens out to a recently

added bright and airy garden room featuring a large roof lantern.

The property benefits from a master bedroom with dressing area which has floor to ceiling wardrobes and en suite bathroom. Bedroom two has fitted wardrobes and superb en suite. Additionally the top floor contains two further bedrooms benefiting from Jack & Jill access to a family bathroom, one of which has views to Windsor Castle.

To the front of the property there's a driveway and off street parking for two cars. To the rear there is a charming paved courtyard style garden that enjoys a southerly aspect and is stocked with a wide variety of flowering plants/shrubs, perfect for 'al fresco' dining. Additionally there is a large shed for storage.

Tenure

Freehold

Local Authority

Roayal Borough of Windsor & Maidenhead

EPC rating = B

Viewing

Strictly by appointment with Savills





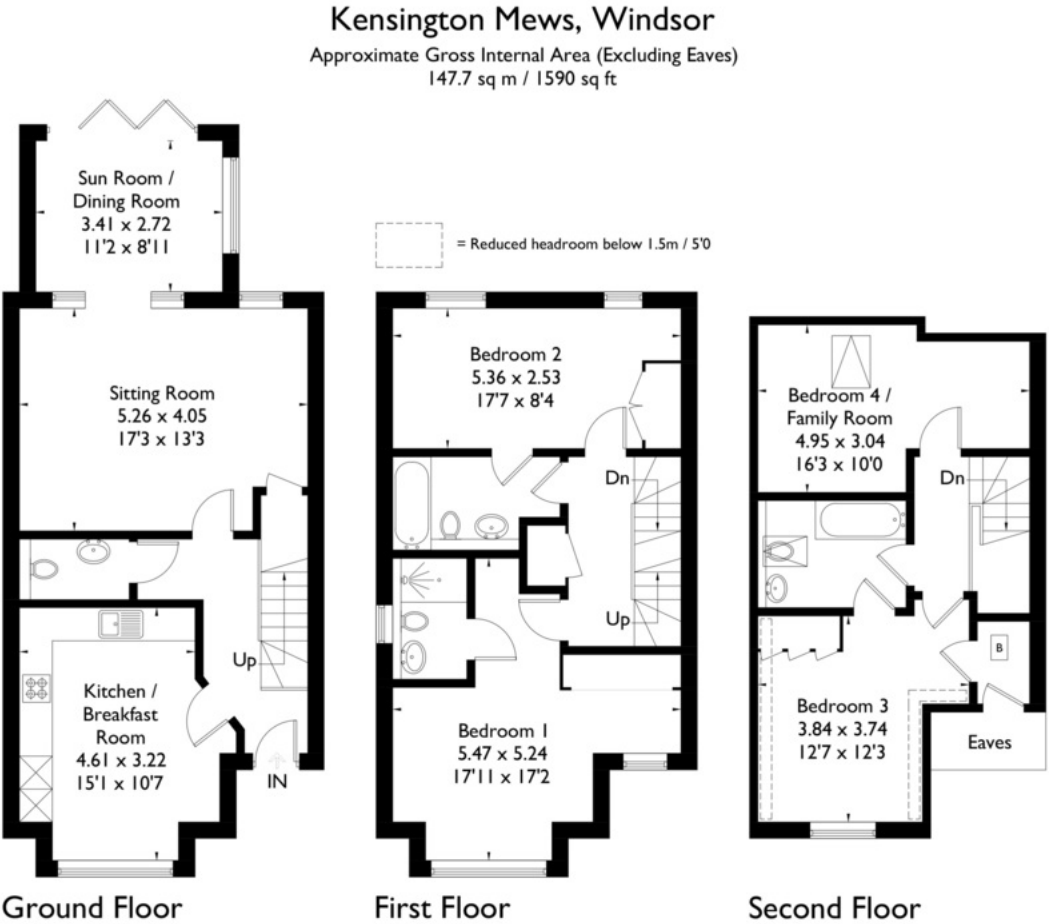

FLOORPLANZ © 2018 0203 9056099 Ref: 218585
This plan is for layout guidance only. Drawn in accordance with RICS guidelines. Not drawn to scale unless stated. Windows & door openings are approximate.
Whilst every care is taken in the preparation of this plan, please check all dimensions, shapes & compass bearings before making any decisions reliant upon them.

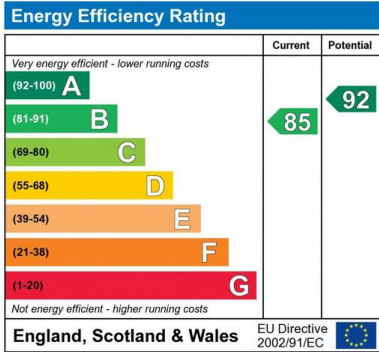

Important notice: Savills, their clients and any joint agents give notice that 1: They are not authorised to make or give any representations or warranties in relation to the property either here or elsewhere, either on their own behalf or on behalf of their client or otherwise. They assume no responsibility for any statement that may be made in these particulars. These particulars do not form part of any offer or contract and must not be relied upon as statements or representations of fact. 2: Any areas, measurements or distances are approximate. The text, photographs and plans are for guidance only and are not necessarily comprehensive. It should not be assumed that the property has all necessary planning, building regulation or other consents and Savills have not tested any services, equipment or facilities. Purchasers must satisfy themselves by inspection or otherwise. 91026082 Job ID: 133586 User initials: JF