



A luxurious Manor House with extensive grounds

Oak Bray Manor, Drift Road, Windsor, Berkshire SL4 4QQ

Freehold



5 reception rooms • kitchen/breakfast room • study & wine room • 7 bedrooms • 7 bathrooms • utility room • gardens, paddock & grounds of about 8 acres • 3 vehicle carport & tractor shed with storage above

Local information

Oak Bray Manor enjoys a semi-rural setting in Winkfield yet is within easy reach of the shopping and leisure facilities that may be found at Windsor and Ascot, both about 6 miles away. Road connections are good, with Junction 8/9 of the M4 about 4 miles distant; rail access to London Paddington is available from Maidenhead and Taplow and both Waterloo and Paddington (via Slough) are available from Windsor. Crossrail, the new-high speed service, is due to begin running from Maidenhead soon.

Sporting and recreational facilities in the area include racing at Ascot and Windsor; golf at the nearby Birds Golf Centre and in Maidenhead, Sunningdale and the renowned Wentworth; polo at The Royal Berkshire Polo Club in Winkfield, the Guards Polo Club in Windsor Great Park and the Fifield polo club; riding in Windsor Great Park and the surrounding countryside; flying at White Waltham Airfield. For all of the family there is Windsor Castle, Legoland and the Theatre Royal Windsor.

Windsor, Ascot and the surrounding area are well known for their boutiques, bars, brasseries and traditional country public houses. The area also boasts some of the finest restaurants with Coworth Park in Ascot, as well as the Michelin starred Waterside Inn, Fat Duck and Hinds Head in Bray. Leisure facilities in the area include golf at Wentworth, Sunningdale and

The Berkshire, polo at Coworth Park, the Royal County of Berkshire Polo Club and Guards Polo Club, and boating on the River Thames.

There is extensive schooling in the area including St. George's Windsor Castle, Brigidine and Upton House in Windsor; Heathfield, St. George's and Papplewick in Ascot, Lambrook in Winkfield Row and Eton College. Holyport College, the new 'free school' sponsored by Eton College is situated just 3 miles away.

About this property

Oak Bray Manor is a magnificent timber frame manor house set within approximately 8 acres of grounds, comprising landscaped gardens and paddocks giving the property an attractive outlook across the Berkshire countryside. This beautifully-designed property offers luxury accommodation arranged over three floors, combining traditional features such as oak timbers and state-of-the-art technology creating a wonderfully warm family home.

On entering the property the stunning hand-crafted oak staircase is lit by the double height window creating immediate visual impact and appeal. Particular features of the ground floor include the exposed brick inglenook fireplaces in both the sitting room and garden room; the garden room in particular offers a charming space to enjoy the scenic vistas. The luxury fitted kitchen with





Miele appliances, bespoke low-level seating area, integrated music system and 43" wall-mounted television leading through to the family room. The three further reception rooms offer flexibility and space for entertaining/family occasions.

On the first floor the rooms are arranged around the generous landing. The impressive master bedroom suite benefits from a fitted dressing room, and dual bathroom and shower room. There are two further bedrooms on this floor (one en suite and one en suite with fitted dressing room).

The second floor is arranged around a spacious landing area with capacity for further use. There is a home cinema with a 75" smart television with a top of the range surround sound system, a study, two further bedrooms and two shower rooms completing the accommodation on this floor .

Outside is the three car carport and tractor shed which also has stairs to a first floor for storage. This building has power and plumbing and could have a variety of uses. The gardens have been thoughtfully landscaped to provide year round interest. The stone terrace and pathways wrap around the house allowing a variety areas to enjoy the gardens.

Specifications

Luxury fitted kitchen with integral Miele appliances & water softener
Under floor heating throughout ground and first floor
Touch screen thermostatic controllers
Bespoke wardrobes in all bedrooms
High quality bathroom fittings
Handmade solid oak staircases, timber windows and oak beams
Integral home entertainment system with fitted screens
State-of-the-art security system
Handmade iron automated gates with video entry intercom and remote control
External down to dusk lighting
Natural Riven Stone terrace and pathways
Landscaped gardens

Agents Note - photography taken 25/09/2017

Tenure

Freehold

Local Authority

Royal Borough of Windsor & Maidenhead

EPC rating = C

Viewing

Strictly by appointment with Savills

Oak Bray Manor, Drift Road, Windsor, Berkshire SL4 4QQ

Gross internal area (approx) 5774 sq ft

Outbuildings 1657 sq ft

Total 7431 sq ft



savills

savills.co.uk

Savills Windsor
01753 834 600
windsor@savills.com

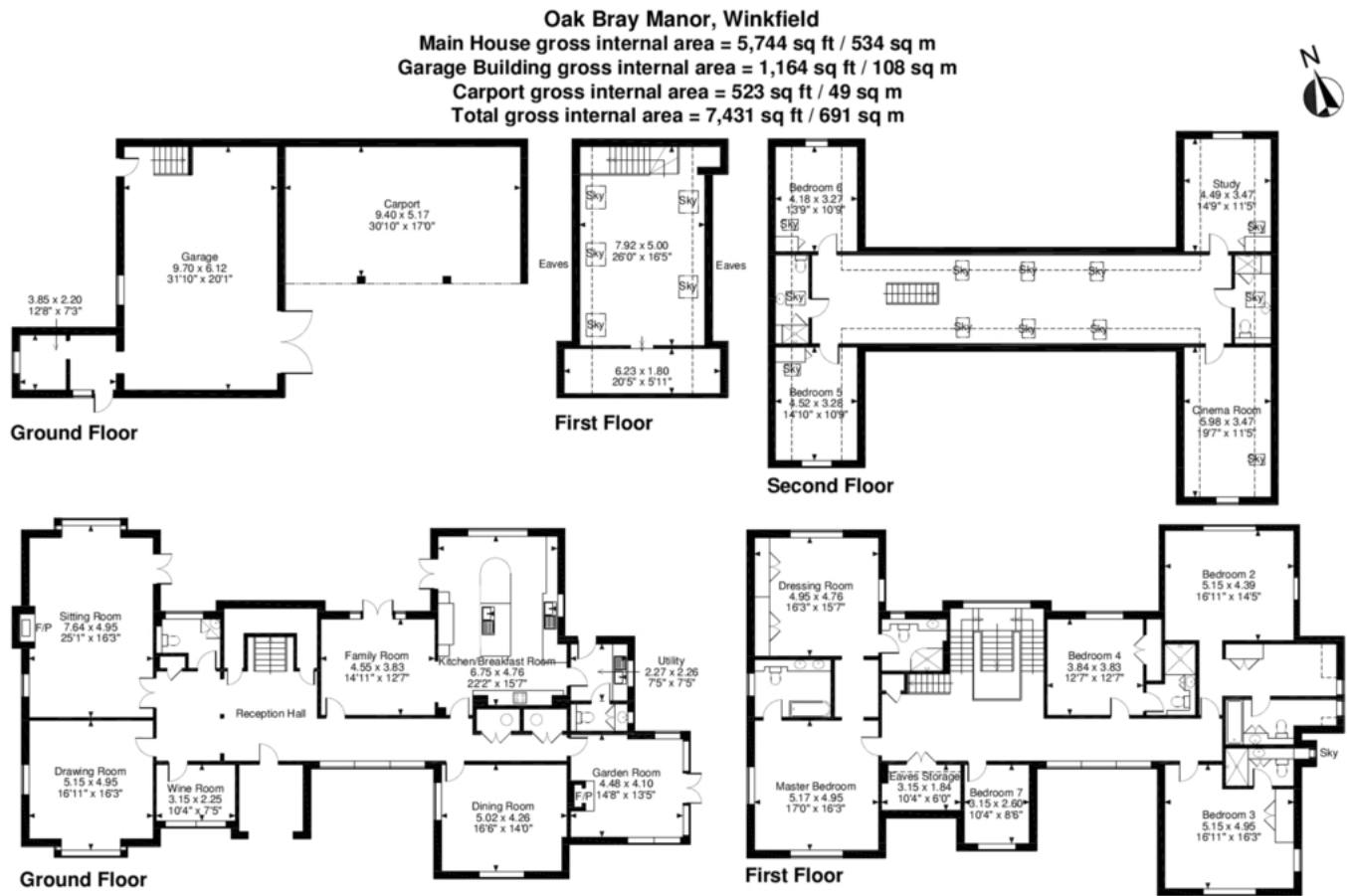

FOR ILLUSTRATIVE PURPOSES ONLY - NOT TO SCALE
The position & size of doors, windows, appliances and other features are approximate only.
--- Denotes restricted head height
© ehouse. Unauthorised reproduction prohibited. Drawing ref. dig/8251632/NJD

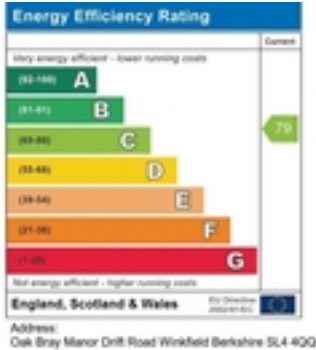

Important notice: Savills, their clients and any joint agents give notice that 1: They are not authorised to make or give any representations or warranties in relation to the property either here or elsewhere, either on their own behalf or on behalf of their client or otherwise. They assume no responsibility for any statement that may be made in these particulars. These particulars do not form part of any offer or contract and must not be relied upon as statements or representations of fact. 2: Any areas, measurements or distances are approximate. The text, photographs and plans are for guidance only and are not necessarily comprehensive. It should not be assumed that the property has all necessary planning, building regulation or other consents and Savills have not tested any services, equipment or facilities. Purchasers must satisfy themselves by inspection or otherwise. 91022131 Job ID: 138988 User initials: JF

