



A charming two bedroom first floor flat

St. Ann's Crescent, London, SW18

Share of Freehold





Local Information

St. Ann's Crescent is situated in the heart of a predominately residential area. Wandsworth Town station provides the nearest mainline transport with services into Waterloo. The area is well known for the excellent recreational facilities of Wandsworth Common and benefits from a wide selection of local shops, bars, restaurants and Southside shopping center.

About this property

Located on the first floor of a beautiful period conversion, is this two bedroom flat. As you enter the property, on the left hand side, is the bright and spacious reception room/dining area. The reception room benefits from a large bay window, allowing an abundance of natural light to flow throughout, as well as unobstructed views over St. Ann's Crescent. The kitchen is located just off the reception room, and benefits from an array of integrated appliances. To the rear of the property are the two double bedrooms, both benefitting from built in wardrobe space. Completing the property is the family bathroom.

Tenure

Share of Freehold

Local Authority

London Borough of Wandsworth

Energy Performance

EPC Rating = D

Viewing

All viewings will be accompanied and are strictly by prior arrangement through Savills Wandsworth Office.

Telephone:

+44 (0) 20 8877 1222.



St. Ann's Crescent, London, SW18
Gross Internal Area 686 sq ft, 63.7 m²

St Ann's Crescent, SW18
Gross internal area (approx.):
63.7 sq.m. (686 sq.ft.)
For identification purposes only. Not to scale.
Floorplanners ©

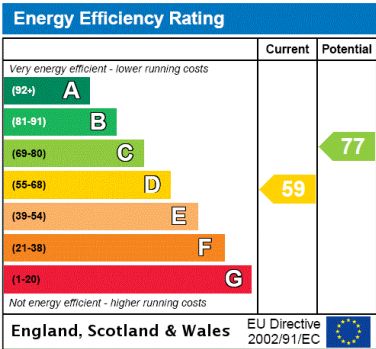
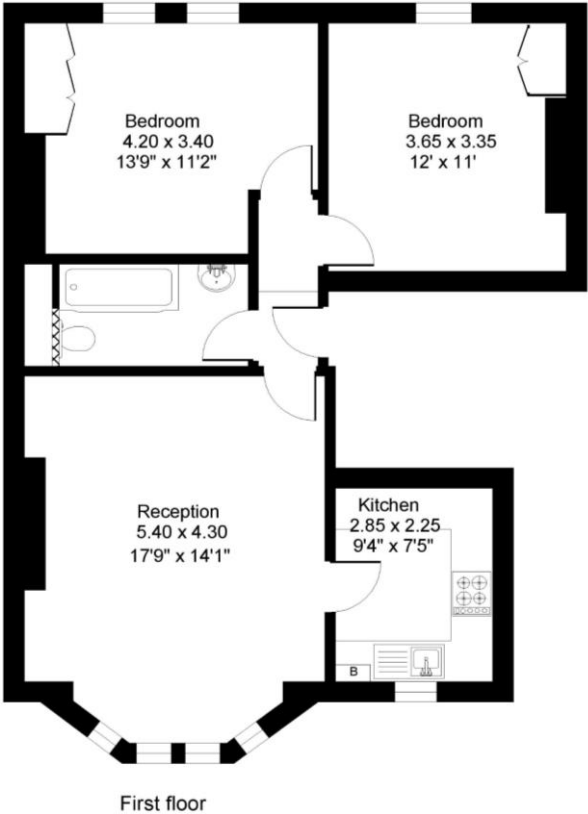

Important Notice Savills, its clients and any joint agents give notice that 1: They are not authorised to make or give any representations or warranties in relation to the property either here or elsewhere, either on their own behalf or on behalf of their client or otherwise. They assume no responsibility for any statement that may be made in these particulars. These particulars do not form part of any offer or contract and must not be relied upon as statements or representations of fact. 2: Any areas, measurements or distances are approximate. The text, photographs and plans are for guidance only and are not necessarily comprehensive. It should not be assumed that the property has all necessary planning, building regulation or other consents and Savills have not tested any services, equipment or facilities. Purchasers must satisfy themselves by inspection or otherwise. 20201005TACB

