



A bright and spacious, recently redecorated two bedroom flat with secure allocated parking.

**Berisford Mews, London, SW18**

£1,600 pcm plus fees apply, Furnished  
Available from 01.10.2020



- Two bedrooms
- Two bathrooms
- Balcony
- Allocated secure parking
- Private gated mews development
- Recently refurbished
- Communal garden

#### Local Information

Berisford Mews is close to the open spaces of Wandsworth Common and the shops and amenities of the Southside Centre with both Waitrose and Sainsbury's. There are a variety of local shops and restaurants nearby and transport is good from Wandsworth Town mainline station (0.6 miles away) plus numerous bus services in the area. The area is well known for its superb schools both state and private.

#### About this property

This modern first floor two bedroom flat is securely situated within a private gated mews development with allocated parking.

The flat has recently been fully redecorated and features two double bedrooms with ample storage space, the principal bedroom benefits from an en suite and there is a further separate bathroom, both include a shower and a bath.

The spacious open plan dining and reception room leads out onto the balcony overlooking the communal gardens.

#### Furnishing

Furnished

#### Local Authority

Wandsworth

Council Tax Band = E

#### Energy Performance

EPC Rating = C

#### Viewing

All viewings will be accompanied and are strictly by prior arrangement through Savills Wandsworth Lettings Office. Telephone: +44 (0) 20 8877 4820.







Berisford Mews, London, SW18  
Gross Internal Area 637 sq ft, 59.2 m<sup>2</sup>



savills

savills.co.uk

**Zoe Sutcliffe**  
Wandsworth Lettings  
**+44 (0) 20 8877 4820**  
zoe.sutcliffe@savills.com



**Berisford Mews, SW18**  
Approximate Gross Internal Area  
**59.21 sq m / 637 sq ft**  
( CH = Ceiling Heights )

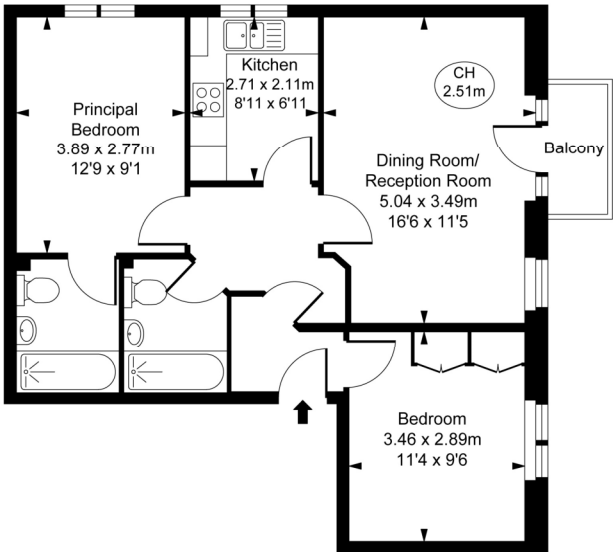

First Floor

This plan is not to scale. It is for guidance and not for valuation purposes.  
All measurements and areas are approximate only, and have been prepared in accordance with the current edition of the RICS Code of Measuring Practice.  
© Fulham Performance

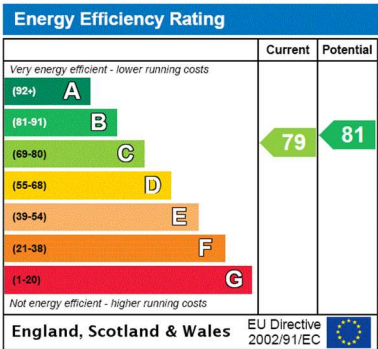

**Important notice** Savills, their clients and any joint agents give notice that: 1. They are not authorised to make or give any representations or warranties in relation to the property either here or elsewhere, either on their own behalf or on behalf of their client or otherwise. They assume no responsibility for any statement that may be made in these particulars. These particulars do not form part of any offer or contract and must not be relied upon as statements or representations of fact. 2. Any areas, measurements or distances are approximate. The text, images and plans are for guidance only and are not necessarily comprehensive. It should not be assumed that the property has all necessary planning, building regulation or other consents and Savills have not tested any services, equipment or facilities. Prospective tenants must satisfy themselves by inspection or otherwise. Please note that the local area may be affected by aircraft noise, you should make your own enquiries regarding any noise within the area before you make any offer.

\*There are different rules and fees for different tenancy types. For details of our fees and charges please go to [Savills.co.uk/tenant-fees](https://www.savills.co.uk/tenant-fees). For more detailed information read our applicant guide at [savills.co.uk/applicant-guide](https://www.savills.co.uk/applicant-guide).  
Hard copy available on request. . 20201006KTMS

