



Beautiful three bedroom apartment situated in the heart of Victoria Park

Banbury House, London, E9

£1,950 pcm plus fees apply, Furnished
Available from 31.03.2021



- Situated in a characteristic mansion block
- Close to Victoria Park
- Spacious apartment
- Three good sized bedrooms
- Excellent local amenities

Local Information

The property is located on a peaceful residential street just off the main shopping street in the Village which boasts a Ginger Pig Butcher, Gail's Baker, Fishmonger, grocery stores and a selection of popular pubs and restaurants. The beautiful green spaces of Victoria Park is within close proximity with its boating pond, gardens and play areas. Bethnal Green Tube is located approx. one mile away and there are frequent buses to many parts of the City.

About this property

Second floor flat with a generous dual aspect reception room and an eat-in kitchen. The property further comprises three good-sized bedrooms, bathroom and separate WC.

Furnishing

Furnished

Local Authority

London Borough of Hackney
Council Tax Band = B

Energy Performance

EPC Rating = C

Viewing

All viewings will be accompanied and are strictly by prior arrangement through Savills Victoria Park Lettings Office.
Telephone: +44 (0) 20 3222 5555.





Banbury House, London, E9
Gross Internal Area 954 sq ft, 88.6 m²

Tom Moorby
Victoria Park Lettings
+44 (0) 20 3222 5555
tom.moorby@savills.com

Banbury House, E9
Approx. Gross Internal Area 954 Sq Ft - 88.63 Sq M

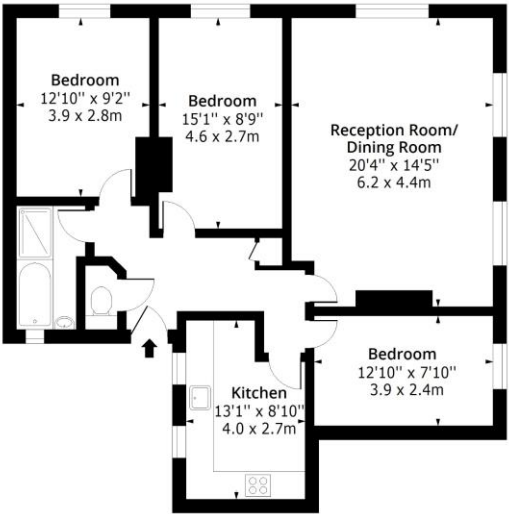

Second Floor
Floor Area 954 Sq Ft - 88.63 Sq M

Floor plan is for illustrative purposes only and is not to scale. Every attempt has been made to ensure the accuracy of the floor plan shown, however all measurements, fixtures, fittings and data shown are an approximate interpretation for illustrative purposes only.
lpaplus.com

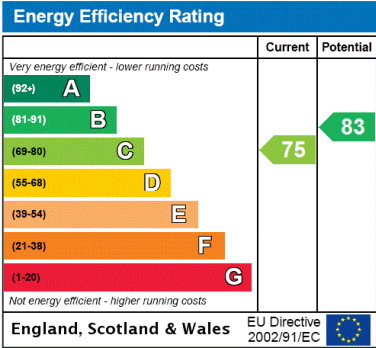

Important notice Savills, their clients and any joint agents give notice that: 1. They are not authorised to make or give any representations or warranties in relation to the property either here or elsewhere, either on their own behalf or on behalf of their client or otherwise. They assume no responsibility for any statement that may be made in these particulars. These particulars do not form part of any offer or contract and must not be relied upon as statements or representations of fact. 2. Any areas, measurements or distances are approximate. The text, images and plans are for guidance only and are not necessarily comprehensive. It should not be assumed that the property has all necessary planning, building regulation or other consents and Savills have not tested any services, equipment or facilities. Prospective tenants must satisfy themselves by inspection or otherwise. Please note that the local area may be affected by aircraft noise, you should make your own enquiries regarding any noise within the area before you make any offer.

*There are different rules and fees for different tenancy types. For details of our fees and charges please go to Savills.co.uk/tenant-fees. For more detailed information read our applicant guide at savills.co.uk/applicant-guide.
Hard copy available on request. . 20210323KAW

