



# Spacious two bedroom apartment in the Olympic Village

Lucia Heights, Logan Close, Olympic Park, London, E20

£559,950 Leasehold





Open plan living with stylish design  
Private west facing balcony  
Plenty of natural light and great views  
Close to Westfield and Stratford station  
Secure bike storage

#### **Local Information**

The area offers much in the way of amenities; world-class sports venues and Westfield shopping centre, has great local schools; the Chobham Academy and the Mossbourne Riverside Academy (both OFSTEAD "Outstanding") being close by, as are the open spaces of the Olympic Park itself. For local transport, Stratford is a veritable hub, offering Overground, Underground, DLR, National and International Rail.

#### **About this property**

Comprising of a luxurious open plan living area; high specification kitchen with integrated appliances, two carpeted double bedrooms and a family bathroom. Premium grade, luxury, vinyl tile flooring and underfloor heating can be found throughout.

#### **Tenure**

Leasehold

#### **Local Authority**

London Borough Of Newham

#### **Energy Performance**

EPC Rating = B

#### **Viewing**

All viewings will be accompanied and are strictly by prior arrangement through Savills Victoria Park Office.  
Telephone: +44 (0) 20 3222 5555.







Lucia Heights, Logan Close, Olympic Park, London, E20  
Gross Internal Area 758 sq ft, m<sup>2</sup>

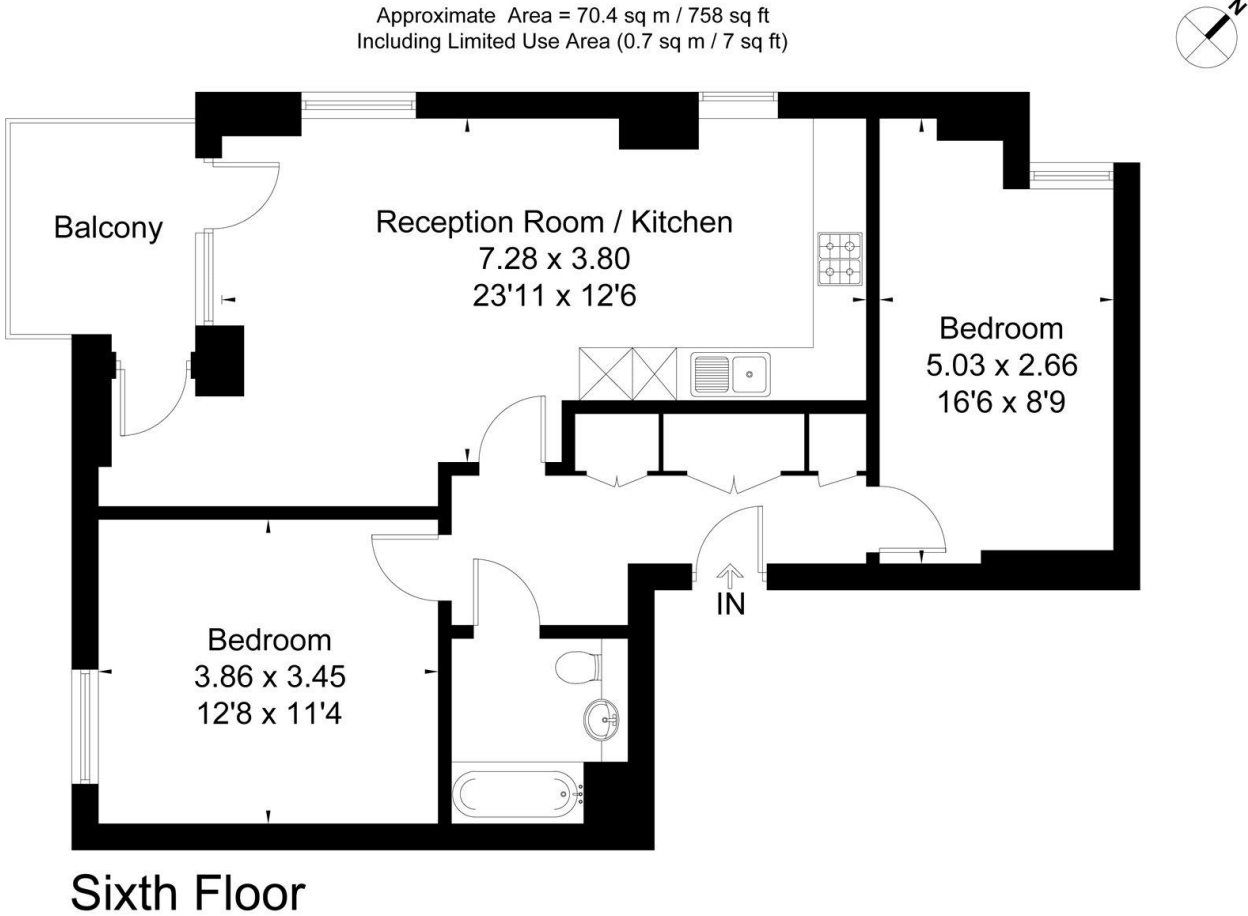

Surveyed and drawn in accordance with the International Property Measurement Standards (IPMS 2: Residential)  
fourwalls-group.com 232494

Energy Efficiency Rating		
	Current	Potential
Very energy efficient - lower running costs		
(92+) A		
(81-91) B	84	84
(69-80) C		
(55-68) D		
(39-54) E		
(21-38) F		
(1-20) G		
Not energy efficient - higher running costs		
England, Scotland & Wales	EU Directive 2002/91/EC	

**Important notice** Savills, its clients and any joint agents give notice that 1: They are not authorised to make or give any representations or warranties in relation to the property either here or elsewhere, either on their own behalf or on behalf of their client or otherwise. They assume no responsibility for any statement that may be made in these particulars. These particulars do not form part of any offer or contract and must not be relied upon as statements or representations of fact. 2: Any areas, measurements or distances are approximate. The text, photographs and plans are for guidance only and are not necessarily comprehensive. It should not be assumed that the property has all necessary planning, building regulation or other consents and Savills have not tested any services, equipment or facilities. Purchasers must satisfy themselves by inspection or otherwise. 20191015KAW

