



Bright and spacious modern apartment

Aumbrey Apartments, Eastway, London, E9

£625,000 Leasehold



Incredibly stylish modern apartment
Communal roof terrace
Generous square footage
Close to Hackney Wick Overground
Victoria Park and Olympic Park
Good local schooling

Local Information

The property has a good variety of day to day shops on the doorstep, with further amenities found at nearby Homerton and Victoria Park Village, which has a Ginger Pig Butcher, Gail's Bakery, fishmonger and grocers. There are some excellent brunch spots at Here East which is only a short walk away at the nearby Olympic Park. Transport links can be found at Hackney Wick Overground, with links to Highbury and Islington and Stratford International. The property also offers easy access to excellent green space, with Victoria Park and Hackney Marshes, both only a short walk away. There are also excellent local schools (subject to availability) including Mossbourne Riverside Academy.

About this property

This generously proportioned first floor flat forms part of an award winning development, which adjoins a historic 19th Century Anglican Church in Eastway, E9. Internally the property has been freshly decorated in tasteful neutral tones and features floor to ceiling windows, allowing for high volumes of natural light.

Accommodation: access via secure communal entrance, hallway, spacious reception/stylish modern kitchen which offers a wonderfully versatile living/dining space, good sized principal bedroom with en suite shower room, two further bedrooms with church views, and family bathroom with contemporary suite and feature tiling.

Tenure

Leasehold (142 years remaining)

Local Authority

London Borough of Hackney

Energy Performance

EPC Rating = B

Viewing

All viewings will be accompanied and are strictly by prior arrangement through Savills Victoria Park Office.
Telephone: +44 (0) 20 3222 5555.





Aumbrey Apartments, Eastway, London, E9
Gross Internal Area 864 sq ft, 80.3 m²

onTheMarket.com

 savills

savills.co.uk

David Easton
Victoria Park
+44 (0) 20 3222 5555
david.easton@savills.com

Approximate Area = 80.3 sq m / 864 sq ft
Including Limited Use Area (0.1 sq m / 1 sq ft)
For identification only. Not to scale.
© Fourwalls

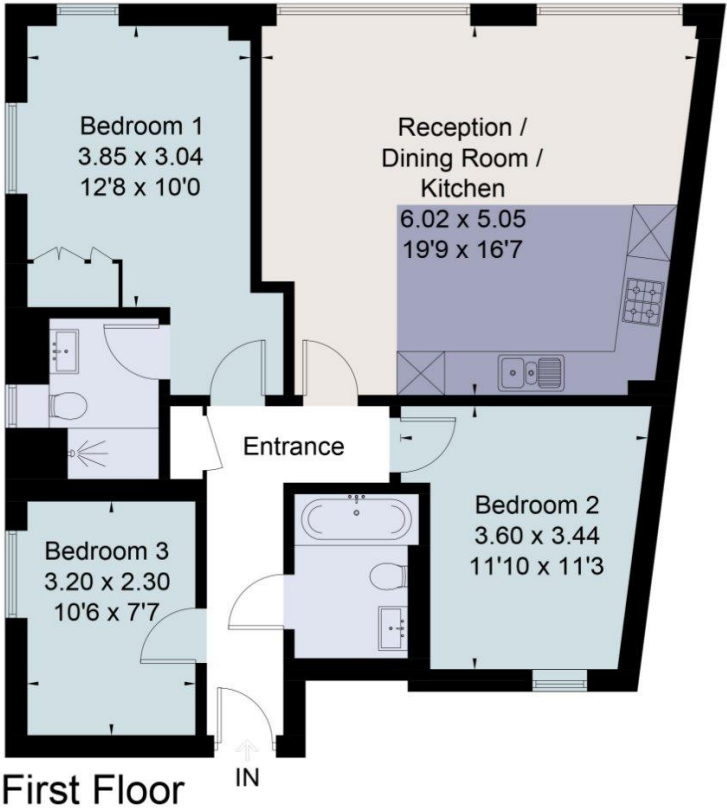

Surveyed and drawn in accordance with the International Property Measurement Standards (IPMS 2: Residential)
fourwalls-group.com 258881

Energy Efficiency Rating		
	Current	Potential
Very energy efficient - lower running costs		
(92+) A		
(81-91) B	82	82
(69-80) C		
(55-68) D		
(39-54) E		
(21-38) F		
(1-20) G		
Not energy efficient - higher running costs		
England, Scotland & Wales	EU Directive 2002/91/EC	

Important Notice Savills, its clients and any joint agents give notice that 1: They are not authorised to make or give any representations or warranties in relation to the property either here or elsewhere, either on their own behalf or on behalf of their client or otherwise. They assume no responsibility for any statement that may be made in these particulars. These particulars do not form part of any offer or contract and must not be relied upon as statements or representations of fact. 2: Any areas, measurements or distances are approximate. The text, photographs and plans are for guidance only and are not necessarily comprehensive. It should not be assumed that the property has all necessary planning, building regulation or other consents and Savills have not tested any services, equipment or facilities. Purchasers must satisfy themselves by inspection or otherwise. 20200907KAW

