



A well-presented two double bedroom maisonette with a private garden conveniently located between Old Street and Angel stations.

Micawber Court, Windsor Terrace, London, N1

£499,995 Leasehold (93 years remaining)



• **Two Bedrooms • One bathroom • Reception Room**

- Private rear garden • Close to Old Street • Maisonette
- Wood Flooring • Offered chain free

About this property

A split level maisonette with a private entrance that offers private front and walled rear gardens.

The property is entered via Windsor Terrace with an inviting hallway which leads through to the separate lounge and kitchen. Sliding doors connect the living area through to the private rear garden.

On the first floor there are two bedroom, one bathroom and ample storage space.

Local information

Located in Windsor Terrace, a minor turning positioned just off of City Road.

Approximately 630 yards from Old Street Station and 0.7 miles from Hoxton and Moorgate stations.

Within close distance to a huge selection of restaurants and nightlife in Angel, Shoreditch, Clerkenwell and Dalston.



Tenure

Leasehold (93 years remaining)

Local Authority

Hackney Council

Energy Performance

EPC Rating = C

Viewing

All viewings will be accompanied and are strictly by prior arrangement through Savills Shoreditch Office.
Telephone: +44 (0) 207 578 6200.





Micawber Court, Windsor Terrace, London, N1
Gross Internal Area 675 sq ft, 62.7 m²

Nick Verdi
Shoreditch
+44 (0) 207 578 6200
nick.verdi@savills.com

 onTheMarket.com |  savills | savills.co.uk

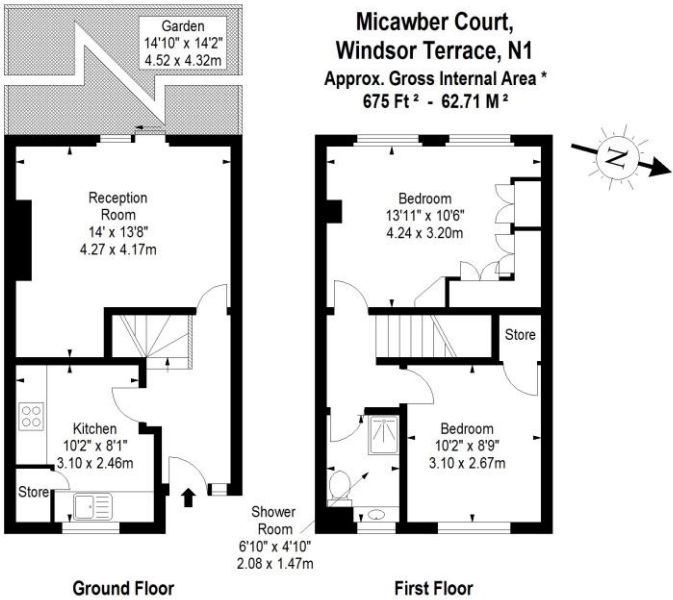

Every attempt has been made to ensure the accuracy of this floor plan however, measurements are approximate and for illustration purposes only. Measured in accordance with the RICS code of measuring practice. Not to scale
© Inside Photography Ltd.
Tel 07850 620 122, 0207 263 2188
www.ipinteriors.co.uk

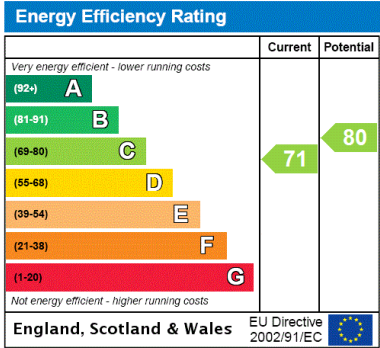

Important Notice Savills, its clients and any joint agents give notice that 1: They are not authorised to make or give any representations or warranties in relation to the property either here or elsewhere, either on their own behalf or on behalf of their client or otherwise. They assume no responsibility for any statement that may be made in these particulars. These particulars do not form part of any offer or contract and must not be relied upon as statements or representations of fact. 2: Any areas, measurements or distances are approximate. The text, photographs and plans are for guidance only and are not necessarily comprehensive. It should not be assumed that the property has all necessary planning, building regulation or other consents and Savills have not tested any services, equipment or facilities. Purchasers must satisfy themselves by inspection or otherwise. 20210720MEHT

