



A striking apartment with a breath-taking view of the City.

Avantgarde Tower, 1 Avantgarde Place, London, E1

£900,000 Leasehold (988 years remaining)



Two bedrooms • Two bathrooms • Reception Room

Eighteenth floor apartment • Stunning City views • Secure underground parking space • Two balconies • Concierge • Residents lounge and gym • Easy access to City and transport links

Local Information

The Avantgarde development is located in the heart of Shoreditch, seconds away from Shoreditch High Street, Redchurch Street and the Boxpark.

Shoreditch High Street Station is approximately 190 yards and Liverpool Street station is approximately 0.5 miles.

The local shopping, restaurants and nightlife are amongst the best you'll find anywhere in London. The close proximity to the City and the ease of transport links makes this building a popular choice for professionals working the financial district.

About this property

An incredible eighteenth floor two bedroom apartment with a spectacular view over the City skyline.

Internally the flat is approximately 800 square feet, arranged with two bedrooms, two bathrooms and a spacious lounge/kitchen. There is ample storage with fitted cupboards in both bedrooms and there are two balconies coming off the lounge and principal bedroom.

The reception wall features floor to ceiling glass framing a stunning picture of the City.

Avantgarde is a landmark development which was completed in 2014 and features an inviting communal lobby with concierge, residents gym and courtyard. The apartment is also being sold with the benefit of a parking space in the secure underground garage.

Tenure

Leasehold(988 years remaining)

Local Authority

Tower Hamlets

Energy Performance

EPC Rating = B

Viewing

All viewings will be accompanied and are strictly by prior arrangement through Savills Shoreditch Office.
Telephone: +44 (0) 207 578 6200.





Avantgarde Tower, 1 Avantgarde Place, London, E1
Gross Internal Area 753 sq ft, 70 m²

Nick Verdi
Shoreditch
+44 (0) 207 578 6200
nick.verdi@savills.com

onTheMarket.com | savills | savills.co.uk

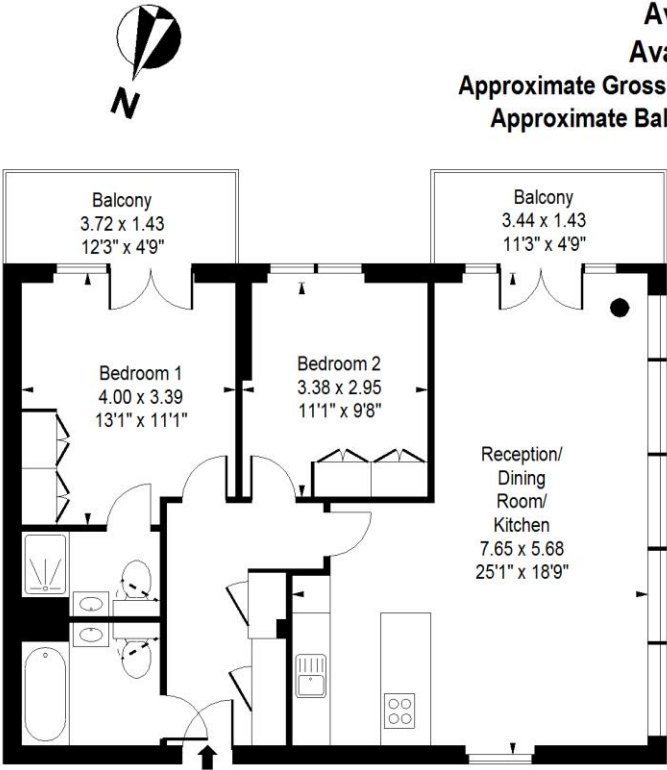

Eighteenth Floor

Avantgarde Tower,
Avantgarde Place, E1
Approximate Gross Internal Area = 800 sq ft / 74.32 sqm
Approximate Balcony Area = 114 sq ft / 10.59 sqm

Measured in accordance with RICS guidelines.
This floor plan is for illustrative purposes only
and must not be relied upon as a statement of fact.
© alihewitt.co.uk

Energy Efficiency Rating		
	Current	Potential
Very energy efficient - lower running costs		
(92+) A		
(81-91) B	88	89
(69-80) C		
(55-68) D		
(39-54) E		
(21-38) F		
(1-20) G		
Not energy efficient - higher running costs		
England, Scotland & Wales	EU Directive 2002/91/EC	

Important Notice Savills, its clients and any joint agents give notice that 1: They are not authorised to make or give any representations or warranties in relation to the property either here or elsewhere, either on their own behalf or on behalf of their client or otherwise. They assume no responsibility for any statement that may be made in these particulars. These particulars do not form part of any offer or contract and must not be relied upon as statements or representations of fact. 2: Any areas, measurements or distances are approximate. The text, photographs and plans are for guidance only and are not necessarily comprehensive. It should not be assumed that the property has all necessary planning, building regulation or other consents and Savills have not tested any services, equipment or facilities. Purchasers must satisfy themselves by inspection or otherwise. 20210416HHBE

