



A lovely 2 bedroom ground floor apartment with garden

Flat A, 19 Upway Road, Headington, Oxford, OX3 9QH

Guide Price £300,000 Leasehold (Expiry date of the Lease - 31st January 3014)



Two bedrooms • Sitting room • Kitchen / dining room • Shower room • Guest WC • Furnished • Garden • Off street parking • EPC rating – C • Expiry date of the Lease - 31st January 3014

Flat A, 19 Upway Road, Headington, Oxford, OX3 9QH
Approximate Area 48.0 sq m / 517 sq ft
Including Limited Use Area (0.4 sq m / 4 sq ft)



savills

savills.co.uk

Zoe White

Savills Summertown, Oxford

01865 339 707

summertown@savills.com

Local Information

The center of Oxford is only a couple of miles away and there is easy access to a wide range of local amenities, shops, leisure facilities and cultural attractions. Headington has good access to London with regular services via The Oxford Tube. The property is also conveniently located near to the John Radcliffe.

About this property

A lovely two bedroom ground floor apartment with garden and parking. The main door brings you into a small porch area with the large storage cupboard to the right and the guest cloakroom to the left. The bright kitchen over looks the garden and has room for a dining table and chairs. The sitting room is the center of the apartment with a door out to the garden and to the back hallway from which leads the main double bedroom, second single bedroom and shower room.

Local Authority: Oxford City Council . Council Tax – Band C

Tenure: Expiry date of the Lease - 31st January 3014
 Brochure prepared an photographs taken in April 2022

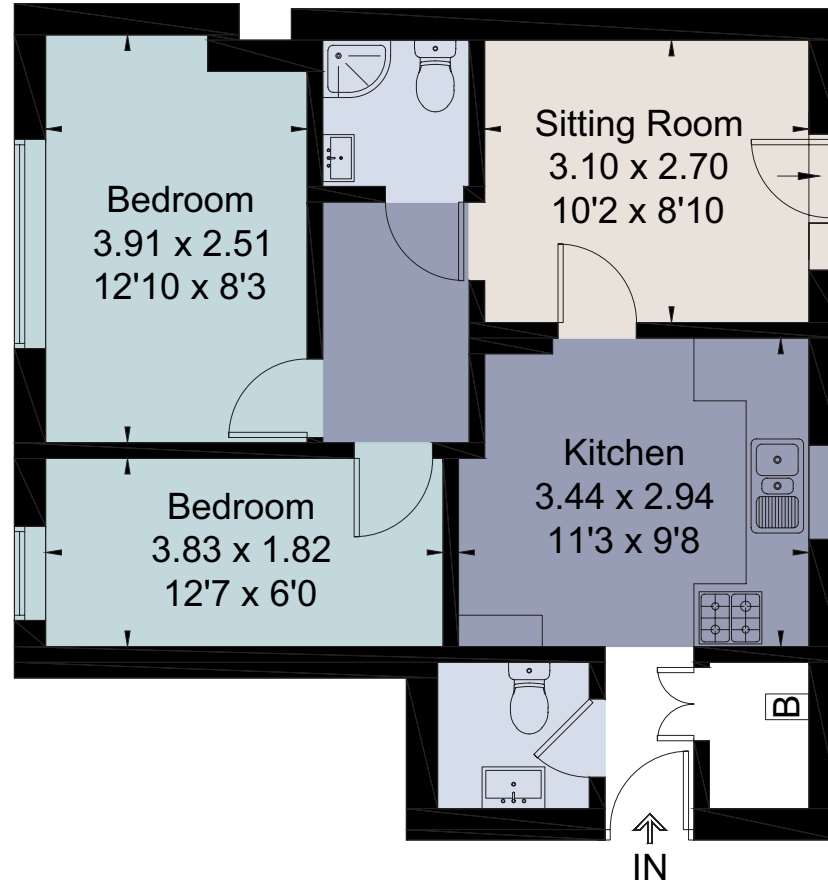

For identification only. Not to scale. © 220516ZW

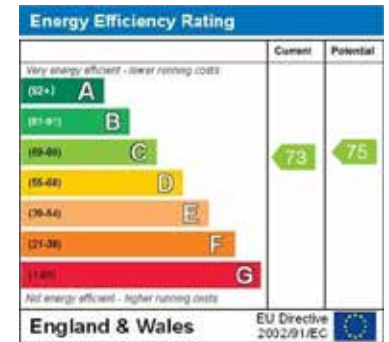

Important notice Savills, its clients and any joint agents give notice that 1: They are not authorised to make or give any representations or warranties in relation to the property either here or elsewhere, either on their own behalf or on behalf of their client or otherwise. They assume no responsibility for any statement that may be made in these particulars. These particulars do not form part of any offer or contract and must not be relied upon as statements or representations of fact. 2: Any areas, measurements or distances are approximate. The text, photographs and plans are for guidance only and are not necessarily comprehensive. It should not be assumed that the property has all necessary planning, building regulation or other consents and Savills have not tested any services, equipment or facilities. Purchasers must satisfy themselves by inspection or otherwise. Brochure by fourwalls-group.com.

