



# Stylish central Oxford living

**Apartment 2, Mill Stream House, Norfolk Street, Oxford OX1 1EB**

Leasehold - 125 year lease granted 2017.



Entrance hall • open plan living room/kitchen • bathroom • balcony

**Local information**

Mill Stream House occupies an independent position within the Westgate development. Ideal for those who work or study in central Oxford, walking or cycling around the city is easy, with colleges and key landmarks within easy reach.

**About this property**

Mill Stream House is a collection of one and two bedroom apartments. No 2 lies on the ground floor sharing a private entrance with one other apartment. The centrepiece is the large open plan living room with kitchen and dining area, and a private balcony overlooking Mill Stream. The bedroom has a built in wardrobe and doors to the balcony. **Services:** Water, electricity, mains drainage. Centralised hot water heating system. Photographs taken 2019, brochure prepared 2021.

**Tenure**

Leasehold - 125 year lease granted 2017.

**Local Authority**

Oxford City Council

**Viewing**

Strictly by appointment with Savills

**Apartment 2, Mill Stream House, Norfolk Street, Oxford  
OX1 1EB**



savills.co.uk

Savills Summertown, Oxford  
**01865 339700**  
summertown@savills.com

Approximate Area = 52.6 sq m / 566 sq ft  
For identification only. Not to scale.  
© Fourwalls Group

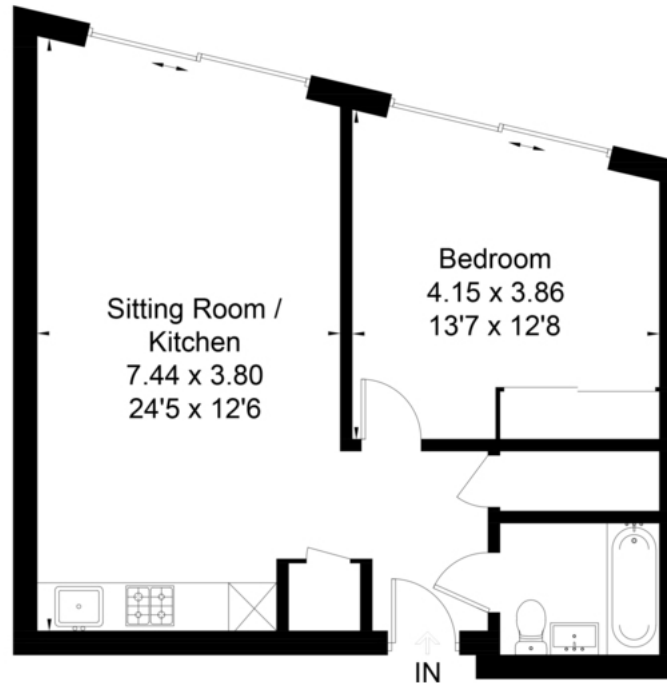

Surveyed and drawn in accordance with the International Property Measurement Standards (IPMS 2: Residential)  
fourwalls-group.com 233062

Energy Efficiency Rating		
	Current	Potential
Very energy efficient - lower running costs		
(92-100) <b>A</b>		
(81-91) <b>B</b>	83	83
(69-80) <b>C</b>		
(55-68) <b>D</b>		
(39-54) <b>E</b>		
(21-38) <b>F</b>		
(1-20) <b>G</b>		
Not energy efficient - higher running costs		
<b>England, Scotland &amp; Wales</b>	EU Directive 2002/91/EC	

**Important notice:** Savills, their clients and any joint agents give notice that 1: They are not authorised to make or give any representations or warranties in relation to the property either here or elsewhere, either on their own behalf or on behalf of their client or otherwise. They assume no responsibility for any statement that may be made in these particulars. These particulars do not form part of any offer or contract and must not be relied upon as statements or representations of fact. 2: Any areas, measurements or distances are approximate. The text, photographs and plans are for guidance only and are not necessarily comprehensive. It should not be assumed that the property has all necessary planning, building regulation or other consents and Savills have not tested any services, equipment or facilities. Purchasers must satisfy themselves by inspection or otherwise. 12021072 Job ID: 148522 User Initials: RVDP

