



An excellent opportunity to acquire this well located plot

London Road, Sevenoaks, Kent, TN13

Guide price £750,000 - Freehold



- Well located plot
- Planning for an impressive family home
- Planning number 18/03462/FUL
- Station approx. 0.4 of a mile
- Primary schools approx 0.6 of a mile via footpath

Local Information

Sevenoaks provides both a mainline station and town center, with its multitude of shops, supermarkets, pubs and restaurants. There are many popular schools in the area including Riverhead Infants and Amherst Juniors.

- Mainline Rail Services: Sevenoaks (0.4 miles) to London Bridge/Charing Cross/Cannon Street.
- Primary Schools: Riverhead Infants and Amherst Juniors (0.5 miles via public footpath), St Thomas' RCP, St John's CEP, Sevenoaks, and Lady Boswell's CEP Schools.

- Secondary Schools: Knole Academy, Weald of Kent Grammar and Trinity Secondary Schools in Sevenoaks. Several in Tonbridge and Tunbridge Wells.

- Private Schools: Sevenoaks, Tonbridge and Walthamstow Hall Secondary Schools. The Granville, Sevenoaks, Walthamstow Hall, Solefields and New Beacon Prep Schools. St Michael's and Russell House Prep Schools in Otford. Radnor House School in Sundridge

- Leisure Facilities: Holmesdale Cricket Club and Holmesdale Bowls Club. Sailing and water sports on Chipstead Lake, tennis at the village club. Wildernesse and Knole Golf Clubs in Sevenoaks and Nizels Golf and Leisure Centre in Hildenborough. Sevenoaks Leisure Centre.

Cricket, Hockey, Football and Rugby in the Sevenoaks Vine area.

All distances are approximate.

About this property

The site on London Road provides the incoming purchaser the opportunity to build their own impressive family home. The location is ideal for local primary schools and mainline station. The planning permission allows accommodation amounting to about 3,327 sq ft arranged over three floor, plus an integral garage and set within a plot in total of about 0.13 of an acre.

18/03462/FUL | Construction of detached three bedroom dwelling incorporating garage, access and off street parking. | Land Rear Of 2 Uplands Close Riverhead KENT TN13 3BP

Tenure

Freehold

Local Authority

Sevenoaks District Council

Viewing

All viewings will be accompanied and are strictly by prior arrangement through Savills Sevenoaks Office.
Telephone: +44 (0) 1732 789 700.

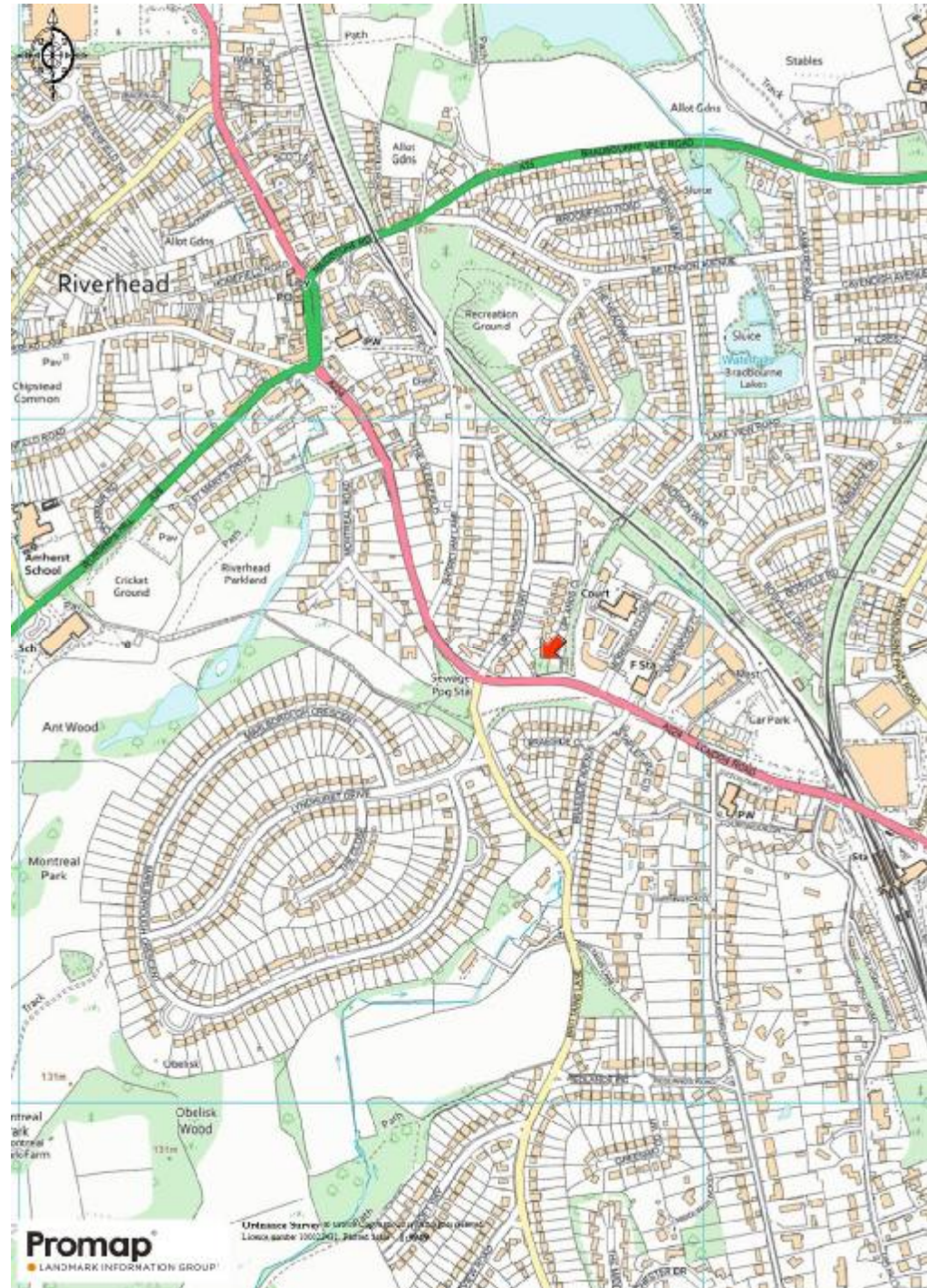

London Road, Sevenoaks, Kent, TN13
Gross Internal Area 3327 sq ft, 309.1 m²

Oliver Hodges
Sevenoaks
+44 (0) 1732 789 700
ohodges@savills.com



savills

savills.co.uk

Site on London Road

Gross internal area (approx.)

House - 309.1 sq m (3327 sq ft)

Garage - 20.7 sq m (222 sq ft)

For identification only - Not to scale

© Trueplan (UK) Limited



Second floor

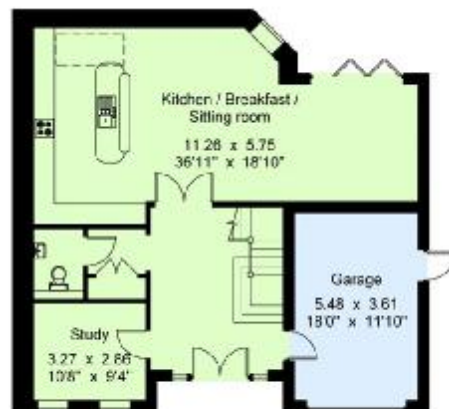

Ground floor



First floor



Important notice Savills, its clients and any joint agents give notice that 1: They are not authorised to make or give any representations or warranties in relation to the property either here or elsewhere, either on their own behalf or on behalf of their client or otherwise. They assume no responsibility for any statement that may be made in these particulars. These particulars do not form part of any offer or contract and must not be relied upon as statements or representations of fact. 2: Any areas, measurements or distances are approximate. The text, photographs and plans are for guidance only and are not necessarily comprehensive. It should not be assumed that the property has all necessary planning, building regulation or other consents and Savills have not tested any services, equipment or facilities. Purchasers must satisfy themselves by inspection or otherwise. 20190917ALBU

