



FLAT 1, WYNDHAM HOUSE, SLOANE SQUARE, LONDON, SW1W 8AR

Unfurnished,

Available Now

£1,995 per week + £276 inc VAT one off admin and other charges may apply.*

Double Reception room • Two double bedrooms • Two en-suites • Study/single bedroom • Eat In Kitchen • Separate eat in kitchen • Porter
• EPC Rating = D

Savills Sloane Street
Stevie Walmesley
swalmesley@savills.com
+44 (0) 207 824 9046

savills.co.uk

Description

A stunning first floor portered apartment situated in a prime Chelsea Location on Sloane Square. This beautiful apartment benefits from a large double reception room with period features, eat In kitchen, two large double bedrooms with ample storage and a further small single/study room.

Local Authority

London Borough Of Kensington and Chelsea, London



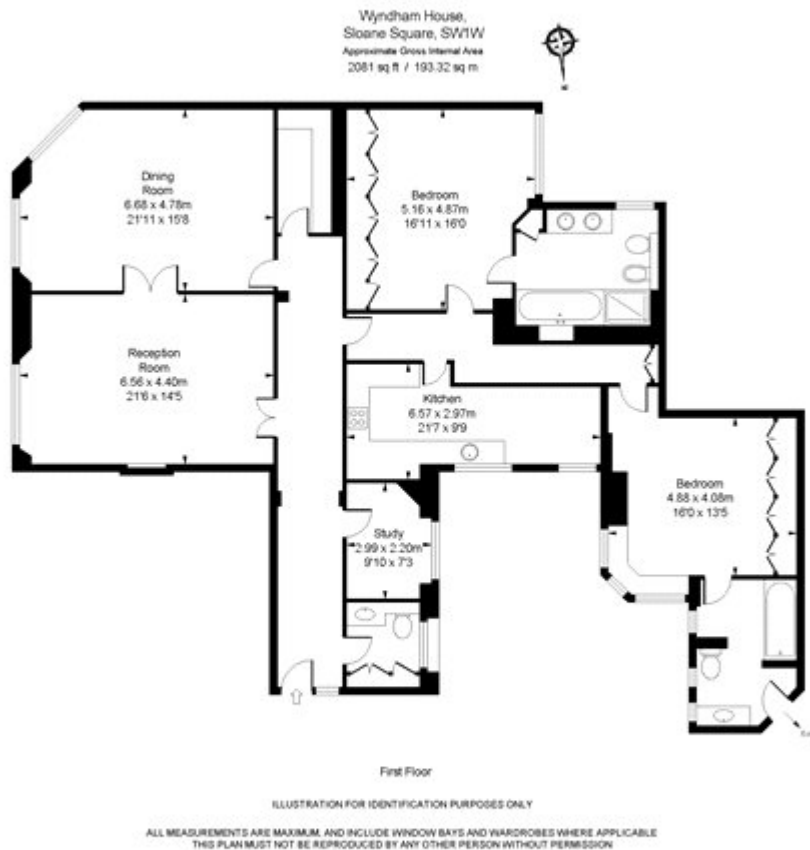

Energy Efficiency Rating

	Current	Potential
Very energy efficient - lower running costs		
(92+) A		
(81-91) B		
(69-80) C		76
(55-68) D	61	
(39-54) E		
(21-38) F		
(1-20) G		
Not energy efficient - higher running costs		
England, Scotland & Wales		EU Directive 2002/91/EC 

*Admin fees including drawing up the tenancy agreement, reference charge for one tenant – £276 inc VAT. £36 inc VAT for each additional tenant, occupant, guarantor reference where required. Inventory check-out fee – charged at end of tenancy. Third party charge dependant on property size and whether furnished/unfurnished/part furnished and the company available at the time. Deposit – usually equivalent to 6 weeks rent, though may be greater subject to mutual agreement. Pets – additional deposit required generally equivalent to two weeks rent. For more details, visit savills.co.uk/fees.

Important notice: Savills, their clients and any joint agents give notice that: 1: They are not authorised to make or give any representations or warranties in relation to the property either here or elsewhere, either on their own behalf or on behalf of their client or otherwise. They assume no responsibility for any statement that may be made in these particulars. These particulars do not form part of any offer or contract and must not be relied upon as statements or representations of fact. 2: Any areas, measurements or distances are approximate. The text, photographs and plans are for guidance only and are not necessarily comprehensive. It should not be assumed that the property has all necessary planning, building regulation or other consents and Savills have not tested any services, equipment or facilities. Tenants must satisfy themselves by inspection or otherwise.