



A beautifully presented apartment in a purpose built block

Blazer Court, 28A St. Johns Wood Road, London, NW8

£795,000 Leasehold (94 years and 4 months remaining)

savills

- Secure underground parking
 - Portered block
 - Passenger lift
- Two double bedrooms
- Wooden flooring throughout

About this property

This spacious two bedroom apartment is situated on the third floor of an excellent purpose built block which is located directly across from Lord's Cricket Ground. Accommodation comprises a spacious open plan kitchen / reception room, a principal bedroom with en-suite bathroom, a second bedroom and a shower room. Further benefits include wooden flooring throughout, portorage, a passenger lift and secure underground parking.

Local Information

Blazer Court is located on St. Johns Wood Road, directly across from Lord's Cricket Ground. The property is within a short walk of the various boutiques and eateries of St. Johns Wood High Street (0.5miles), the green open spaces of Regents Park (0.4 miles) and St Johns Wood Underground Station (0.6miles).

Tenure

Leasehold

Local Authority

City of Westminster

Energy Performance

EPC Rating = To be confirmed

Viewing

All viewings will be accompanied and are strictly by prior arrangement through Savills St. John's Wood & Regents Park Office.

Telephone: +44 (0) 20 3043 3600.







Blazer Court, 28A St. Johns Wood Road, London, NW8
Gross Internal Area 868 sq ft, 80.6 m²

Alicia Lindsay
St. John's Wood & Regents Park
+44 (0) 20 3043 3600
alindsay@savills.com

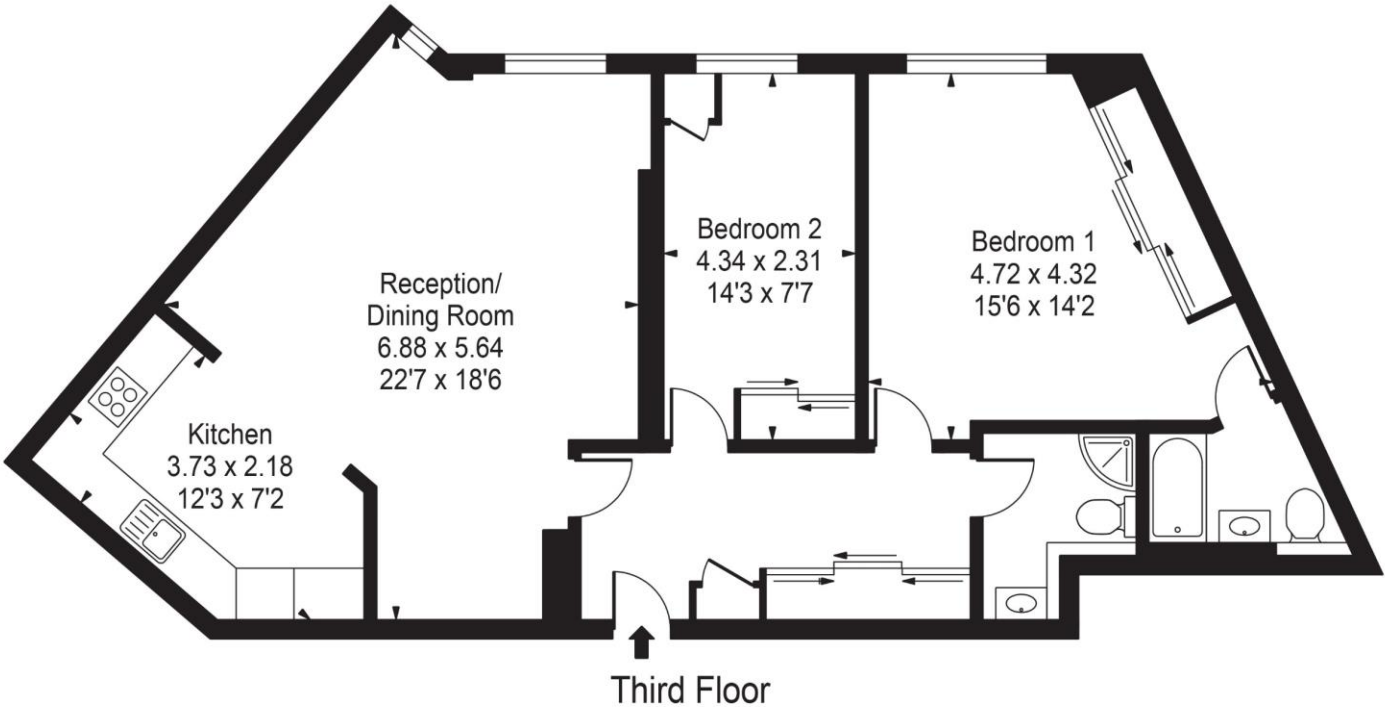
Blazer Court
Gross Internal Area(Approx)
Total = 80.64 Sq m / 868 Sq ft
For Illustration Purposes Only - Not To Scale



Energy Efficiency Rating		
	Current	Potential
Very energy efficient - lower running costs		
(92+) A		
(81-91) B		
(69-80) C	79	83
(55-68) D		
(39-54) E		
(21-38) F		
(1-20) G		
Not energy efficient - higher running costs		
England, Scotland & Wales	EU Directive 2002/91/EC 	

Important Notice Savills, its clients and any joint agents give notice that 1: They are not authorised to make or give any representations or warranties in relation to the property either here or elsewhere, either on their own behalf or on behalf of their client or otherwise. They assume no responsibility for any statement that may be made in these particulars. These particulars do not form part of any offer or contract and must not be relied upon as statements or representations of fact. 2: Any areas, measurements or distances are approximate. The text, photographs and plans are for guidance only and are not necessarily comprehensive. It should not be assumed that the property has all necessary planning, building regulation or other consents and Savills have not tested any services, equipment or facilities. Purchasers must satisfy themselves by inspection or otherwise. 20200828ALLI

