



A charming split level two double bedroom apartment

Southfields Road, Putney, London, SW18 1QJ

Guide Price £595,000 Leasehold





Attractive location • Beautifully presented • Light and airy feel •
Lovely period features • Delightful and charming period home •
Hallway • Reception room • Kitchen • Two double bedrooms •
Bathroom • Cloakroom

Local Information

The property is situated in a quiet, leafy street of attractive terraced period properties south east of central Putney, with the nearest underground being East Putney and Southfields (District). Putney Station (Waterloo) is on Putney High Street and three bus routes (170, 37 & 337) at the end of the road, are a short journey to Clapham Junction.

About this property

A beautifully presented two double bedroom maisonette apartment situated on the upper floors of a handsome terraced period property.

This delightful home offers flexible and spacious (nearly 1000 sq ft) accommodation and has a light and airy feel, particularly from large bay windows to the front and side of the property. There are also attractive period features such as fire places and high ceilings which all add to the charm of this lovely property.

Tenure

Leasehold

Local Authority

Wandsworth

Energy Performance

EPC Rating = E

Viewing

All viewings will be accompanied and are strictly by prior arrangement through Savills Putney Office.

Telephone:

+44 (0) 20 8780 9900.

Or Hoffen West

+44 (0) 20 3858 0483



Southfields Road, Putney, London, SW18 1QJ
Gross Internal Area 981 sq ft, 91.1 m²

onTheMarket.com |  savills | savills.co.uk

Archie Lloyd
Putney
+44 (0) 20 8780 9900
archie.lloyd@savills.com

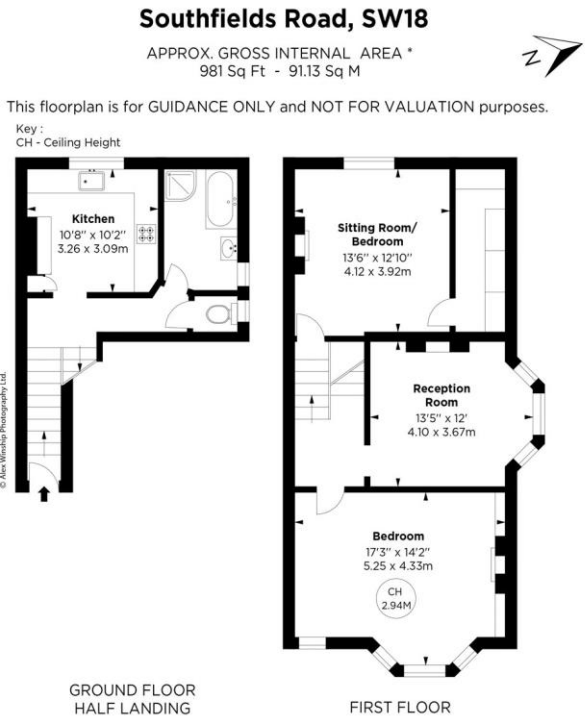

Rupert Hoffen
Tel: 020 3858 0483
www.hoffenwest.com

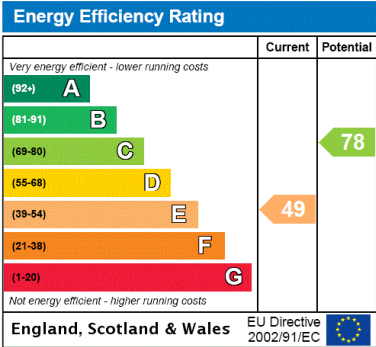

Important Notice Savills, its clients and any joint agents give notice that 1: They are not authorised to make or give any representations or warranties in relation to the property either here or elsewhere, either on their own behalf or on behalf of their client or otherwise. They assume no responsibility for any statement that may be made in these particulars. These particulars do not form part of any offer or contract and must not be relied upon as statements or representations of fact. 2: Any areas, measurements or distances are approximate. The text, photographs and plans are for guidance only and are not necessarily comprehensive. It should not be assumed that the property has all necessary planning, building regulation or other consents and Savills have not tested any services, equipment or facilities. Purchasers must satisfy themselves by inspection or otherwise. 20200915NLSM

