



A charming mews house set behind electric gates in the heart of Primrose Hill village

Eglon Mews, Primrose Hill, London, NW1

Guide Price £1,495,000 Freehold

savills

• **Private cobbled mews** • **Set behind secure electric gates** • **Bright and airy** • **In the heart of Primrose Hill village** • **Freehold**

About this property

A superb and discreet mews house located in a private charming cobbled courtyard behind electric gates in the heart of Primrose Hill. The property is set over three floors and comprises a kitchen, bedroom and bathroom on the ground floor, a bright open plan reception room with dining area on the first floor and a further two bedrooms and a bathroom on the floor above. Further benefits include off street parking.

Local Information

Located in a peaceful and discreet turning off Berkley Road this house runs parallel to Regents Park Road and is ideally located in the village itself with all the shops cafes and restaurants practically on your doorstep. The green open spaces of Primrose Hill and Regent's Park is approximately 0.1 miles away. Chalk Farm Underground (Northern Line) is approximately 0.3 miles away which also offers multiple bus routes into and out of London.

Tenure

Freehold

Local Authority

Camden Council

Energy Performance

EPC Rating = D

Viewing

All viewings will be accompanied and are strictly by prior arrangement through Savills Primrose Hill Office. Telephone: +44 (0) 20 3428 2900.





Eglon Mews

Gross Internal Area(Approx)

Total = 92.16 Sq m / 992 Sq ft (Excluding Void)

For Illustration Purposes Only - Not To Scale

Floorplan by Humble Spy Photography Ltd.

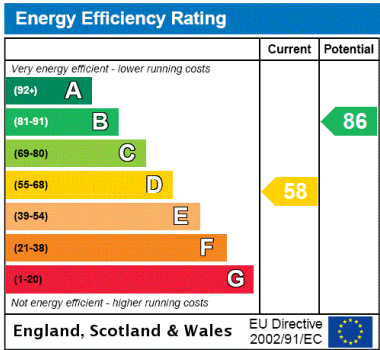
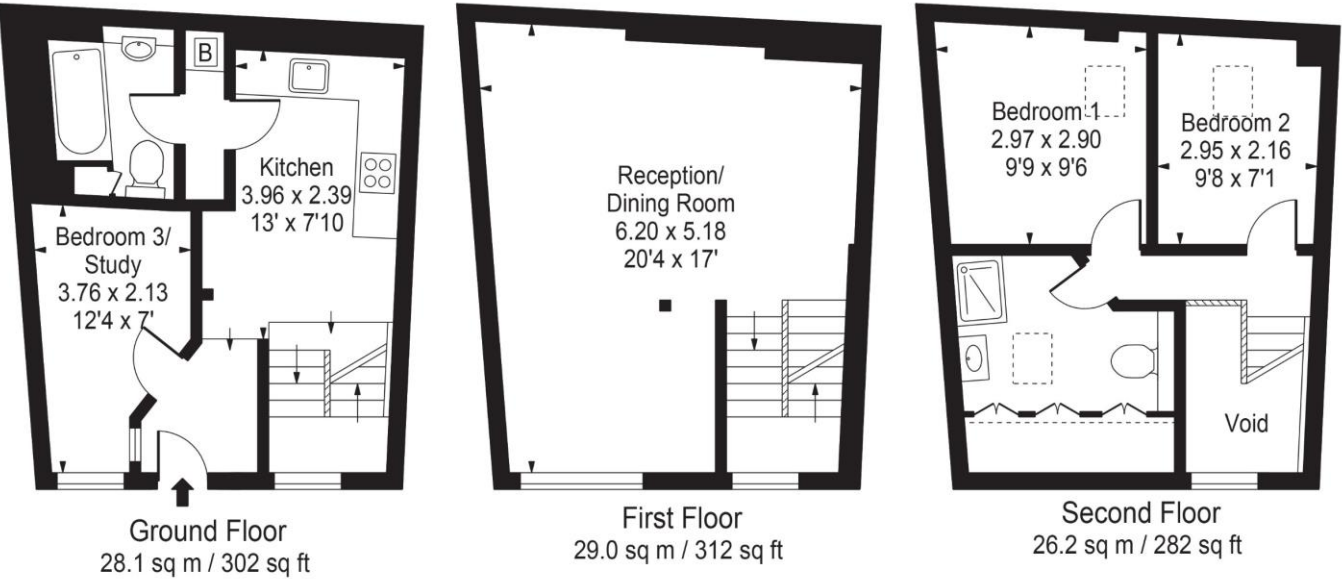

Important Notice Savills, its clients and any joint agents give notice that 1: They are not authorised to make or give any representations or warranties in relation to the property either here or elsewhere, either on their own behalf or on behalf of their client or otherwise. They assume no responsibility for any statement that may be made in these particulars. These particulars do not form part of any offer or contract and must not be relied upon as statements or representations of fact. 2: Any areas, measurements or distances are approximate. The text, photographs and plans are for guidance only and are not necessarily comprehensive. It should not be assumed that the property has all necessary planning, building regulation or other consents and Savills have not tested any services, equipment or facilities. Purchasers must satisfy themselves by inspection or otherwise. 20210325EYFN

