



A beautifully presented one bedroom apartment, situated in an attractive stucco fronted period conversion.

Gloucester Terrace, London, W2

£595,000 Leasehold



High ceilings • Flooded with natural light • Well-proportioned
• Glorious period conversion • Close to Hyde Park

About this property

Located within an attractive white stucco fronted period conversion on Gloucester Terrace is this one bedroom apartment. This flat is beautifully presented and benefits from high ceilings throughout.

The accommodation comprises a well-proportioned reception/dining room sitting at the front of the property. The room also provides a south easterly aspect and the large sash windows allow for plenty of light. There is a separate well-equipped kitchen found to the rear of the apartment.

Completing the accommodation is a double bedroom, with in-built storage and a stylish large bathroom.

Local Information

Gloucester Terrace is within close proximity of both Hyde Park and the amenities of Queensway, including restaurants, cafes and shops. Local transport links include Paddington mainline (Network Rail and Heathrow Express) and underground (Bakerloo, District, Circle and Hammersmith and City lines) station and Royal Oak underground (Circle and Hammersmith and City lines) station.

Tenure

Leasehold

Local Authority

City Of Westminster

Energy Performance

EPC Rating = C

Viewing

All viewings will be accompanied and are strictly by prior arrangement through Savills Notting Hill Office.

Telephone: +44 (0) 207 727 5750.





Gloucester Terrace, London, W2
Gross Internal Area 550 sq ft, 51.1 m²

Daniel Martin
Notting Hill
+44 (0) 207 727 5750
daniel.martin@savills.com

234D Gloucester Terrace, W2

Gross internal area (approx) 51.10 sq m / 550 sq ft

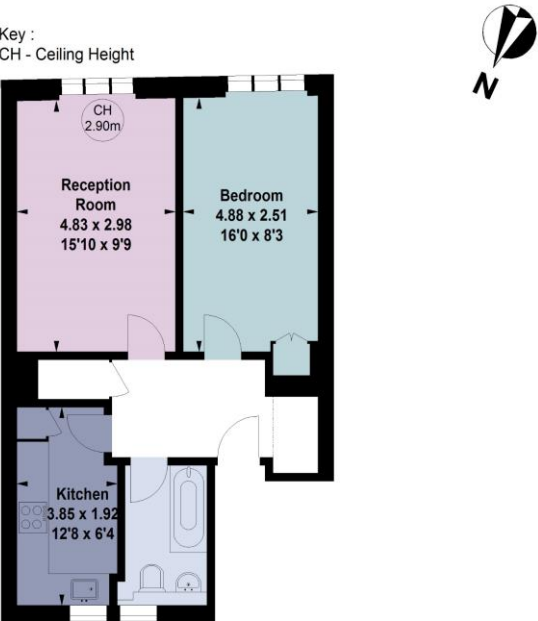

Second Floor

For Identification Only. Not To Scale.
© Click London Limited

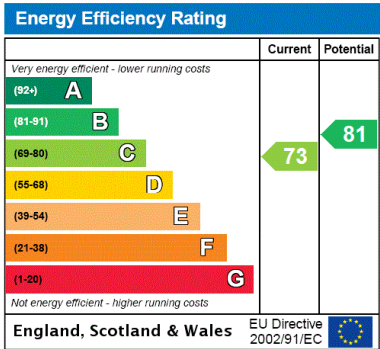

Important Notice Savills, its clients and any joint agents give notice that 1: They are not authorised to make or give any representations or warranties in relation to the property either here or elsewhere, either on their own behalf or on behalf of their client or otherwise. They assume no responsibility for any statement that may be made in these particulars. These particulars do not form part of any offer or contract and must not be relied upon as statements or representations of fact. 2: Any areas, measurements or distances are approximate. The text, photographs and plans are for guidance only and are not necessarily comprehensive. It should not be assumed that the property has all necessary planning, building regulation or other consents and Savills have not tested any services, equipment or facilities. Purchasers must satisfy themselves by inspection or otherwise. 20200916ELAL

