



A wonderful two bedroom flat with a private terrace

Northcote Road, London, SW11

£650,000



Reception room • Open-plan kitchen • Two double bedrooms • One bathroom • Private terrace • Fantastic local amenities nearby • Close to superb transport links

Local Information

Northcote Road runs from Battersea Rise to Broomwood Road and lies between the Commons. Wandsworth common is approximately 0.6 miles away and offers a vast amount of green open space to enjoy.

There are many popular local shops, restaurants, cafes and bars on Northcote Road with High Street shopping close to hand in St. John's Hill and Lavender Hill.

The property is within walking distance of Clapham Junction mainline station which offers over ground services in Victoria and Waterloo. There are also many schools of good repute locally both in the state and private sector.

About this property

Located on Northcote Road is this charming two bedroom, first floor flat.

As you enter the property, the light and airy reception room is located, benefitting from a comfortable seating area, breakfast table and a large window allowing an abundance of light to fill the room.

The open-plan kitchen features an array of integrated appliances, plenty of built in storage and a French door allowing direct access to the private terrace.

To the rear of the property the primary double bedroom is situated and the family bathroom is adjacent to this, completing the property.

Tenure

Leasehold

Local Authority

Wandsworth

Energy Performance

EPC Rating = D

Viewing

All viewings will be accompanied and are strictly by prior arrangement through Savills Northcote Road Office. Telephone: +44 (0) 20 3428 2222.





Northcote Road, London, SW11
Gross Internal Area 605 sq ft, 56.2 m²

Adam Camplin
Northcote Road
+44 (0) 20 3428 2222
adam.camplin@savills.com

 |  savills | savills.co.uk

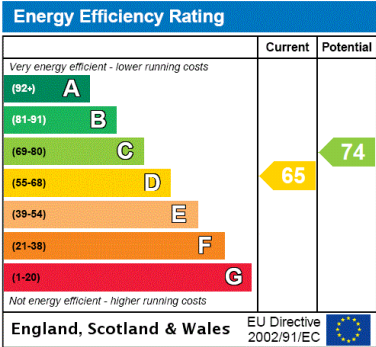
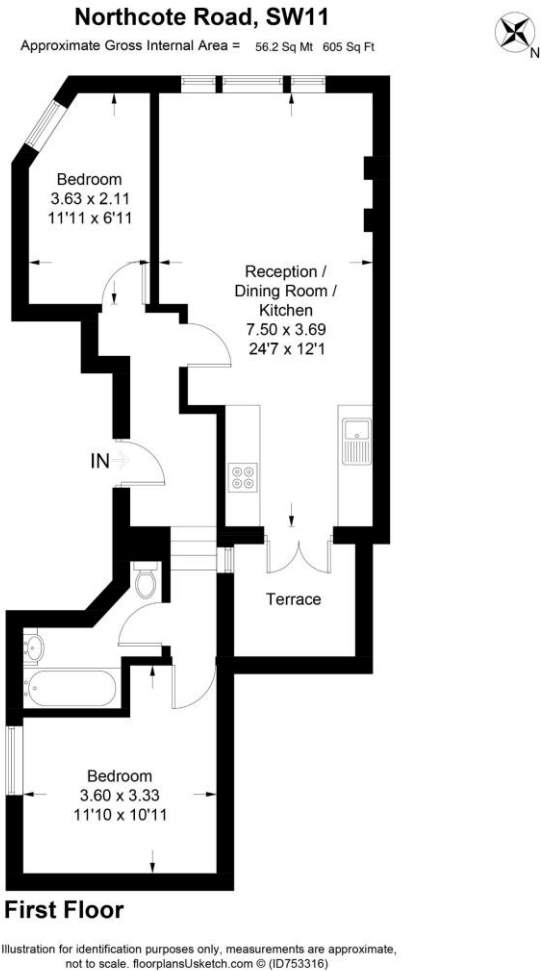

Important Notice Savills, its clients and any joint agents give notice that 1: They are not authorised to make or give any representations or warranties in relation to the property either here or elsewhere, either on their own behalf or on behalf of their client or otherwise. They assume no responsibility for any statement that may be made in these particulars. These particulars do not form part of any offer or contract and must not be relied upon as statements or representations of fact. 2: Any areas, measurements or distances are approximate. The text, photographs and plans are for guidance only and are not necessarily comprehensive. It should not be assumed that the property has all necessary planning, building regulation or other consents and Savills have not tested any services, equipment or facilities. Purchasers must satisfy themselves by inspection or otherwise. 20210421OLCG

