



A three bedroom detached house with double garage

Ellington Road, Taplow, Maidenhead, Berkshire, SL6

£1,695 pcm plus fees apply, Unfurnished
Available from 13.12.2019



Detached house • Three bedrooms • One reception room • One bathroom • Garden • Double garage • Unfurnished

Local Information

This property is located on the highly regarded Ellington Road, close to lovely river walks. Nearby Maidenhead town centre offers a comprehensive range of shopping/leisure facilities whilst further extensive amenities may be found in the riverside towns of Windsor, Marlow and Henley-on-Thames.

Rail services to London (Paddington) are available from Maidenhead and Taplow and Crossrail, the new high-speed service is scheduled to begin running from Maidenhead in 2020. Road connections are equally as good with the M4 (Junctions 7 and 8/9) offering links with Heathrow, Central London, West Country and the M25.

Nearby amenities include the Cliveden National Trust estate, redeveloped Bishop Centre and the River Thames. Sporting facilities are varied with golf at Temple, Stoke Park, Lambourne, Harleyford, Beaconsfield and Winter Hill, Rowing at Maidenhead rowing club, Numerous equestrian centres and racing at Windsor, Ascot and Newbury. There is also boating on some stretches of the River Thames.

About this property

A three bedroom, detached house, tucked away in small cul-de-sac which has just been redecorated and fitted with new carpets upstairs.

Accommodation comprises: entrance hall, cloakroom, modern kitchen, L-shaped living/dining room, two double bedrooms (both with fitted wardrobes), single bedroom and bathroom.

The property also benefits from garden, double garage and driveway parking.

Furnishing
Unfurnished

Local Authority
South Buckinghamshire Council, Uxbridge

Energy Performance
EPC Rating = D

Viewing
All viewings will be accompanied and are strictly by prior arrangement through Savills Marlow Lettings Office.
Telephone: +44 (0) 1628 481 381.





Ellington Road, Taplow, Maidenhead, Berkshire, SL6
Gross Internal Area 1543 sq ft, m²

Sophie Collett
Marlow Lettings
+44 (0) 1628 481 381
sophie.collett@savills.com

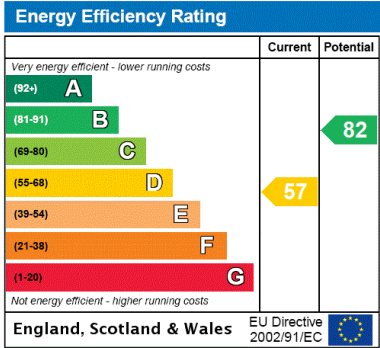
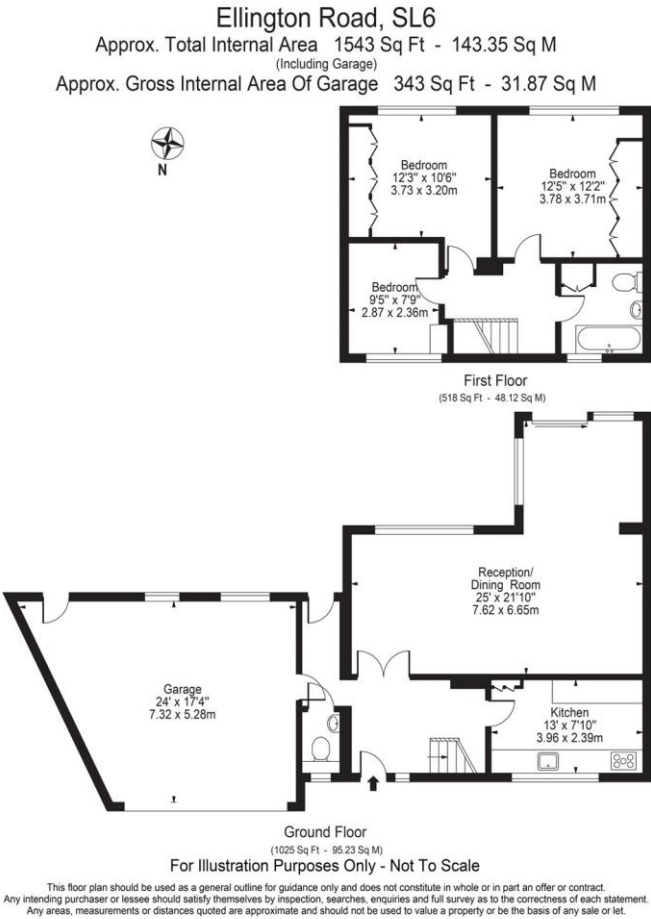

Important notice Savills, their clients and any joint agents give notice that: 1. They are not authorised to make or give any representations or warranties in relation to the property either here or elsewhere, either on their own behalf or on behalf of their client or otherwise. They assume no responsibility for any statement that may be made in these particulars. These particulars do not form part of any offer or contract and must not be relied upon as statements or representations of fact. 2. Any areas, measurements or distances are approximate. The text, images and plans are for guidance only and are not necessarily comprehensive. It should not be assumed that the property has all necessary planning, building regulation or other consents and Savills have not tested any services, equipment or facilities. Prospective tenants must satisfy themselves by inspection or otherwise. Please note that the local area may be affected by aircraft noise, you should make your own enquiries regarding any noise within the area before you make any offer.

*There are different rules and fees for different tenancy types. For details of our fees and charges to go to Savills.co.uk/tenant-fees. For more detailed information read our applicant guide at savills.co.uk/applicant-guide. Hard copy available on request. . 20191104SUBI

