



A well-presented and bright one-bedroom two-bathroom contemporary apartment in a period building with enviable views over Airrie Gardens.

Airrie Gardens, London W8

£1,275,000 Leasehold (987 years remaining)



Wonderful lateral space • Excellent living and entertaining space • Lovely green views • Access to communal gardens • Approx 0.5 miles from Notting Hill Gate Underground Station

Local Information

Airlie Gardens is located 0.5 miles from Notting Hill Gate and 0.4 miles from Kensington High Street with a wealth of excellent shops, restaurants and transport links (Central, District & Circle Lines). Holland Park itself is within 0.2 miles whilst Kensington Gardens is only 0.6 miles away.

About this property

Entered on the third floor (with lift) of an attractive period building, the apartment is well presented and offers excellent living and entertaining space, an abundance of natural light and ample storage throughout.

The west facing reception room benefits from a wonderful balcony overlooking Airlie Gardens, which the apartment has access to. The apartment has a separate kitchen, two bathrooms and one bedroom with an additional separate sleeping area/study located just off the reception room.

Tenure

Leasehold (987 years remaining)

Local Authority

Royal Borough of Kensington & Chelsea

Energy Performance

EPC Rating = D

Viewing

All viewings will be accompanied and are strictly by prior arrangement through Savills Kensington Office.
Telephone: +44 (0) 20 7535 3300.





Airlie Gardens, London, W8
Gross Internal Area 853 sq ft, 79 m²

Charlie Kennard
Kensington
+44 (0) 20 7535 3300
charlie.kennard@savills.com

 |  savills | savills.co.uk

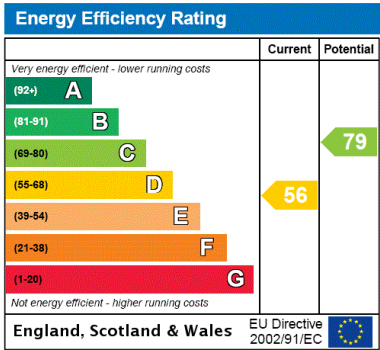
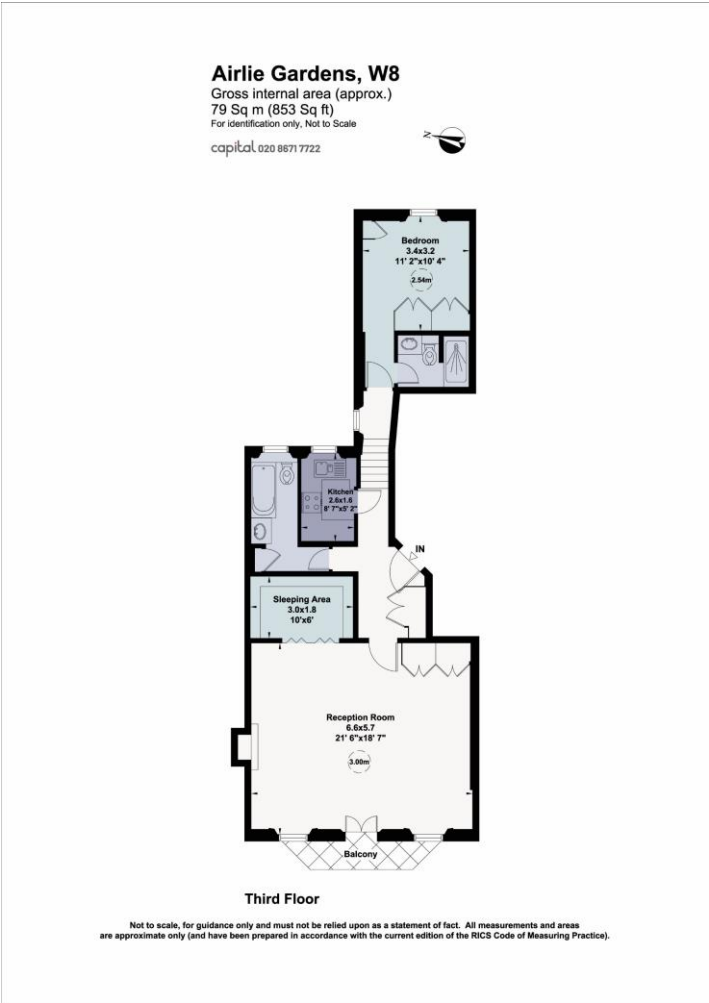

Important Notice Savills, its clients and any joint agents give notice that 1: They are not authorised to make or give any representations or warranties in relation to the property either here or elsewhere, either on their own behalf or on behalf of their client or otherwise. They assume no responsibility for any statement that may be made in these particulars. These particulars do not form part of any offer or contract and must not be relied upon as statements or representations of fact. 2: Any areas, measurements or distances are approximate. The text, photographs and plans are for guidance only and are not necessarily comprehensive. It should not be assumed that the property has all necessary planning, building regulation or other consents and Savills have not tested any services, equipment or facilities. Purchasers must satisfy themselves by inspection or otherwise. 20200915HHTV

