



A unmodernised three bedroom apartment in the heart of South Kensington

Melton Court, Onslow Crescent, London, SW7

£2,750,000 Leasehold (975 years remaining)

savills

- Spacious reception room with balcony
- Three bedrooms (two en suite)
- Study/fourth bedroom
- Large kitchen
- Ideal location minutes from South Kensington
- Excellent development opportunity

Local Information

Melton Court is located on Onslow Crescent in the heart of South Kensington so conveniently located for all the nearby cafes, restaurants and transport links of South Kensington, Knightsbridge and Chelsea. The nearest station is South Kensington just 0.1 miles away and is also host to a range of restaurants, shops and boutiques.

About this property

This sixth floor apartment comprises a delightful reception room with access to a private south-east facing balcony, three bedrooms (two en suite), an office which could serve as a fourth, single bedroom and a spacious kitchen with a wealth of surface and storage space. In addition, the property has a separate WC, use of the building's lift and a porter service.

Tenure

Leasehold (975 years remaining)

Local Authority

Royal Borough of Kensington and Chelsea

Energy Performance

EPC Rating = C

Viewing

All viewings will be accompanied and are strictly by prior arrangement through Savills Chelsea Office.
Telephone: +44 (0) 20 7578 9000.





Melton Court, Onslow Crescent, London, SW7
Gross Internal Area 1577 sq ft, 146.5 m²

William Hughes-Ward
Chelsea
+44 (0) 20 7578 9000
william.hughesward@savills.com

 |  savills | savills.co.uk

Melton Court, SW7

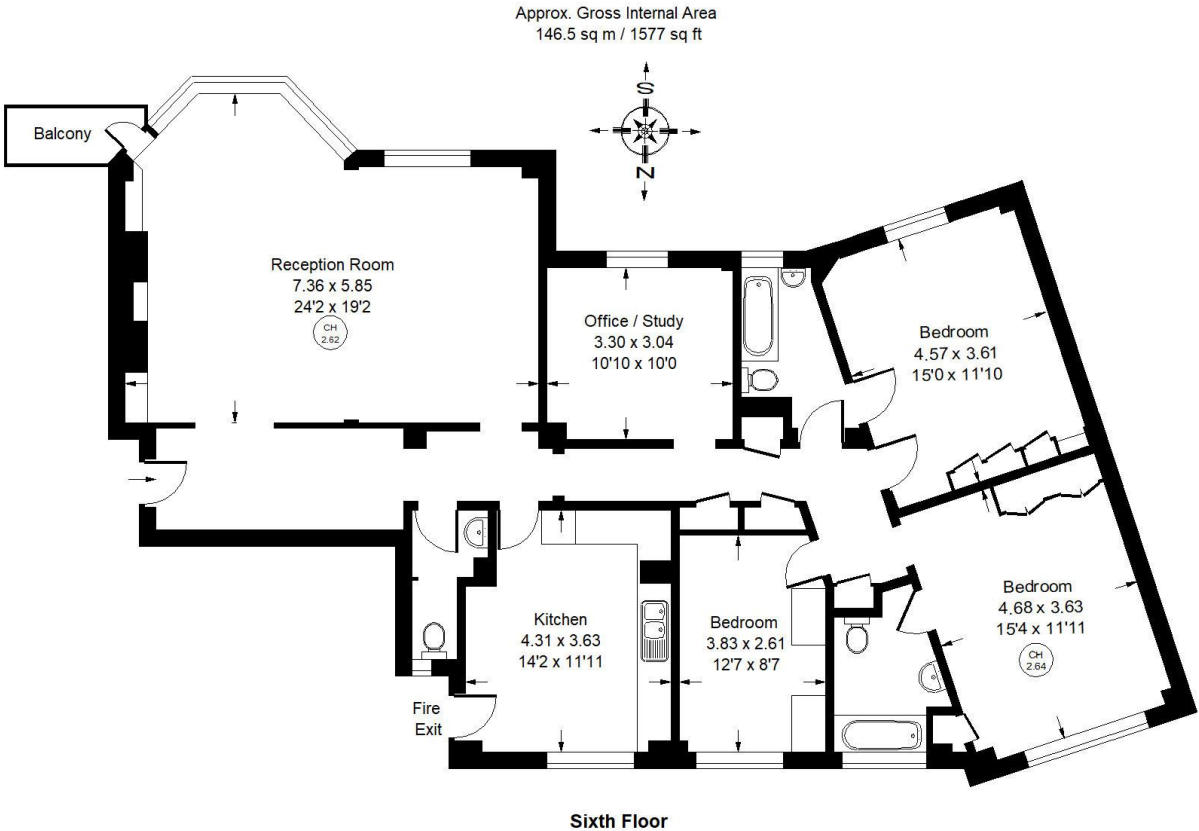

Whilst every attempt has been made to ensure the accuracy of the floor plan, measurements are approximate and not to scale.
No guarantee is given on the total square footage of the property quoted on the plan. Figures given are for guidance.
Plan is for illustration purposes only, not to be used for valuations.

Energy Efficiency Rating		
	Current	Potential
Very energy efficient - lower running costs		
(92+) A		
(81-91) B		
(69-80) C		
(55-68) D		
(39-54) E		
(21-38) F		
(1-20) G		
Not energy efficient - higher running costs		
	72	82
England, Scotland & Wales	EU Directive 2002/91/EC 	

Important Notice Savills, its clients and any joint agents give notice that 1: They are not authorised to make or give any representations or warranties in relation to the property either here or elsewhere, either on their own behalf or on behalf of their client or otherwise. They assume no responsibility for any statement that may be made in these particulars. These particulars do not form part of any offer or contract and must not be relied upon as statements or representations of fact. 2: Any areas, measurements or distances are approximate. The text, photographs and plans are for guidance only and are not necessarily comprehensive. It should not be assumed that the property has all necessary planning, building regulation or other consents and Savills have not tested any services, equipment or facilities. Purchasers must satisfy themselves by inspection or otherwise. 20200929EBEL

