



# Penthouse apartment at the Marina

Castle Quay, La Rue de L'Eau, St Helier, Jersey, JE3 3ED

Guide Price £675,000





- **Penthouse apartment at the waterfront**
- **Show home condition**

- **2 bedrooms, 2 bathrooms , 1 parking**

#### **Local Information**

Located at the waterfront, near restaurants, shops, gymnasium, cinema and local swimming pool. Only a short walk to the town centre for those working in St. Helier.

#### **About this property**

Built in 2012, this magnificent property offers both privacy and security and therefore lends itself well as either a main residence or an investment property.

It is bright and spacious and offers modern open plan living, with a fully equipped kitchen with Miele integrated appliances and stone work tops.

2 double bedrooms, 2 bathrooms, large balcony off the sitting room and master suite, Living room/kitchen/diner and separate utility room.

#### **Apartment features**

Private lift access  
Wired for Sky TV in both bedrooms and the lounge  
1 private secure underground parking space  
Concierge in main lobby  
Video entry system  
Approx 783 sq ft

#### **Services**

All mains except gas, fully double glazed, wired for digital TV, fibre and the internet. £267pcm service charge; to cover water, rates, building insurance, management fees, communal cleaning, lighting, electric garage gates servicing, car park charge, lift maintenance, service of a concierge and a contribution towards the sinking fund.

#### **Tenure**

Share Transfer

#### **Viewing**

All viewings will be accompanied and are strictly by prior arrangement through Savills Jersey Office.  
Telephone: 01534 722 227.





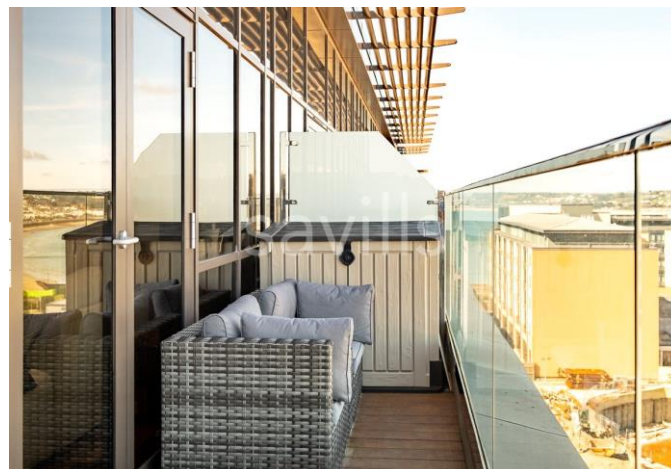

Castle Quay, La Rue de L'Eau, St Helier, Jersey, JE3  
Gross Internal Area 783 sq ft, m<sup>2</sup>

Savills Jersey  
+44 (0) 1534 722 227



savills

savills.je

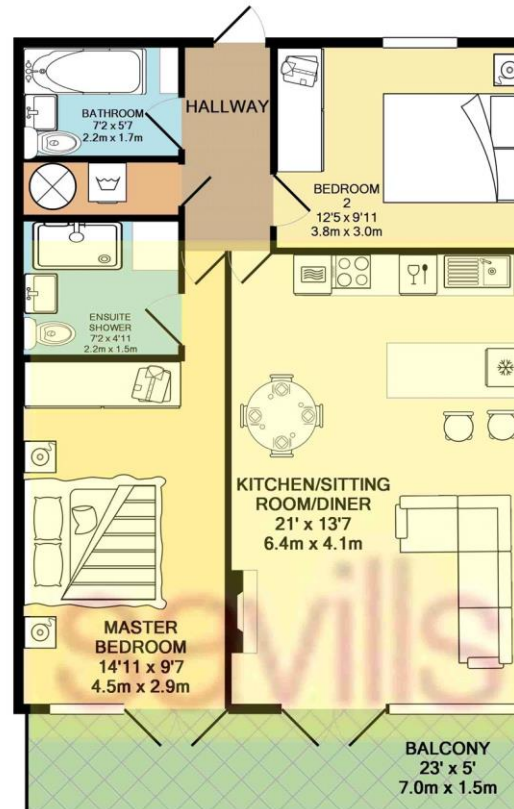

TOTAL APPROX. FLOOR AREA 783 SQ.FT. (72.7 SQ.M.)

Whilst every attempt has been made to ensure the accuracy of the floor plan contained here, measurements of doors, windows, rooms and any other items are approximate and no responsibility is taken for any error, omission, or mis-statement. This plan is for illustrative purposes only and should be used as such by any prospective purchaser. The services, systems and appliances shown have not been tested and no guarantee as to their operability or efficiency can be given  
Made with Metropix ©2016

**Important notice** Savills, its clients and any joint agents give notice that 1: They are not authorised to make or give any representations or warranties in relation to the property either here or elsewhere, either on their own behalf or on behalf of their client or otherwise. They assume no responsibility for any statement that may be made in these particulars. These particulars do not form part of any offer or contract and must not be relied upon as statements or representations of fact. 2: Any areas, measurements or distances are approximate. The text, photographs and plans are for guidance only and are not necessarily comprehensive. It should not be assumed that the property has all necessary planning, building regulation or other consents and Savills have not tested any services, equipment or facilities. Purchasers must satisfy themselves by inspection or otherwise.

