



POPULAR RESTAURANT IN GORGEOUS GOREY VILLAGE

JADE GARDEN CHINESE RESTAURANT
GOREY VILLAGE MAIN ROAD, GROUVILLE, JERSEY, JE3 9EP

Guide Price £1,450,000



POPULAR RESTAURANT IN GORGEOUS GOREY VILLAGE

JADE GARDEN CHINESE RESTAURANT
GOREY VILLAGE MAIN ROAD,
GROUVILLE, JERSEY, JE3 9EP

Guide Price £1,450,000

Ref No: JES160138 • Busy Chinese restaurant in popular Gorey Village • Licensed for 40 covers inside and 24 on terrace • 2 bedroom owners apartment • Plus 2 bedroom maisonette • 2 Staff rooms • Double Garage & parking • Garden • Approx 3745 sq ft • Qualified

Situation

Situated on the main road in Gorey Village, it is ideal for passing trade and also enjoys the village buzzy atmosphere.

Description

Due to retirement, this well established restaurant which is much loved by locals and tourists alike, is now for sale.

The restaurant is in good decorative order and with quality furniture. Registered 40 covers inside and 24 outside in the garden area. Well fitted bar area.

A substantial property which could be converted into a private house (subject to planning approval). In addition there is an attractive front garden & parking area, with double garage to the rear. Village car parks are only a stone's throw away. An establishment with great flexibility and potential.





A large and airy kitchen fitted with powerful extractor system. Gas cookers currently designed for Wok use. Walk in fridge etc. Access to outside.

Separate preparation area with stainless steel worktops and sinks.

2 Staff Rooms

Staff shower and W.C.

Owner apartment above restaurant

Outside

Double garage, parking at the front.

Garden

Viewing

Strictly by appointment with Savills.

Savills Jersey

+44 (0) 1534 722 227

savills.je

Important notice: Savills, their clients and any joint agents give notice that: 1: They are not authorised to make or give any representations or warranties in relation to the property either here or elsewhere, either on their own behalf or on behalf of their client or otherwise. They assume no responsibility for any statement that may be made in these particulars. These particulars do not form part of any offer or contract and must not be relied upon as statements or representations of fact. 2: Any areas, measurements or distances are approximate. The text, photographs and plans are for guidance only and are not necessarily comprehensive. It should not be assumed that the property has all necessary planning, building regulation or other consents and Savills have not tested any services, equipment or facilities. Purchasers must satisfy themselves by inspection or otherwise.



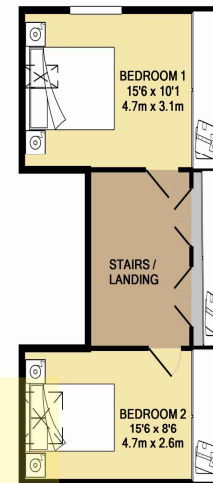
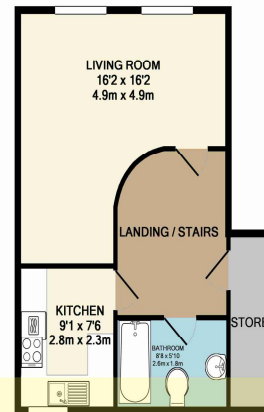
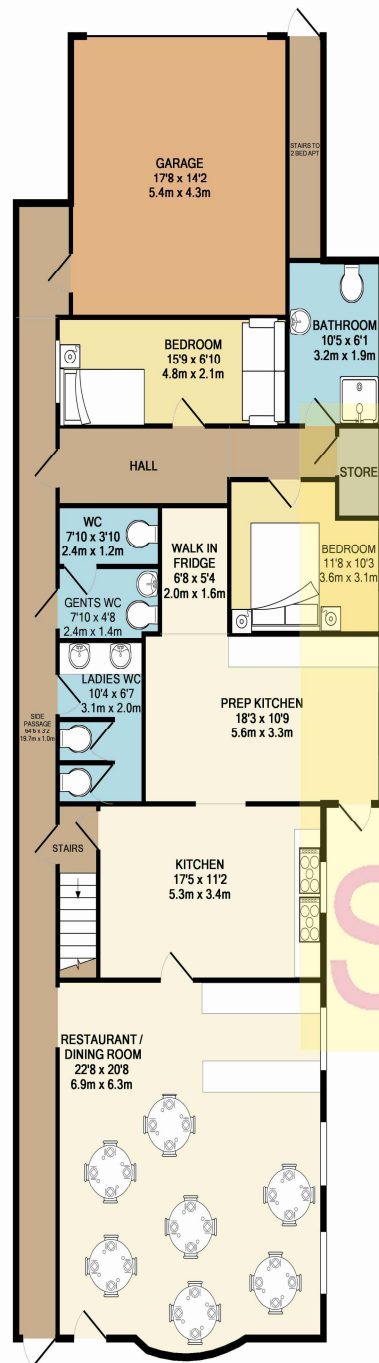

2ND FLOOR
APPROX. FLOOR AREA 405 SQ. FT. (37.6 SQ. M.)

TOTAL APPROX. FLOOR AREA 3745 SQ. FT. (347.9 SQ. M.)

Whilst every attempt has been made to ensure the accuracy of the floor plan contained here, measurements of doors, windows, rooms and any other items are approximate and no responsibility is taken for any error, omission, or mis-statement. This plan is for illustrative purposes only and should be used as such by any prospective purchaser. The services, systems and appliances shown have not been tested and no guarantee as to their operability or efficiency can be given.
Made with Metropix ©2016

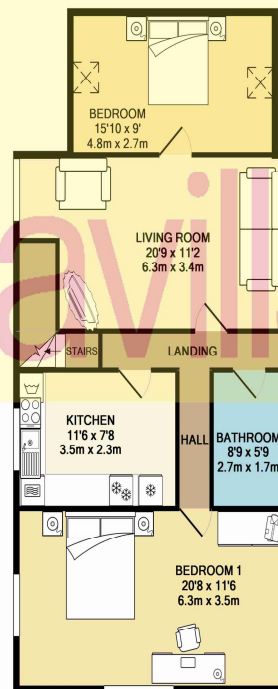

1ST FLOOR
APPROX. FLOOR AREA 1285 SQ. FT. (119.4 SQ. M.)