



A unique studio apartment with fantastic character

Northholme Road, London, N5

Guide Price £350,000 Leasehold (Lease Expiry April 2111)



Bedroom/kitchen/living room • Bathroom • Sotheby conservation area. • Fantastic location close to Highbury Fields • No Chain • Tree lined street • Hand painted by an award winning artist

Local Information

Northolme Road is an attractive residential street moments from Highbury Fields. The well renowned Highbury barn offers a selection of independent local shops including Bournes fishmonger, Godfreys butcher, Di Marios Deli alongside various restaurants and tea rooms. Upper Street is only a short distance away and a selection of transport links are on hand for easy access to the City and West End.

About this property

This unique studio located moments away from Highbury fields is the perfect city Pied-de-tere - ergonomically designed with eating area, desk, WiFi, fully fitted kitchen with hand made tiles and brass mixer taps as well as ceramic hob and microwave. There is a shower room with instant hot water, and a lovely view to the rear through a tall sash window.

Tenure

Leasehold (Lease Expiry April 2111)

Local Authority

Islington

Council Tax

Band = A

Ground Rent

£TBC per annum

Service Charge

£150 per annum

Energy Performance

EPC Rating = D

Viewing

All viewings will be accompanied and are strictly by prior arrangement through Savills Islington Office. Telephone: +44 (0) 207 226 1313.





Northholme Road, London, N5
Gross Internal Area 171 sq ft, 15.9 m²

 savills | savills.co.uk

Joe Marshall
Islington
+44 (0) 207 226 1313
joe.marshall@savills.com

Northholme Road, N5
Approximate Gross Internal Area = 171 sq ft / 15.89 sqm

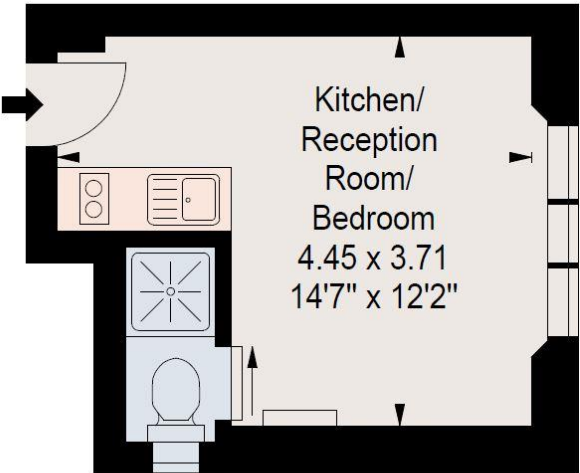

First Floor

Measured in accordance with RICS guidelines.
This floor plan is for illustrative purposes only
and must not be relied upon as a statement of fact.
© ollyhewitt.co.uk

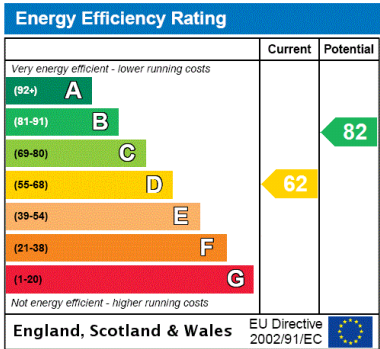

Important Notice Savills, its clients and any joint agents give notice that 1: They are not authorised to make or give any representations or warranties in relation to the property either here or elsewhere, either on their own behalf or on behalf of their client or otherwise. They assume no responsibility for any statement that may be made in these particulars. These particulars do not form part of any offer or contract and must not be relied upon as statements or representations of fact. 2: Any areas, measurements or distances are approximate. The text, photographs and plans are for guidance only and are not necessarily comprehensive. It should not be assumed that the property has all necessary planning, building regulation or other consents and Savills have not tested any services, equipment or facilities. Purchasers must satisfy themselves by inspection or otherwise. 20221026FLWL

