



A well appointed two bedroom flat set within a small quiet mews just a short walk from Highbury & Islington station.

**Albany Mews, London, N1**

£460 pw (£1,993.33 pcm) plus fees apply, Furnished  
Available from 06.12.2019



2 Bedrooms • Furnished • Close to Highbury and Islington station • Small quiet mews • Undergoing extensive redecoration

#### About this property

The property is undergoing extensive redecoration and comprises two equal sized double bedrooms, modern bathroom, spacious reception room and separate fully integrated kitchen.

Barnsbury Park is quiet, one way street in an excellent location for access to local amenities and transport links. The shops, cafes, bars and restaurants of Upper Street and Highbury & Islington station are all within a short walk away.

#### Furnishing

Furnished

#### Local Authority

Islington

#### Energy Performance

EPC Rating = C

#### Viewing

All viewings will be accompanied and are strictly by prior arrangement through Savills Islington Lettings Office.  
Telephone: +44 (0) 20 7354 6701.







Albany Mews, London, N1  
Gross Internal Area 614 sq ft, m²

Peter Crossan  
Islington Lettings  
+44 (0) 20 7354 6701  
peter.crossan@savills.com

 |  savills | savills.co.uk

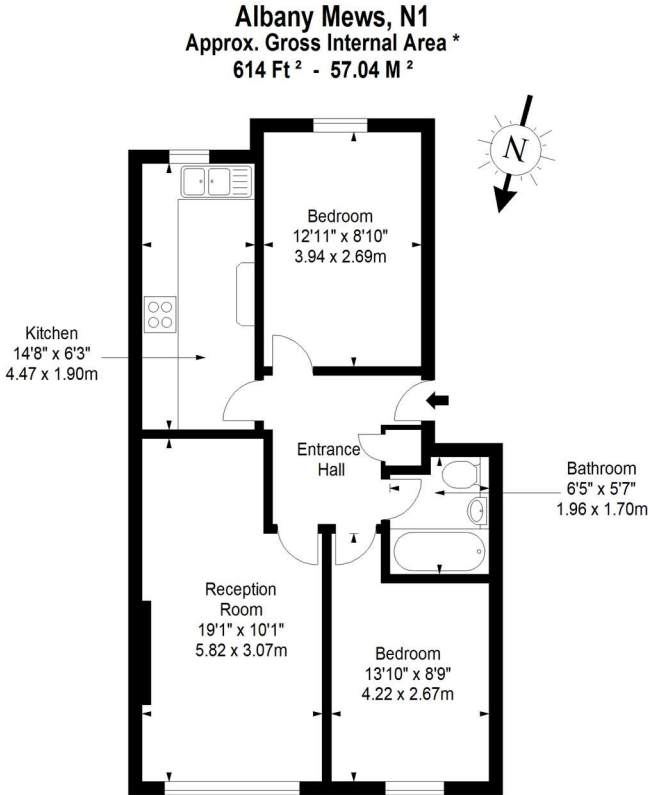

First Floor

Every attempt has been made to ensure the accuracy of this floor plan  
however, measurements are approximate and for illustration purposes only.  
Measured in accordance with the RICS code of measuring practice. Not to scale  
© Inside Photography Ltd.  
Tel 07850 620 122 , 0207 263 2188  
www.ipinteriors.co.uk

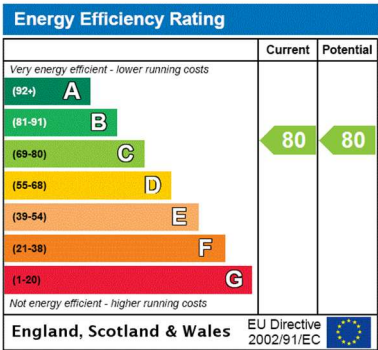

**Important notice** Savills, their clients and any joint agents give notice that: 1. They are not authorised to make or give any representations or warranties in relation to the property either here or elsewhere, either on their own behalf or on behalf of their client or otherwise. They assume no responsibility for any statement that may be made in these particulars. These particulars do not form part of any offer or contract and must not be relied upon as statements or representations of fact. 2. Any areas, measurements or distances are approximate. The text, images and plans are for guidance only and are not necessarily comprehensive. It should not be assumed that the property has all necessary planning, building regulation or other consents and Savills have not tested any services, equipment or facilities. Prospective tenants must satisfy themselves by inspection or otherwise. Please note that the local area may be affected by aircraft noise, you should make your own enquiries regarding any noise within the area before you make any offer.

\*There are different rules and fees for different tenancy types. For details of our fees and charges to go to Savills.co.uk/tenant-fees. For more detailed information read our applicant guide at savills.co.uk/applicant-guide. Hard copy available on request. . 20191127CRIC

