



A beautifully presented two bedroom apartment in a desirable red brick mansion block in Maida Vale.

Elgin Mansions, Elgin Avenue, Maida Vale, W9

£1,100,000 Leasehold (90 years remaining)



- A spacious top floor apartment
- Access to a private balcony and communal gardens
 - Spacious reception and dining area
 - Semi-open plan kitchen with breakfast bar
 - Stylish family bathroom

Local Information

Maida Vale is a stunning location in west London, offering period conversions and red-brick mansion flats some of which include well-manicured communal gardens.

Paddington Recreational Ground offers open green space for the avid jogger and dog walker, as well as an athletics track, gym and 3D artificial pitch.

BBC Maida Vale Studios is conveniently located on a quiet residential street and hosts a number of live performances.

About this property

A beautifully presented two bedroom apartment in a sought- after mansion block in Maida Vale.

The property benefits from wood flooring in the reception and kitchen, private balcony and access to communal gardens.

The accommodation comprises a bright double reception room which leads onto a fully integrated kitchen/breakfast room, additional family bathroom, principal bedroom benefiting from an en-suite shower room and a further double bedroom.

The property is conveniently positioned in a popular red brick mansions flat moments from Maida Vale station (Bakerloo Line), Paddington Recreational Ground and local amenities of Elgin Avenue and Lauderdale Parade.

Tenure

Leasehold (90 years remaining)

Service charges (approx.. per annum)

£3.000

Ground rent (approx. per annum)

£50.00

Local Authority

City Of Westminster

Energy Performance

EPC Rating = D

Viewing

All viewings will be accompanied and are strictly by prior arrangement through Savills Maida Vale & Little Venice Office.

Telephone: +44 (0) 20 3425 5600.





Elgin Mansions, Elgin Avenue, Maida Vale, W9
Gross Internal Area 1069 sq ft, 99.3 m²

George Baskerville
Maida Vale & Little Venice
+44 (0) 20 3425 5600
george.baskerville@savills.com

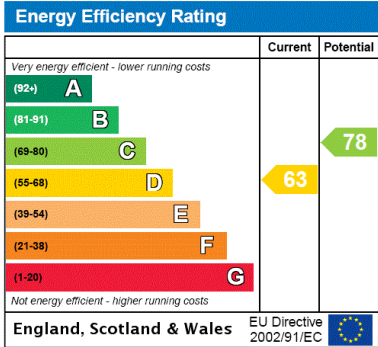
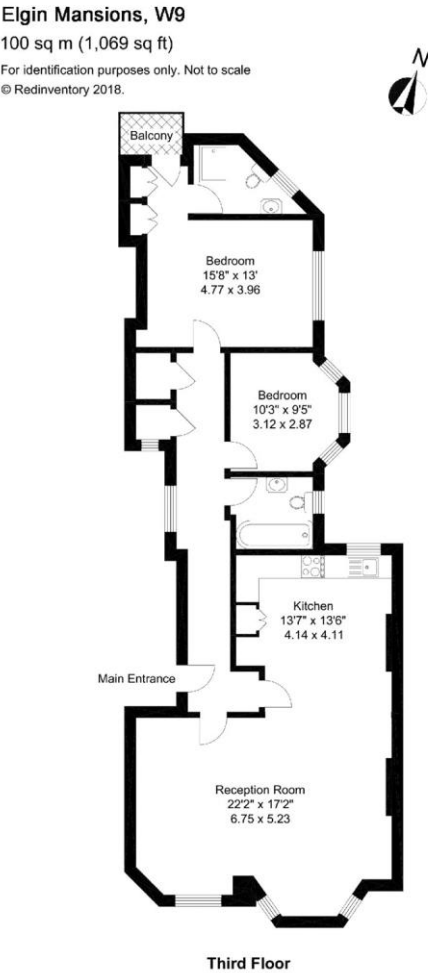

Important Notice Savills, its clients and any joint agents give notice that 1: They are not authorised to make or give any representations or warranties in relation to the property either here or elsewhere, either on their own behalf or on behalf of their client or otherwise. They assume no responsibility for any statement that may be made in these particulars. These particulars do not form part of any offer or contract and must not be relied upon as statements or representations of fact. 2: Any areas, measurements or distances are approximate. The text, photographs and plans are for guidance only and are not necessarily comprehensive. It should not be assumed that the property has all necessary planning, building regulation or other consents and Savills have not tested any services, equipment or facilities. Purchasers must satisfy themselves by inspection or otherwise. 20220509IVCH

