



An extremely attractive stucco fronted Grade II listed Georgian house.

Downshire Hill, Hampstead, London, NW3

Guide Price £3,750,000 Freehold



Charming Grade II listed house • Moments from the centre of the village • Four bedrooms • Attractive patio & terrace • Great location for the Heath

Local Information

Downshire Hill runs between Rosslyn Hill (A5021) in the south-west, and East Heath Road / South End Road in the north-east. The road ends in the north-east on the edge of the Hampstead Heath, with its green open spaces, and the charming shops and restaurants of Hampstead High Street at the south western end are within an easy stroll.

Hampstead Heath Overground Station is approximately 400 metres and Hampstead Underground Station (Northern Line) is approximately 650 metres walking distance.

About this property

The western part of Downshire Hill dates back to 1813 and this very attractive house follows all the rules of symmetry, proportion and balance typified in classical architecture of the period.

House has four bedrooms and two bathrooms over four floors. The raised ground floor boasts two reception rooms that have a more contemporary 'feel' to them, and on the lower ground floor there is a large kitchen and dining room which has direct access onto the patio garden. There is a charming balcony overlooking the street from the first floor, as well a further patio/terrace to the front from the raised ground floor.

Tenure

Freehold

Local Authority

London Borough of Camden

Council Tax

Band = H

Energy Performance

EPC Rating = To be confirmed

Viewing

All viewings will be accompanied and are strictly by prior arrangement through Savills Hampstead Office.

Telephone: +44 (0) 20 7472 5000.





Downshire Hill, London, NW3 1PA

Approximate Area = 1950 sq ft / 181 sq m
Limited Use Area(s) = 144 sq ft / 13 sq m
Total = 2095 sq ft / 194 sq m

For identification only - Not to scale

Denotes restricted
head height

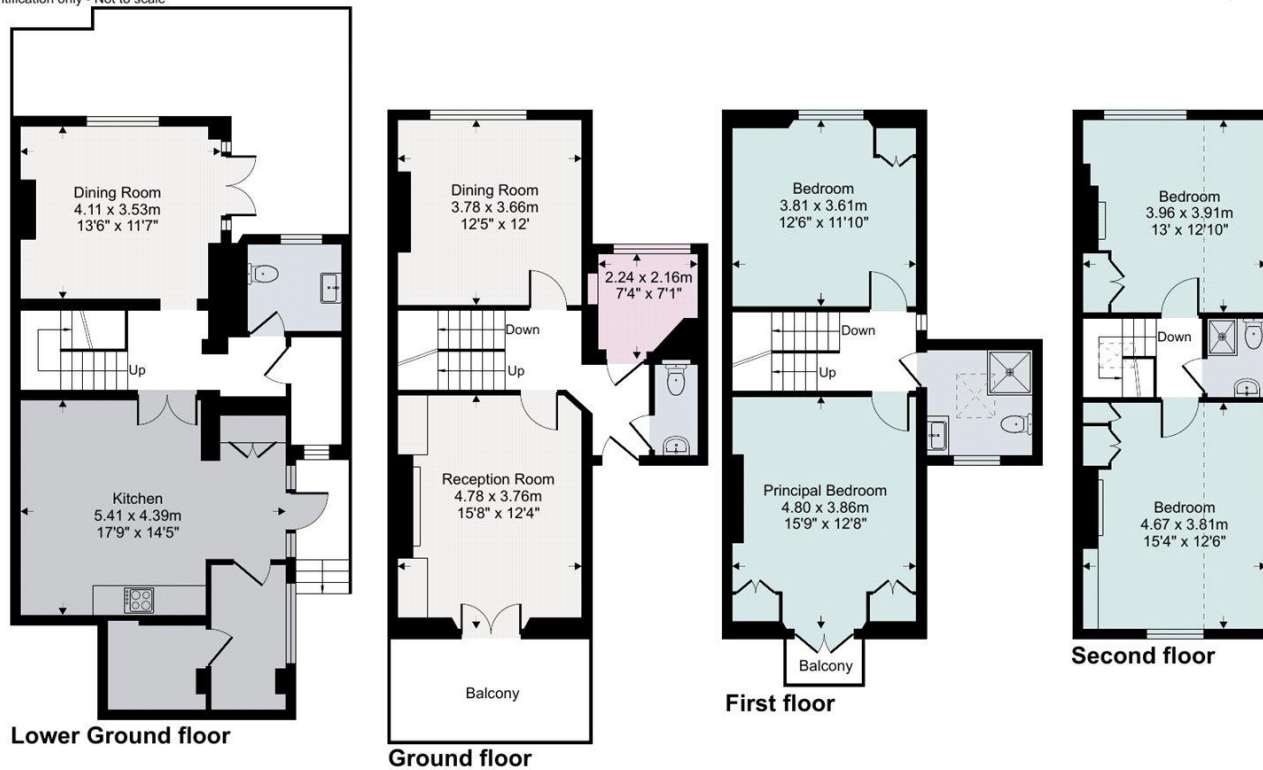

Floor plan produced in accordance with RICS Property Measurement Standards incorporating International Property Measurement Standards (IPMS2 Residential). © nchecon 2022. Produced for Savills (UK) Limited. REF: 829579

Important Notice Savills, its clients and any joint agents give notice that 1: They are not authorised to make or give any representations or warranties in relation to the property either here or elsewhere, either on their own behalf or on behalf of their client or otherwise. They assume no responsibility for any statement that may be made in these particulars. These particulars do not form part of any offer or contract and must not be relied upon as statements or representations of fact. 2: Any areas, measurements or distances are approximate. The text, photographs and plans are for guidance only and are not necessarily comprehensive. It should not be assumed that the property has all necessary planning, building regulation or other consents and Savills have not tested any services, equipment or facilities. Purchasers must satisfy themselves by inspection or otherwise. 20220624JESS

