



# A rare Grade II listed cottage in one of Hampstead's finest streets

**Keats Grove, Hampstead, London, NW3**

£1,500,000 Freehold





- Grade II listed Georgian house
- Keats Grove is a famous area for the writer's house museum
- Large front garden
- Hampstead village location
- Close to Hampstead Heath

Discretely tucked away behind a large front garden sits a fabulous Georgian two bedroom house, which was once the home of Dame Edith Sitwell DBE a British poet and critic. Now offered to the market for the first time in over 60 years this wonderful period property requires modernisation, yet retains all the charm and character of the era with attractive aspects both front and rear.

Keats Grove is famous for the writer's house museum and extends approximately east to west from South End Road to its junction with Downshire Hill. This wonderful location is within easy reach of the local amenities along South End Road, including a fantastic selection of cafes and restaurants in Hampstead Village and Belsize Park.

Hampstead Heath is within 150 metres of the property with local transport links available at Hampstead Heath Overground (0.3m) Belsize Park (0.7m) and Hampstead (0.9m) underground stations.

#### **Tenure**

Freehold

#### **Local Authority**

London Borough Of Camden

#### **Energy Performance**

EPC Rating = Exempt

#### **Viewing**

All viewings will be accompanied and are strictly by prior arrangement through Savills Hampstead Office.  
Telephone: +44 (0) 20 7472 5000.









**Keats Grove, Hampstead, London, NW3**  
**Gross Internal Area** 1245 sq ft, 115.7 m<sup>2</sup>

**James Diaper**  
Hampstead  
**+44 (0) 20 7472 5000**  
jdiaper@savills.com



savills

savills.co.uk

Approximate Area = 115.7 sq m / 1245 sq ft (Excluding Void)  
Including Limited Use Area (1.1 sq m / 11 sq ft)  
For identification only. Not to scale.  
© Fourwalls Group

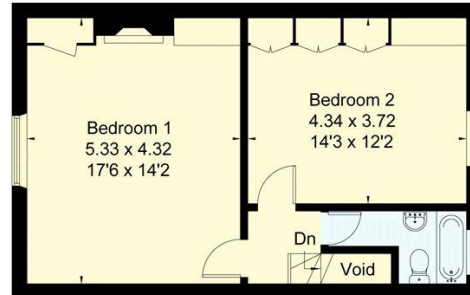

### First Floor

Area = 45.8 sq m / 493 sq ft  
(Limited Use Area = 0.4 sq m / 4 sq ft)

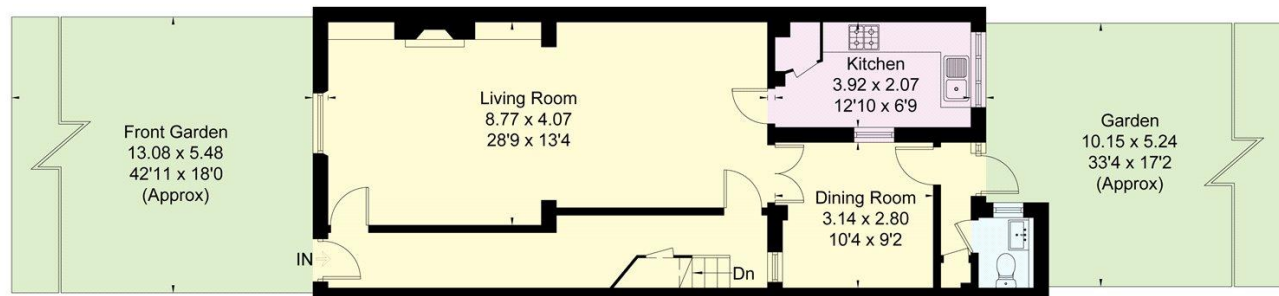

### Ground Floor

Area = 69.9 sq m / 752 sq ft  
(Limited Use Area = 0.7 sq m / 7 sq ft)

Surveyed and drawn in accordance with the International Property Measurement Standards (IPMS 2: Residential)  
fourwalls-group.com 233852

**Important notice** Savills, its clients and any joint agents give notice that 1: They are not authorised to make or give any representations or warranties in relation to the property either here or elsewhere, either on their own behalf or on behalf of their client or otherwise. They assume no responsibility for any statement that may be made in these particulars. These particulars do not form part of any offer or contract and must not be relied upon as statements or representations of fact. 2: Any areas, measurements or distances are approximate. The text, photographs and plans are for guidance only and are not necessarily comprehensive. It should not be assumed that the property has all necessary planning, building regulation or other consents and Savills have not tested any services, equipment or facilities. Purchasers must satisfy themselves by inspection or otherwise. 20191030JESS

