



A fantastic detached new build with a private garden area and parking.

7 Merriman Court, Le Foulon, St Peter Port, GY1 1YY

Asking Price £559,000



A superb detached new build offering generous accommodation • Immaculately presented with two bedrooms • Private garden area with use of the landscaped communal garden • Allocated parking for two vehicles with further on-street parking in the immediate area • Situated in a convenient yet quiet central location

Local Information

Merriman Court is situated in a fantastic central location remaining close to local amenities including restaurants and supermarkets, with the main town centre within very close proximity, while peaceful rural lanes are also on its doorstep.

A regular bus route is available along the Rohais.

The school catchment area for the property is Vauvert Primary and La Mare De Carteret High School.

About this property

Merriman Court is a superb development of sixteen immaculate, new build homes.

Number 7 is the only detached unit within the development situated in a quiet corner. With accommodation comprising a kitchen, opening through to a living room, hallway leading to two double bedrooms and a shower room.

Externally, the property benefits from a private garden area, allocated parking for two vehicles, use of the landscaped communal gardens and further on-street parking is available in the surrounding area.

Services and Notes

Mains electricity, water and drainage. Electric heating. UPVC double glazing. TRP TBC.

Directions

Travelling down Foulon Road from the Rohais, Merriman Court is situated on the left hand side on the corner of Route Isabelle. Perry's Guide Map Reference: Page 16 C5.

Tenure

Freehold

Viewing

All viewings will be accompanied and are strictly by prior arrangement through Savills Guernsey Office.

Telephone: +44 (0) 1481 713 463.





7 Merriman Court, Le Foulon, St Peter Port, GY1 1YY

Gross Internal Area 695 sq ft, 64.6 m²

Guernsey

+44 (0) 1481 713 463



savills

savills.gg

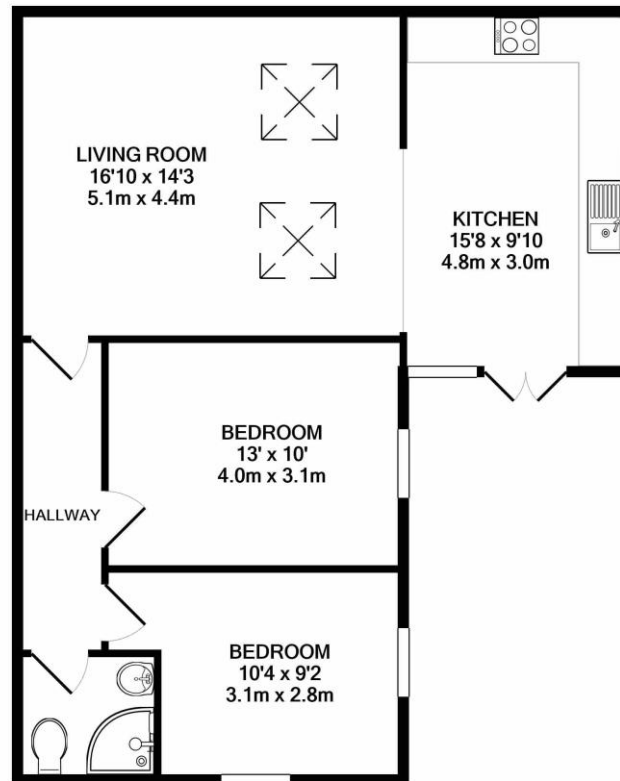

Whilst every attempt has been made to ensure the accuracy of the floor plan contained here, measurements of doors, windows, rooms and any other items are approximate and no responsibility is taken for any error, omission, or mis-statement. This plan is for illustrative purposes only and should be used as such by any prospective purchaser. The services, systems and appliances shown have not been tested and no guarantee as to their operability or efficiency can be given
Made with Metropix ©2020

Important notice Savills, its clients and any joint agents give notice that 1: They are not authorised to make or give any representations or warranties in relation to the property either here or elsewhere, either on their own behalf or on behalf of their client or otherwise. They assume no responsibility for any statement that may be made in these particulars. These particulars do not form part of any offer or contract and must not be relied upon as statements or representations of fact. 2: Any areas, measurements or distances are approximate. The text, photographs and plans are for guidance only and are not necessarily comprehensive. It should not be assumed that the property has all necessary planning, building regulation or other consents and Savills have not tested any services, equipment or facilities. Purchasers must satisfy themselves by inspection or otherwise.

