



## DETACHED HOME OFFERING GOOD ACCOMMODATION

COURTIL MARTIN, LES GIGANDS ROAD, ST SAMPSON, GUERNSEY

**OPEN MARKET - Unfurnished, £2,600 pcm**

**Available Now**





## CONVENIENTLY LOCATED CLOSE TO SHOPS AND SCHOOLS

---

• 4 Bedrooms • 1 Bathrooms • 2 Receptions  
• PART A OPEN MARKET • Detached Family  
House • Generous Accommodation • Garage,  
Gardens & Parking • Available by Negotiation

---

### Description

This detached family home offers good accommodation arranged over two floors, including four double bedrooms and a large sitting/dining room with doors leading out to the garden.

Outside there are enclosed south facing private gardens, along with parking for several vehicles.

Conveniently located close to shops and schools, Courtil Martin should be viewed to be fully appreciated.



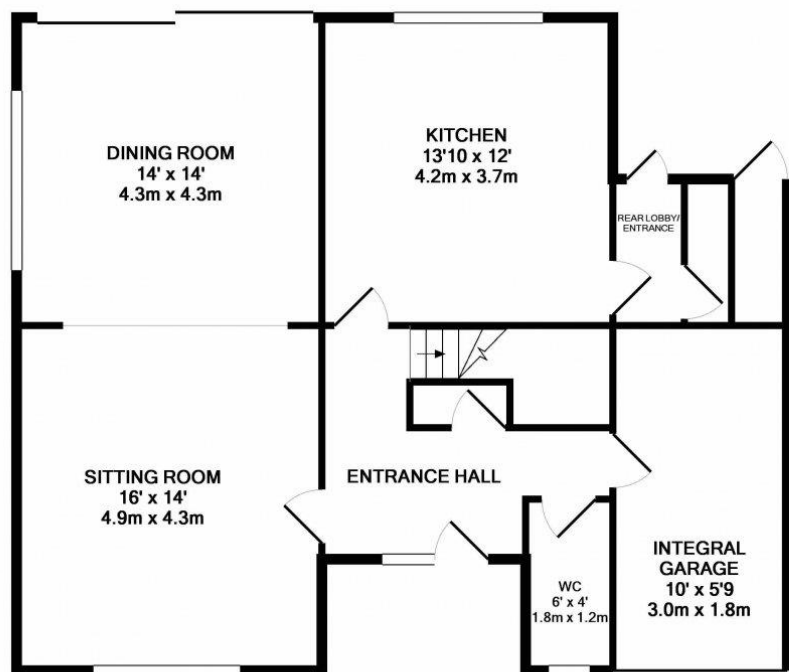

GROUND FLOOR

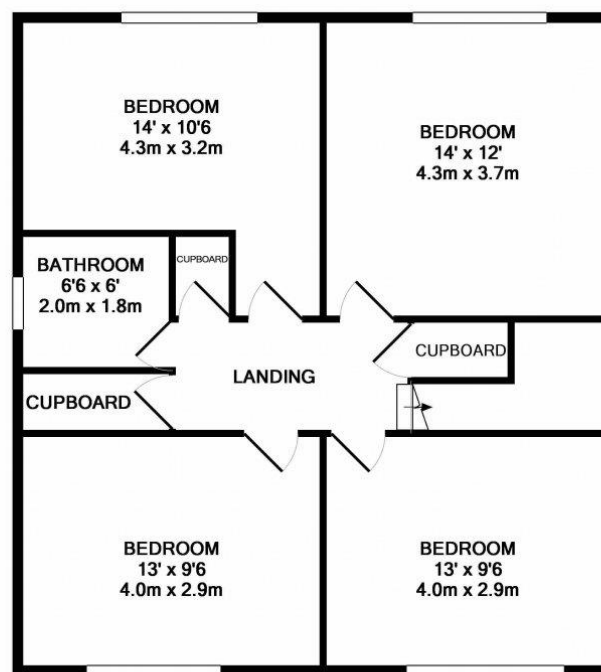

1ST FLOOR

Whilst every attempt has been made to ensure the accuracy of the floor plan contained here, measurements of doors, windows, rooms and any other items are approximate and no responsibility is taken for any error, omission, or mis-statement. This plan is for illustrative purposes only and should be used as such by any prospective purchaser. The services, systems and appliances shown have not been tested and no guarantee as to their operability or efficiency can be given.  
Made with Metropix ©2019

## FLOORPLANS

Gross internal area: 9085 sq ft, 844 m<sup>2</sup>





## Guernsey Lettings

Maxine Bell  
maxine.bell@savills.com

Important notice: Savills, their clients and any joint agents give notice that: 1: They are not authorised to make or give any representations or warranties in relation to the property either here or elsewhere, either on their own behalf or on behalf of their client or otherwise. They assume no responsibility for any statement that may be made in these particulars. These particulars do not form part of any offer or contract and must not be relied upon as statements or representations of fact. 2: Any areas, measurements or distances are approximate. The text, photographs and plans are for guidance only and are not necessarily comprehensive. It should not be assumed that the property has all necessary planning, building regulation or other consents and Savills have not tested any services, equipment or facilities. Tenants must satisfy themselves by inspection or otherwise.

20190704CETB

savills.gg