



A well constructed three bedroom, Pre-War detached home

Harcourt, Avenue Du Manoir, Ville Au Roi, St Peter Port, GY1 1PE

Asking Price £895,000





Detached Pre-War House • Attractive Leafy Surroundings • Quiet & Convenient Position • Modernised & Well Presented • Integral Garage & Further Parking • South Facing Rear Garden

Local Information

A residential property categorised as Part A on Guernsey's Open Market Housing Register and available for occupation by those holding a British or European Economic Area passport

About this property

A well constructed Pre-War detached home situated in an attractive tree lined avenue within the mature residential development of the Ville au Roi on the western outskirts of St Peter Port. The property has been recently modernised and is in a very presentable, ready to move in condition.

The accommodation is spacious and well laid out, with further scope for a potential conservatory or extension to the south elevation. There is a fair sized enclosed garden to the rear, which enjoys a sunny aspect, and an integral garage or workshop.

This is an excellent home for those looking for a good all round property in a location that is both convenient and quiet.

Services and Notes

Mains water, electricity, gas and drainage. Oil fired central heating. Upvc double glazing.

To include the fitted fittings, the fitted carpets and floor coverings, some fitted light fittings (but

specifically excluding the ceiling light in the dining room) and the fitted appliances - all to be detailed by inventory as part of the Conditions of Sale.

Directions

Perry's Guide Map Reference: Page 24 D2. Turn off the Ville au Roi road and proceed down Avenue du Manoir, past the turning into Aveue Germain, and Harcourt is the fifth property on the right hand side.

Tenure

Freehold

Viewing

All viewings will be accompanied and are strictly by prior arrangement through Savills Guernsey Office.

Telephone:

+44 (0) 1481 713 463.







Harcourt, Avenue Du Manoir, Ville Au Roi, St Peter Port, GY1

Gross Internal Area 2280 sq ft, 211.8 m²



savills

savills.gg

Richard Fox

Guernsey

+44 (0) 1481 713 463

richard.fox@savills.com

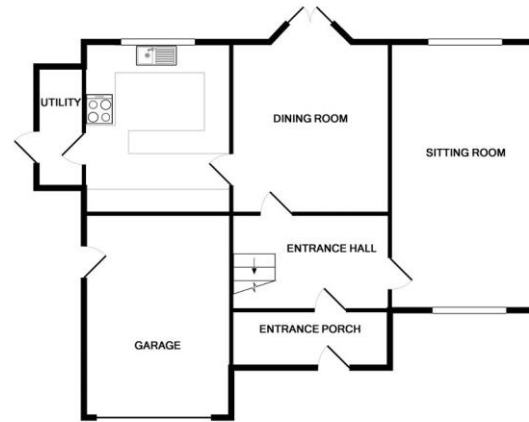

GROUND FLOOR



1ST FLOOR

Whilst every attempt has been made to ensure the accuracy of the floor plan contained here, measurements of doors, windows, rooms and any other items are approximate and no responsibility is taken for any error, omission or mis-statement. This plan is for illustrative purposes only and should be used as such by any prospective purchaser. The services, systems and appliances shown have not been tested and no guarantee as to their operability or efficiency can be given.
Made with Metropix G2019

Important notice Savills, its clients and any joint agents give notice that 1: They are not authorised to make or give any representations or warranties in relation to the property either here or elsewhere, either on their own behalf or on behalf of their client or otherwise. They assume no responsibility for any statement that may be made in these particulars. These particulars do not form part of any offer or contract and must not be relied upon as statements or representations of fact. 2: Any areas, measurements or distances are approximate. The text, photographs and plans are for guidance only and are not necessarily comprehensive. It should not be assumed that the property has all necessary planning, building regulation or other consents and Savills have not tested any services, equipment or facilities. Purchasers must satisfy themselves by inspection or otherwise.

