



MODERN FIRST FLOOR APARTMENT IN CENTRAL ST PETER PORT.

FIRST FLOOR APARTMENT, 28 VAUVERT, ST
PETER PORT, GY1 1NQ

Asking Price £245,000

Situated in a convenient central St Peter Port location near local amenities • Smart, modern accommodation throughout having been recently renovated • Forming part of a quiet building shared with only two other apartments • Unique benefit of a private enclosed rear garden area • Good long stay on-street parking available in the immediate vicinity

Description

This first floor apartment is one of three superb properties that form part of a recently renovated and extended building that is situated on the western outskirts of central St. Peter Port.

Each apartment offers an open plan living room, a fully fitted kitchen, a good sized bathroom and their own allocated rear garden.

There is plenty of on street parking along Vauvert and the neighbouring roads with the Odeon car park close by. This property is currently rented for £978 pcm, but is available to investors and first time buyers alike.

This apartment is situated in a convenient central location near to St Peter Port town with local amenities including restaurants, cafes, bars, shops and a supermarket all on its doorstep. A regular bus route is available nearby from Trinity Square or The Grange.

Services and Notes

Mains water, electricity & drainage. We understand the property is of granite construction. TRP 70.

To include the fitted carpets, the curtains and blinds as hung and fitted light fittings. Appliances include: Indesit Electric Oven, Indesit Four Ring Hob, Hotpoint Extractor Fan, Indesit Dishwasher, Indesit Fridge/Freezer, Indesit Washer/Dryer.

Tenure

Freehold

Guernsey

+44 (0) 1481 713 463

savills.gg

savills



FLOORPLANS

Gross internal area: 797 sq ft, 74 m²

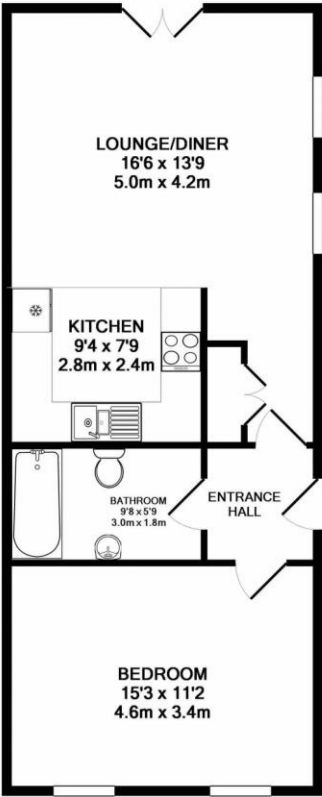

Whilst every attempt has been made to ensure the accuracy of the floor plan contained here, measurements of doors, windows, rooms and any other items are approximate and no responsibility is taken for any error, omission, or mis-statement. This plan is for illustrative purposes only and should be used as such by any prospective purchaser. The services, systems and appliances shown have not been tested and no guarantee as to their operability or efficiency can be given
Made with Metropix ©2019

Savills, their clients and any joint agents give notice that: 1. They are not authorised to make or give any representations or warranties in relation to the property either here or elsewhere, either on their own behalf or on behalf of their client or otherwise. They assume no responsibility for any statement that may be made in these particulars. These particulars do not form part of any offer or contract and must not be relied upon as statements or representations of fact. 2. Any areas, measurements or distances are approximate. The text, images and plans are for guidance only and are not necessarily comprehensive. It should not be assumed that the property has all necessary planning, building regulation or other consents and Savills have not tested any services, equipment or facilities. Purchasers must satisfy themselves by inspection or otherwise.