



Terraced townhouse situated in a convenient central location.

Philinda, 21 Mount Durand, St Peter Port, GY1 1EB

Asking Price £399,000

savills

Local Information

Philinda is situated in a convenient central location just a short distance from St Peter Port town centre with local amenities including restaurants, cafes, shops and supermarkets all on its doorstep.

A regular bus route is available close by from Trinity Square.

The school catchment area for the property is Vauvert Primary and La Mare De Carteret High School.

This listed four bedroom terraced town house offers plenty of potential for a purchaser to create a lovely family home.

The accommodation is spread over three floors and comprises entrance hallway, open plan living room, kitchen and utility on the ground floor. While occupying the first floor is two double bedrooms and a family bathroom, with a further two double bedrooms on the second floor.

Externally, there is a low maintenance rear courtyard with roof top views of town that provides a pleasant feeling of space. Good on-street and rented parking are available within close proximity.

Services & Notes

Mains water, gas, electricity and drainage. Single wood glazing. The property is of granite construction. TRP 124.

Directions

Perry's Guide Map Reference: Page T5 H9 Travelling down Mount Durand, the property is on the left hand side near the bottom of the road.

Viewing

All viewings will be accompanied and are strictly by prior arrangement through Savills Guernsey Office.
Telephone: +44 (0) 1481 713 463.

Philinda, 21 Mount Durand, St Peter Port, GY1 1EB

Gross Internal Area 1335 sq ft, 124 m²



Keith Enevoldsen
Guernsey
+44 (0) 1481 713 463
keith.enevoldsen@savills.com

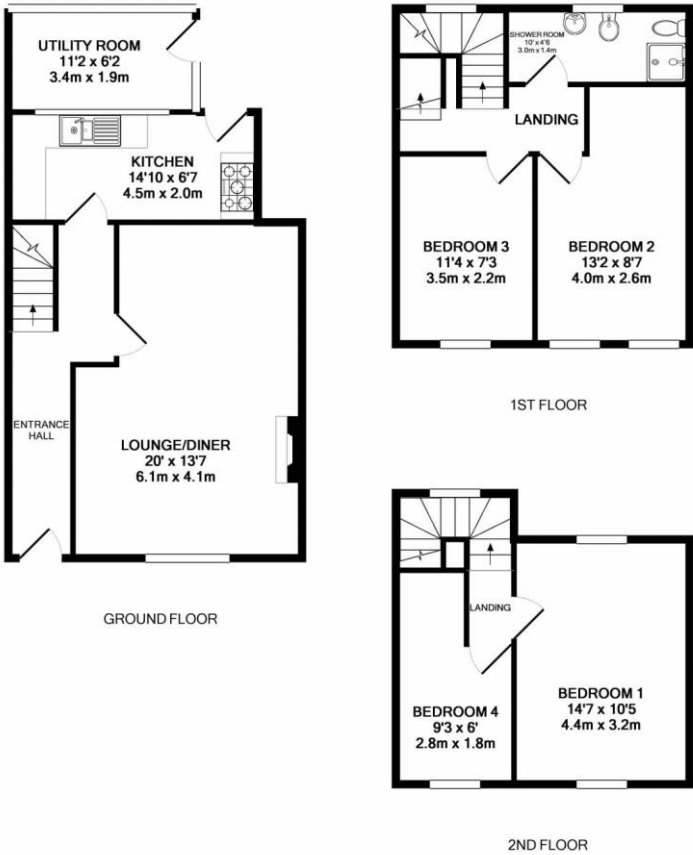

Whilst every attempt has been made to ensure the accuracy of the floor plan contained here, measurements of doors, windows, rooms and any other items are approximate and no responsibility is taken for any error, omission, or mis-statement. This plan is for illustrative purposes only and should be used as such by any prospective purchaser. The services, systems and appliances shown have not been tested and no guarantee as to their operability or efficiency can be given
Made with Metropix ©2019

Important notice Savills, its clients and any joint agents give notice that 1: They are not authorised to make or give any representations or warranties in relation to the property either here or elsewhere, either on their own behalf or on behalf of their client or otherwise. They assume no responsibility for any statement that may be made in these particulars. These particulars do not form part of any offer or contract and must not be relied upon as statements or representations of fact. 2: Any areas, measurements or distances are approximate. The text, photographs and plans are for guidance only and are not necessarily comprehensive. It should not be assumed that the property has all necessary planning, building regulation or other consents and Savills have not tested any services, equipment or facilities. Purchasers must satisfy themselves by inspection or otherwise. 20191119ANHX

