



Contemporary apartment near station

Flat 2, 2 Ditton Grove, Esher, Surrey, KT10 9FN

Leasehold

savills

Open plan reception room/kitchen • 2 bedrooms
• Bathroom • Private roof terrace • Allocated parking

Local information

Ditton Grove is ideally located close to Esher High Street (about 0.5 miles) with its range of shops, bars, boutiques, cinema and restaurants. More extensive shopping is available at Kingston-upon-Thames (about 3.5 miles). Esher train station (regular rail service to London Waterloo from 23 minutes) is 0.3 miles away. The internationally recognised Sandown Park Racecourse is located nearby which hosts a number of sporting, culture and music events.

About this property

Situated on the first floor of this modern development is this brand new two bedroom apartment. The main living space is open-plan in its design with a range of modern built-in cupboards

and fitted appliances. French doors open onto a small, yet very private roof terrace. Both the master bedroom and the second bedroom are doubles and feature double built-in wardrobes. There is a beautifully appointed bathroom and large storage cupboard which complete the accommodation. Externally there is parking for one car.

Tenure

Leasehold

Local Authority

Elmbridge Borough Council

Viewing

Strictly by appointment with Savills





Flat 2, 2 Ditton Grove, Esher, Surrey, KT10 9FN



savills

savills.co.uk

Savills Esher
01372 461900
esher@savills.com

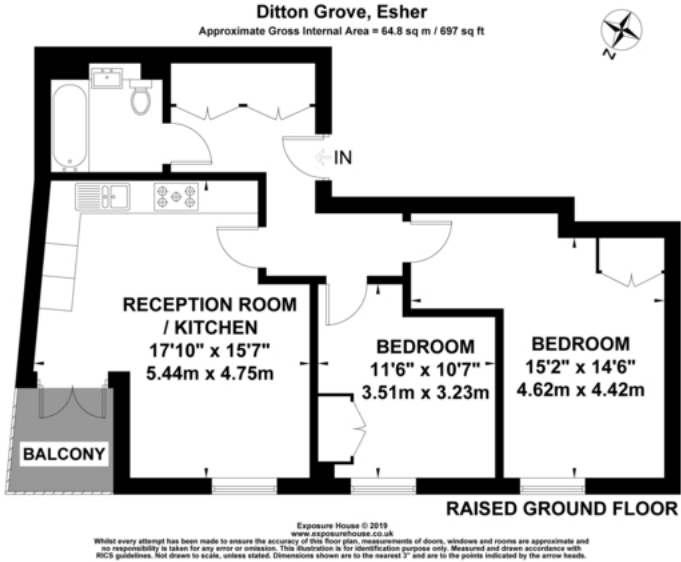

Energy Efficiency Rating		
	Current	Potential
Very energy efficient - lower running costs		
(92-100) A		
(81-91) B	84	84
(69-80) C		
(55-68) D		
(39-54) E		
(21-38) F		
(1-20) G		
Not energy efficient - higher running costs		
England, Scotland & Wales		EU Directive 2002/91/EC

Important notice: Savills, their clients and any joint agents give notice that 1: They are not authorised to make or give any representations or warranties in relation to the property either here or elsewhere, either on their own behalf or on behalf of their client or otherwise. They assume no responsibility for any statement that may be made in these particulars. These particulars do not form part of any offer or contract and must not be relied upon as statements or representations of fact. 2: Any areas, measurements or distances are approximate. The text, photographs and plans are for guidance only and are not necessarily comprehensive. It should not be assumed that the property has all necessary planning, building regulation or other consents and Savills have not tested any services, equipment or facilities. Purchasers must satisfy themselves by inspection or otherwise. 02021020 Job ID: 139172 User initials: KMS

