



Beautiful apartment with communal gardens

2 Oak Hill Court, Oak Hill Road, Surbiton, Surrey KT6 6EL

Leasehold



Reception/ dining area • Kitchen • 2 bedrooms • Family bathroom • Communal gardens

Local information

2 Oak Hill Court is situated on one of the premier roads in the Oak Hill conservation area.

The property is located just about 0.3 miles from Surbiton station which offers a regular and direct line to London Waterloo in approximately 17 minutes. Central London is easily accessible by car via the A3 and the motorway network (M3, Junction 1) is about 7 miles away. Heathrow and Gatwick airports are located 12 and 24 miles away respectively.

Surbiton offers a wide range of shops, bars, restaurants and other amenities whilst nearby Kingston-upon-Thames is a beautiful riverside walk, with its extensive shopping centre.

The area is very popular with families as there is an excellent selection of schools available to all age levels, both in the state and private sector, including Shrewsbury House, Surbiton High School, Hinchley Wood School, Thames Ditton Infants, The Tiffin School, Tiffin Girl's School and Kingston Grammar School.

About this property

2 Oak Hill Court is a spacious ground floor apartment within a charming 1930's building.

You are welcomed into the expansive entrance hall which leads to all the rooms and offers useful built in storage. The large reception/ dining room sits to the left and is the perfect place

for both everyday use and entertaining. The kitchen is located in the centre of the apartment and provides a number of modern units, a range of integrated appliances, stone worktops and a gas cooker. To the right are two bedrooms; a spacious principle bedroom and a second bedroom which benefits from views over the communal gardens. Completing the accommodation is the well-appointed family bathroom with separate wc.

Externally this apartment benefits from a beautiful landscaped communal gardens.

Tenure

Leasehold

Local Authority

Kingston upon Thames London Borough Council

Viewing

Strictly by appointment with Savills





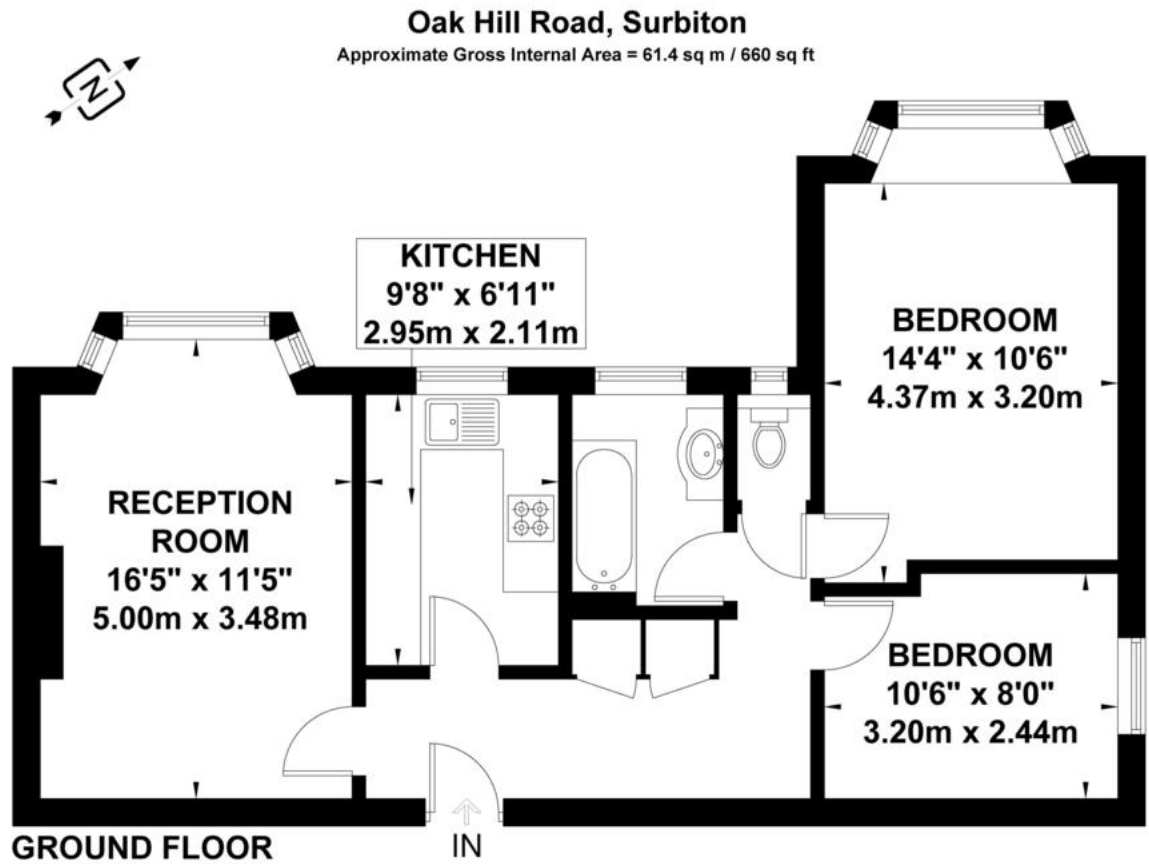

Exposure House © 2021
www.exposure.house
Whilst every attempt has been made to ensure the accuracy of this floor plan, measurements of doors, windows and rooms are approximate and no responsibility is taken for any error or omission. This illustration is for identification purpose only. Measured and drawn accordance with RICS guidelines. Not drawn to scale, unless stated. Dimensions shown are to the nearest 3" and are to the points indicated by the arrow heads.

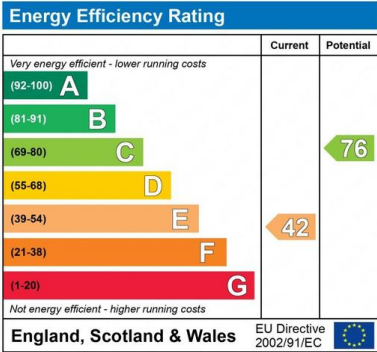

Important notice: Savills, their clients and any joint agents give notice that 1: They are not authorised to make or give any representations or warranties in relation to the property either here or elsewhere, either on their own behalf or on behalf of their client or otherwise. They assume no responsibility for any statement that may be made in these particulars. These particulars do not form part of any offer or contract and must not be relied upon as statements or representations of fact. 2: Any areas, measurements or distances are approximate. The text, photographs and plans are for guidance only and are not necessarily comprehensive. It should not be assumed that the property has all necessary planning, building regulation or other consents and Savills have not tested any services, equipment or facilities. Purchasers must satisfy themselves by inspection or otherwise. 12029012 Job ID: 154214 User initials: TDS