



A superb ground floor one bedroom apartment

Bolander Grove, Lillie Square, SW6
Leasehold



• EPC rating: B

Bolander Grove, Lillie Square, SW6
Gross internal area (approx) 50.03 sq m/539sq ft

Daniel Carrington
Earl's Court
020 7578 6901
dan.carrington@savills.com



Local information

A few minutes' walk from West Brompton and Earl's Court stations. Heathrow, City and Gatwick airport within 60 minutes travel time.

About this property

The accommodation comprises open plan living room/kitchen/ dining room, a spacious double bedroom that fits a king size bed, bathroom. The property is finished to a very high standard and benefits from many modern amenities as well as one of the largest private patio gardens in the whole development.

Tenure

Leasehold
Approx 994 Years remaining

Price

£725.000

Local authority

Royal Borough of Kensington and Chelsea

Energy Performance

A copy of the full Energy Performance Certificate is available upon request.

Viewing

Strictly by appointment with Savills.

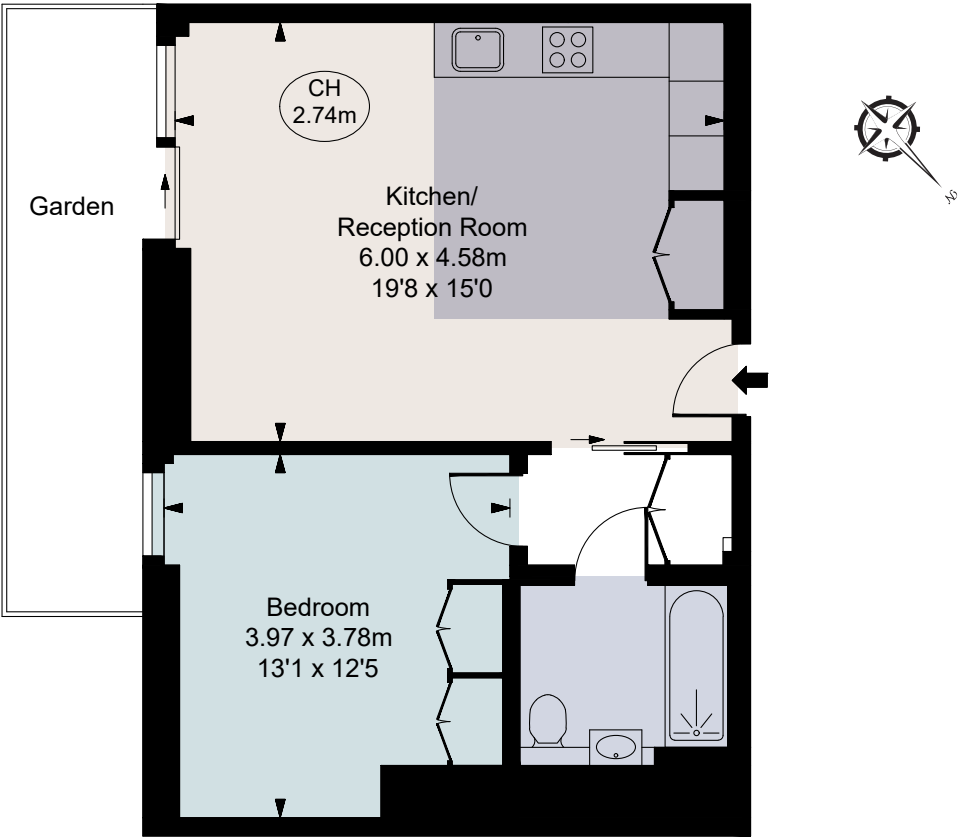

Ground Floor

For identification only. Not to scale. © 16/05/2019

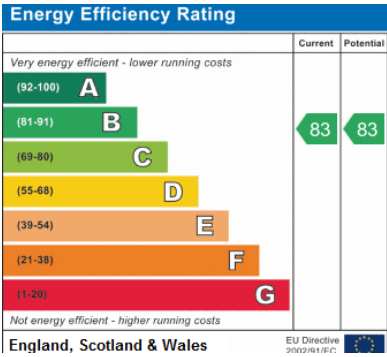

Important notice Savills, its clients and any joint agents give notice that 1: They are not authorised to make or give any representations or warranties in relation to the property either here or elsewhere, either on their own behalf or on behalf of their client or otherwise. They assume no responsibility for any statement that may be made in these particulars. These particulars do not form part of any offer or contract and must not be relied upon as statements or representations of fact. 2: Any areas, measurements or distances are approximate. The text, photographs and plans are for guidance only and are not necessarily comprehensive. It should not be assumed that the property has all necessary planning, building regulation or other consents and Savills have not tested any services, equipment or facilities. Purchasers must satisfy themselves by inspection or otherwise. Brochure by fulhamperformance.co.uk

