



An impressive first floor two bedroom apartment with south facing views and a private balcony

Elvaston Place, London, SW7

£1,495,000 Share of Freehold



Entrance hall
Reception room/Kitchen
2 Bedrooms
Bathroom
Private balcony

Local Information

The property is located approximately 0.3 miles away from Gloucester Road Tube Station (Piccadilly, District & Circle Lines). It is also perfectly positioned for many famous landmarks such as Hyde Park (approx. 0.3 miles), Royal Albert Hall (approx. 0.4 miles), Imperial College (approx. 170 yards), Natural History Museum (approx 0.4 miles) and Harrods (approx 1 mile).

About this property

The apartment is located in an attractive period building mainly constructed from the iconic London Brick with white stucco decorative features. Within these buildings the first floor was designed to be the premium position with a charming private balcony.

The accommodation comprises an entrance hall, a spacious open plan reception & kitchen, two bedrooms and a bathroom.

Tenure

Share of Freehold

Local Authority

The Royal Borough of Kensington and Chelsea

Energy Performance

EPC Rating = D

Viewing

All viewings will be accompanied and are strictly by prior arrangement through Savills Earl's Court Office.
Telephone: +44 (0) 20 7578 6900.

Photos taken: May 2016





Elvaston Place, London, SW7
Gross Internal Area 829 sq ft, 77 m²

Earl's Court
+44 (0) 20 7578 6900
dan.carrington@savills.com

 |  savills | savills.co.uk

Elvaston Place, SW7

Gross internal area (approx) :-
77 sq m / 829 sq ft

For identification only. Not to scale.
© Floorplanz Ltd

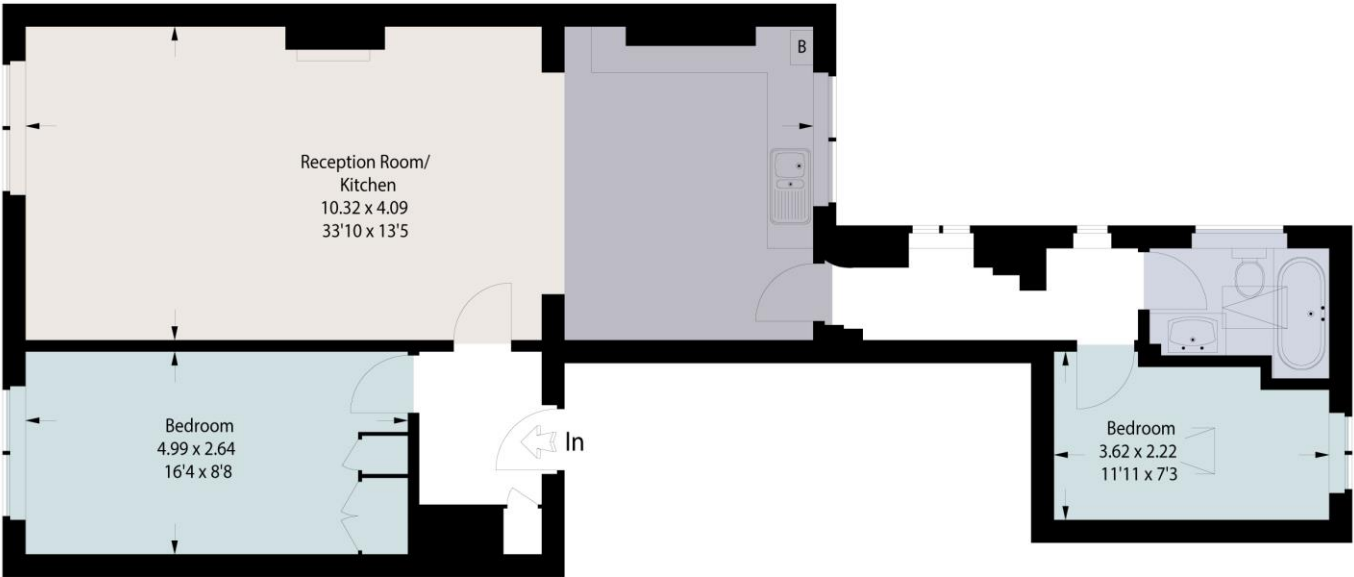

First Floor

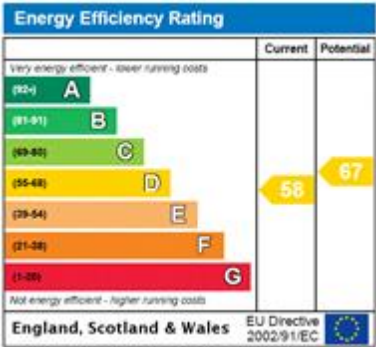

Important notice Savills, its clients and any joint agents give notice that 1: They are not authorised to make or give any representations or warranties in relation to the property either here or elsewhere, either on their own behalf or on behalf of their client or otherwise. They assume no responsibility for any statement that may be made in these particulars. These particulars do not form part of any offer or contract and must not be relied upon as statements or representations of fact. 2: Any areas, measurements or distances are approximate. The text, photographs and plans are for guidance only and are not necessarily comprehensive. It should not be assumed that the property has all necessary planning, building regulation or other consents and Savills have not tested any services, equipment or facilities. Purchasers must satisfy themselves by inspection or otherwise. 20200225ANIL

