



Modern two bedroom apartment along Candle Street, located next to the wonderful Regent's Canal.

Gray Court, 7 Candle Street, London, E1

£430,000 Leasehold



Popular development situated next to Regents Canal • Bright South facing apartment with Juliet balcony • Well-presented throughout with lovely communal gardens • Walking distance of Stepney Green, Limehouse and Mile End stations for easy access across London • Close to a range of green spaces from Victoria Park to Mile End park

About this property

The property offers well-organised accommodation throughout spanning 660 sq ft, with lateral reception room, South facing Juliet balcony and fitted kitchen which is part open plan to the main living space. Furthermore there is excellent storage in the bedrooms and plenty of space for a double bedroom and storage in the second bedroom. A family sized bathroom and utility space can be found along the hallway.

Residents benefit from scenic communal gardens steeped in history with access to Regents canal providing a lovely walk towards Victoria Park and Islington. Secure underground parking is also available at additional request for just under £600 per annum.

AGENTS NOTE: We wish to inform prospective buyers of this property that the seller is related to an employee of Savills.

Local Information

Mile End Park, Limehouse Marina, Regent's Canal, and the banks of River Thames are within walking distance with access to a variety of cafes, pubs, restaurants and local amenities set for your comfort, including The Grapes and The Narrow with riverside views!

Canary Wharf, the City and the Queen Mary University of London are also nearby, offering plenty of opportunities for corporate and academic purchasers.

Tenure

Leasehold

Local Authority

Tower Hamlets

Energy Performance

EPC Rating = To be confirmed

Viewing

All viewings will be accompanied and are strictly by prior arrangement through Savills Wapping Office.
Telephone: +44 (0) 20 7456 6800.





Gray Court, 7 Candle Street, London, E1
Gross Internal Area 660 sq ft, 61.3 m²



savills

savills.co.uk

Chloe Luxon
Wapping
+44 (0) 20 7456 6800
chloe.luxon@savills.com

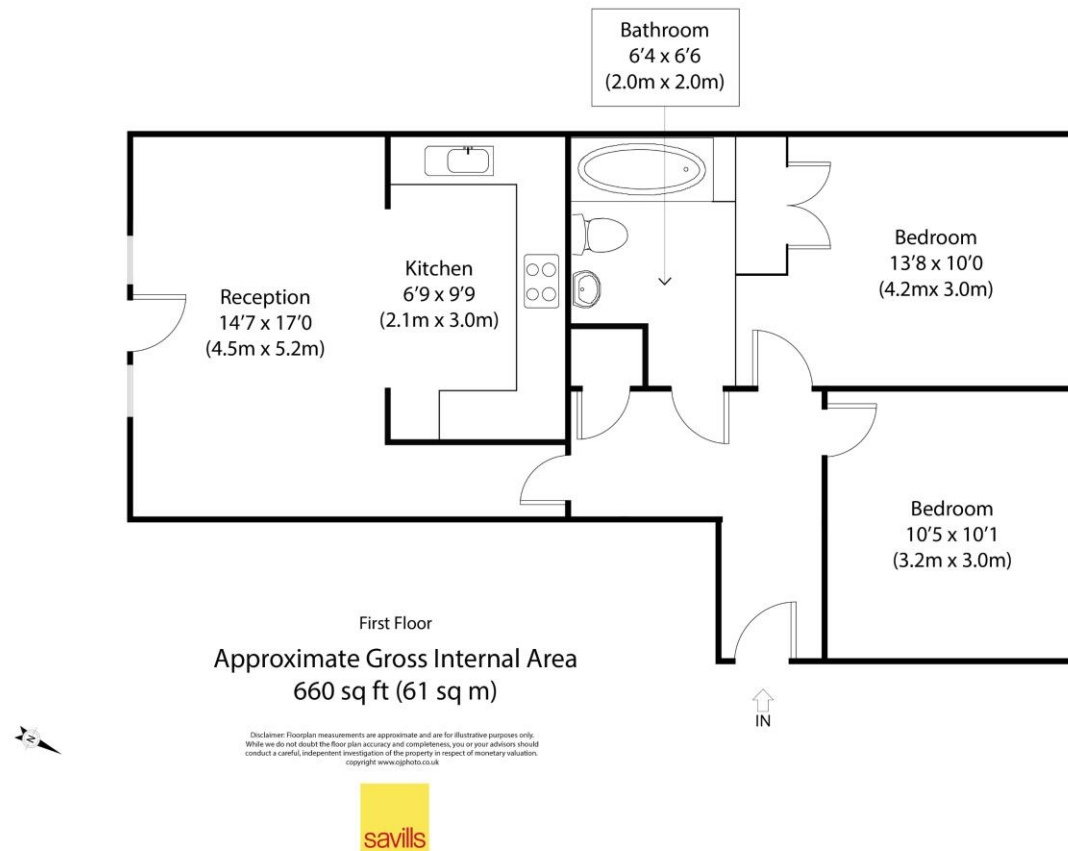

Important Notice Savills, its clients and any joint agents give notice that 1: They are not authorised to make or give any representations or warranties in relation to the property either here or elsewhere, either on their own behalf or on behalf of their client or otherwise. They assume no responsibility for any statement that may be made in these particulars. These particulars do not form part of any offer or contract and must not be relied upon as statements or representations of fact. 2: Any areas, measurements or distances are approximate. The text, photographs and plans are for guidance only and are not necessarily comprehensive. It should not be assumed that the property has all necessary planning, building regulation or other consents and Savills have not tested any services, equipment or facilities. Purchasers must satisfy themselves by inspection or otherwise. 20210510GILE

