



## Newly renovated two bedroom apartment in Artichoke Hill.

**Artichoke Hill, London, E1W**

£529,000 Leasehold





Centrally located for easy access into the City and Canary Wharf • Bright and airy throughout with open plan reception room • Situated within a gated development with fob and lift access • Long lease with over 900 years remaining • Next to the new London Dock development with a range of on-site shops and restaurants

#### Local Information

Artichoke Hill sits in central Wapping, close to the Tobacco Dock event space, and around the corner from St Katharine Docks with its shops, bars, and restaurants.

The nearest stations are Tower Hill and Tower Gateway, however, many residents prefer to walk into the City.

#### About this property

Bright and airy throughout this two bedroom benefits from an open plan reception room with recently refurbished fully fitted kitchen, modern family bathroom with neutral tiling, glass shelves and an over-bath shower and white suite. Two bedrooms can be found to the rear, principal bedroom offering fitted wardrobes.

The property is located within Artichoke Hill, a gated complex with a long lease remaining with over 900 years.

#### Tenure

Leasehold

#### Local Authority

Tower Hamlets

#### Energy Performance

EPC Rating = To be confirmed

#### Viewing

All viewings will be accompanied and are strictly by prior arrangement through Savills Wapping Office.  
Telephone: +44 (0) 20 7456 6800.





**Artichoke Hill, London, E1W**  
**Gross Internal Area** 680 sq ft, 63.2 m<sup>2</sup>

**Chloe Luxon**  
Wapping  
**+44 (0) 20 7456 6800**  
chloe.luxon@savills.com



savills

savills.co.uk

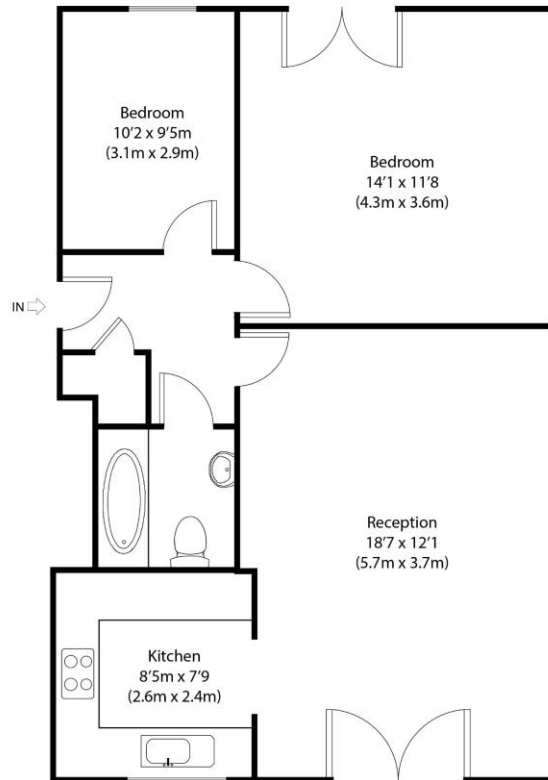

First Floor

Approximate Gross Internal Area  
680 sq ft (63 sq m)

Disclaimer: Floorplan measurements are approximate and are for illustrative purposes only. While we do not doubt the floor plan accuracy and completeness, you or your advisors should conduct a careful, independent investigation of the property in respect of monetary valuation. copyright www.ojphoto.co.uk



**Important Notice** Savills, its clients and any joint agents give notice that 1: They are not authorised to make or give any representations or warranties in relation to the property either here or elsewhere, either on their own behalf or on behalf of their client or otherwise. They assume no responsibility for any statement that may be made in these particulars. These particulars do not form part of any offer or contract and must not be relied upon as statements or representations of fact. 2: Any areas, measurements or distances are approximate. The text, photographs and plans are for guidance only and are not necessarily comprehensive. It should not be assumed that the property has all necessary planning, building regulation or other consents and Savills have not tested any services, equipment or facilities. Purchasers must satisfy themselves by inspection or otherwise. 20210421GILE

