



This spacious three bedroom townhouse boasts generous living accommodation arranged across three floors, and is offered with no onward chain.

Sturry Street, London, E14

£650,000 Leasehold (987 years remaining)

savills

- Modern three bedroom house
- Two bathrooms, plus separate w.c.
- Well located
- No onward chain
- Private rear garden

Description

A modern three bedroom family home which offers approximately 1,003 sq ft of living space, set across three floors. To the ground floor, there is a generous entrance hallway which leads into a spacious open plan living, comprising of a fitted kitchen of integral appliances, and in addition there is a downstairs cloakroom.

The two upper floors comprise of three double bedrooms and two modern bathroom suites.

Additionally, there is gas rad heating, ample storage space throughout and a private rear garden.

Local Information

All Saints DLR is located within just 0.2 miles, offering swift access into the City. Canary Wharf is located just 0.5 miles, offering access to a variety of local shops, bars and restaurants.

All times and distances are approximate.

Tenure

Leasehold (987 years remaining)

Local Authority

London Borough of Tower Hamlets

Energy Performance

EPC Rating = C

Viewing

All viewings will be accompanied and are strictly by prior arrangement through Savills Canary Wharf Office.

Telephone: +44 (0) 20 7531 2530.





Sturry Street, London, E14
Gross Internal Area 1003 sq ft, 93.2 m²

Stephanie Dang
Canary Wharf
+44 (0) 20 7531 2530
stephanie.dang@savills.com

onTheMarket.com | savills | savills.co.uk

Sturry Street
Gross Internal Area(Approx)
Total = 93.18 Sq m / 1003 Sq ft
For Illustration Purposes Only - Not To Scale
Floorplan by Humble Spy Photography Ltd.
Produces exclusively for Savills

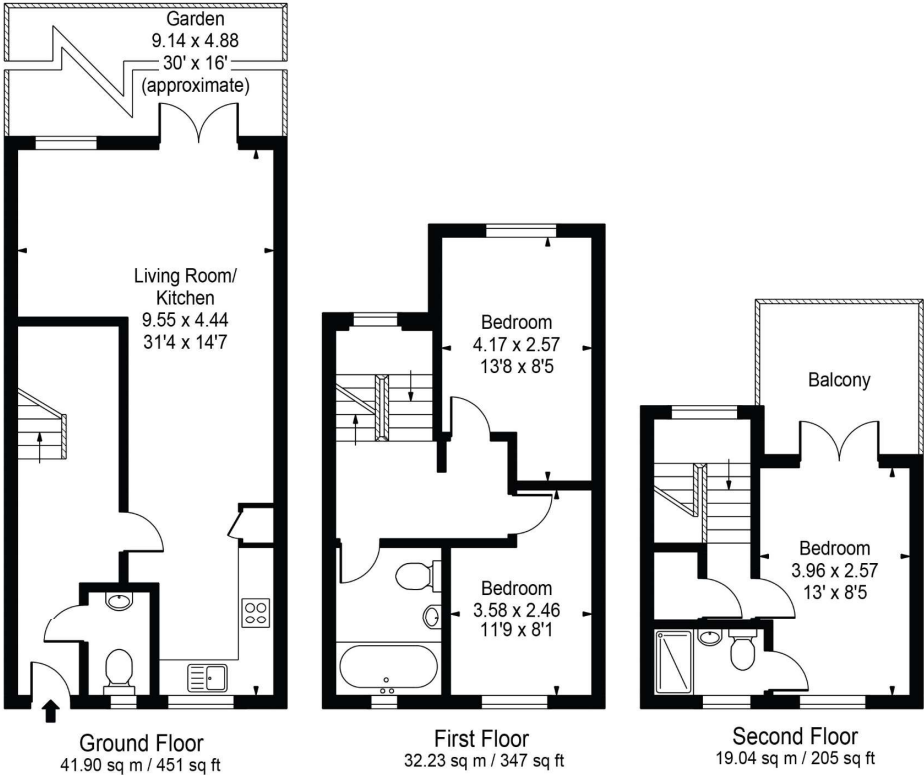

Energy Efficiency Rating		
	Current	Potential
Very energy efficient - lower running costs		
(92+)	76	87
A		
(81-91)		
B		
(69-80)		
C		
(55-68)		
D		
(39-54)		
E		
(21-38)		
F		
(1-20)		
G		
Not energy efficient - higher running costs		
England, Scotland & Wales		
EU Directive 2002/91/EC		

Important Notice Savills, its clients and any joint agents give notice that 1: They are not authorised to make or give any representations or warranties in relation to the property either here or elsewhere, either on their own behalf or on behalf of their client or otherwise. They assume no responsibility for any statement that may be made in these particulars. These particulars do not form part of any offer or contract and must not be relied upon as statements or representations of fact. 2: Any areas, measurements or distances are approximate. The text, photographs and plans are for guidance only and are not necessarily comprehensive. It should not be assumed that the property has all necessary planning, building regulation or other consents and Savills have not tested any services, equipment or facilities. Purchasers must satisfy themselves by inspection or otherwise. 20210416JEAR

