



A bright and airy studio suite which offers impressive views over the London skyline. Residents will benefit from access to a 24 hour concierge and state of the art gymnasium.

**Arena Tower, 25 Crossharbour Plaza, London, E14**

£379,995 Leasehold (985 years remaining)





- High spec studio suite
- Impressive views
- Pristine condition
- Private south facing balcony
- First class facilities

#### Description

Constructed in 2016 by Galliard homes this impressive studio suite offers amazing views across the London skyline. The apartment offers a luxurious finish throughout and benefits from a high specification kitchen with stone work surfaces and a range of Smeg appliances, a designer bathroom suite and a private balcony.

Arena Tower, designed by internationally renowned architects, Skidmore, Owings & Merrill (architects for the One World Trade Center in New York), won the 'Best Residential High-Rise Architecture' prize at the International Property Awards 2017.

Any prospective buyer will also benefit from access to a 24 hour on-site concierge, use of the private cinema and membership of the exclusive Nuffield Club Baltimore gymnasium with offers two floors of state of the art fitness equipment, plus there is a large heated indoor pool, as well as a sauna / steam room.

The development is certified EWS1 fire safety compliant.

#### Local Information

Arena Tower is ideally located, and is within easy reach of both Canary Wharf and The City, as well as Greenwich to the south. Crossharbour DLR station is just moments away, which offers easy connections further into London. There are also a variety of shops restaurants and trendy bars located within close proximity.

All times and distances are approximate

---

#### Tenure

Leasehold(985 years remaining)

#### Local Authority

Tower Hamlets

#### Energy Performance

EPC Rating = B

#### Viewing

All viewings will be accompanied and are strictly by prior arrangement through Savills Canary Wharf Office.

Telephone: +44 (0) 20 7531 2530.







Arena Tower, 25 Crossharbour Plaza, London, E14  
Gross Internal Area 361 sq ft, 35.54 m<sup>2</sup>

Antony Cherriman  
Canary Wharf  
+44 (0) 20 7531 2530  
antony.cherriman@savills.com

 onTheMarket.com |  savills | savills.co.uk

Arena Tower

Gross Internal Area(Approx)

Total = 33.54 Sq m / 361 Sq ft

For Illustration Purposes Only - Not To Scale

Floorplan by Humble Spy Photography Ltd.

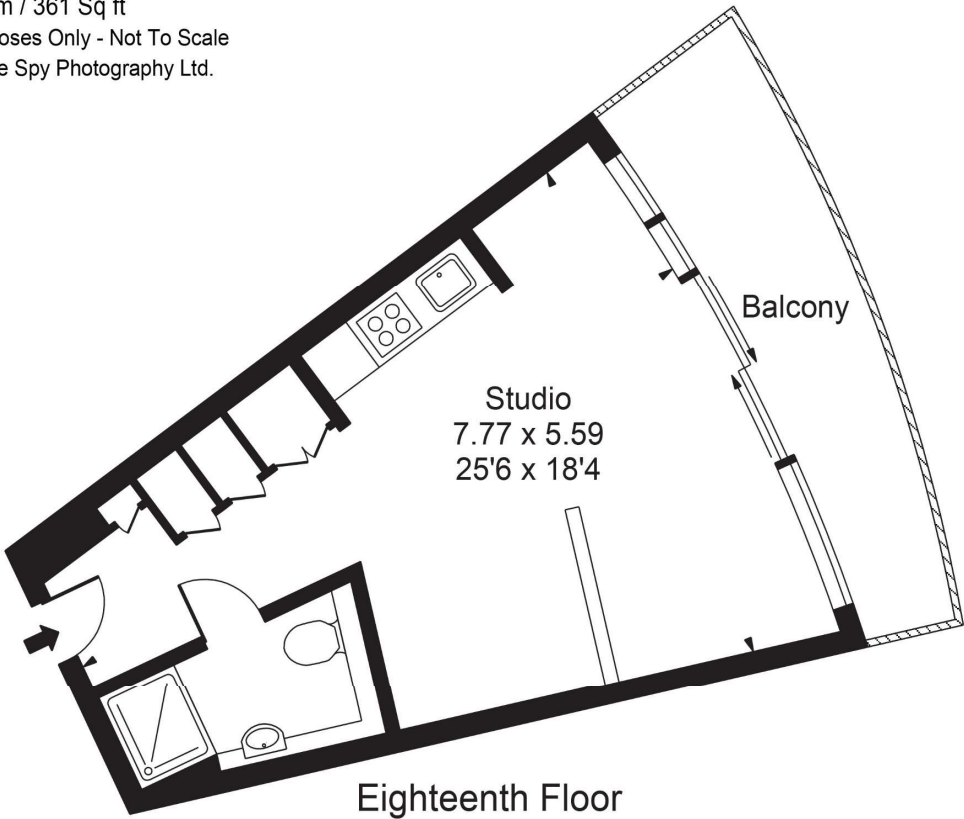

Energy Efficiency Rating		
	Current	Potential
Very energy efficient - lower running costs		
(92+) A		
(81-91) B	82	82
(69-80) C		
(55-68) D		
(39-54) E		
(21-38) F		
(1-20) G		
Not energy efficient - higher running costs		
England, Scotland & Wales	EU Directive 2002/91/EC 	

**Important Notice** Savills, its clients and any joint agents give notice that 1: They are not authorised to make or give any representations or warranties in relation to the property either here or elsewhere, either on their own behalf or on behalf of their client or otherwise. They assume no responsibility for any statement that may be made in these particulars. These particulars do not form part of any offer or contract and must not be relied upon as statements or representations of fact. 2: Any areas, measurements or distances are approximate. The text, photographs and plans are for guidance only and are not necessarily comprehensive. It should not be assumed that the property has all necessary planning, building regulation or other consents and Savills have not tested any services, equipment or facilities. Purchasers must satisfy themselves by inspection or otherwise. 20201123JEAR

