



A stunning family home, which offers cool and contemporary living space set across three floors.

**Hawthorne Crescent, Greenwich, London, SE10**

£900,000 Leasehold (989 years remaining)





- Incredibly spacious four bedroom home
- High end specification
- Private courtyard
- Contemporary living space
- Excellent access to Canary Wharf and the City

### Description

Internal viewing is the only way to appreciate this superb four bedroom family home, which offers approximately 1,355 sq ft of living accommodation arranged across three floors. The overall specification, bespoke fixtures and fittings and quality fit and finish, make this an exciting proposition for those buyers who wish to move straight in with no work to do.

The downstairs comprises of an impressive open plan living area, which offers a high specification kitchen with designer appliances and a breakfast bar, plus there is direct access out to the private courtyard. The upper two floors are made up of four double bedrooms, and two quality bathroom suites. In addition, there is a downstairs cloakroom, floor to ceiling windows which enhance the natural light throughout, a private balcony leading from one of the bedrooms, plus there is an external bin store.

### Local Information

Maze Hill station is positioned within just 0.2 miles offering connections into London Bridge in just 11 minutes, plus buses to North Greenwich in under 15 minutes. There is a lively neighbourhood, filled with a vast range of local shops bars and restaurants nearby.

All times and distances are approximate.

### Tenure

Leasehold (989 years remaining)

### Local Authority

Royal London Borough of Greenwich

### Energy Performance

EPC Rating = B

### Viewing

All viewings will be accompanied and are strictly by prior arrangement through Savills Canary Wharf Office.

Telephone: +44 (0) 20 7531 2530.





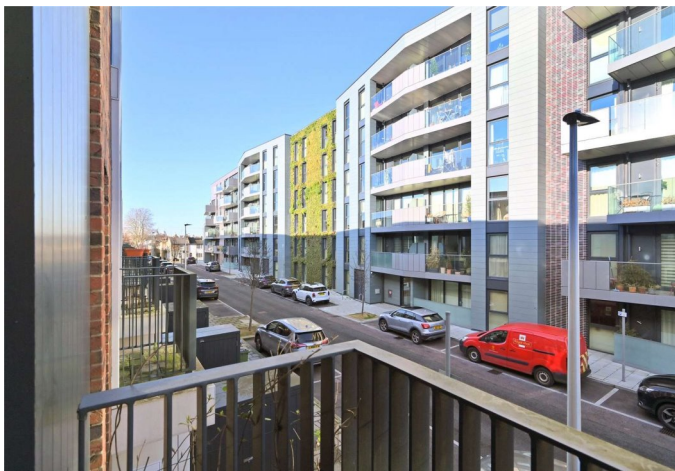



Hawthorne Crescent, Greenwich, London, SE10  
Gross Internal Area 1355 sq ft, 125.9 m²

Antony Cherriman  
Canary Wharf  
+44 (0) 20 7531 2530  
antony.cherriman@savills.com

onTheMarket.com | savills | savills.co.uk

Hawthorne Crescent  
Gross Internal Area(Approx)  
Total = 125.88 Sq m / 1355 Sq ft  
(Excluding Store)

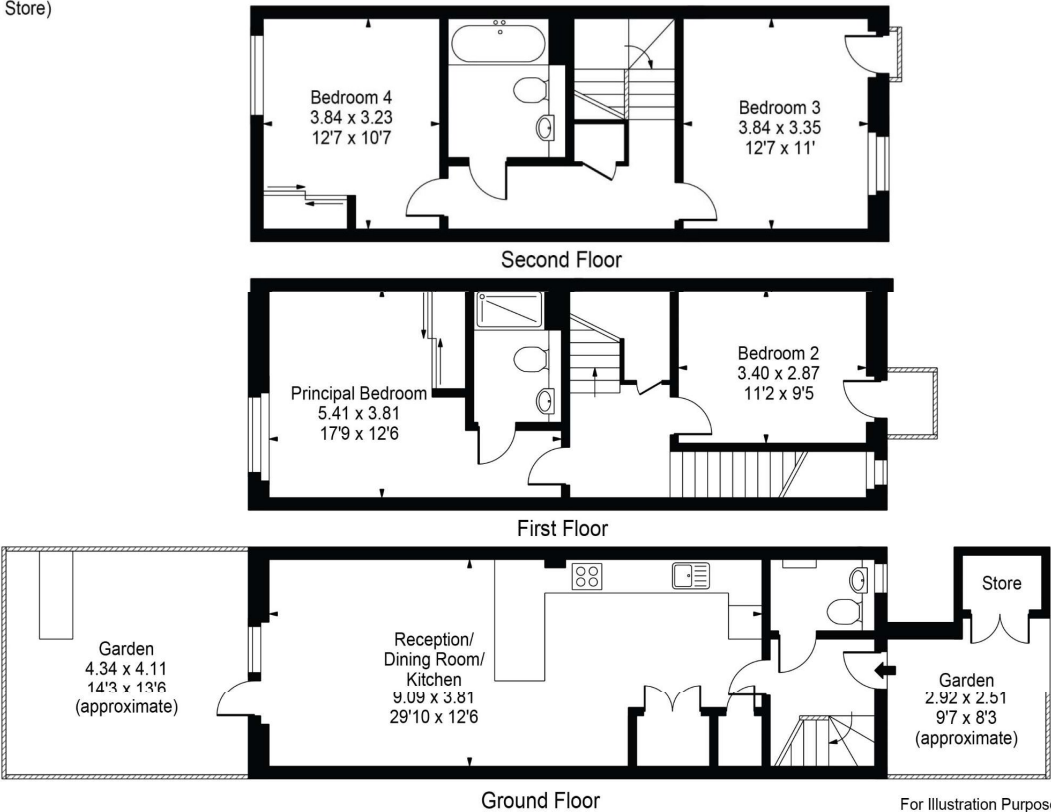

For Illustration Purposes Only - Not To Scale  
Floorplan by Humble Spy Photography Ltd.  
Produces exclusively for Savills

Energy Efficiency Rating		
	Current	Potential
Very energy efficient - lower running costs		
(92+) A		94
(81-91) B	86	
(69-80) C		
(55-68) D		
(39-54) E		
(21-38) F		
(1-20) G		
Not energy efficient - higher running costs		
England, Scotland & Wales	EU Directive 2002/91/EC	

**Important Notice** Savills, its clients and any joint agents give notice that 1: They are not authorised to make or give any representations or warranties in relation to the property either here or elsewhere, either on their own behalf or on behalf of their client or otherwise. They assume no responsibility for any statement that may be made in these particulars. These particulars do not form part of any offer or contract and must not be relied upon as statements or representations of fact. 2: Any areas, measurements or distances are approximate. The text, photographs and plans are for guidance only and are not necessarily comprehensive. It should not be assumed that the property has all necessary planning, building regulation or other consents and Savills have not tested any services, equipment or facilities. Purchasers must satisfy themselves by inspection or otherwise. 20220106JEAR

