



Bright and spacious first floor one-bedroom flat with off-street parking

Park Mansions, 14 Stamford Brook Avenue, London, W6

Leasehold (970 years remaining)



Local Information

Situated on the borders of Chiswick and Ravenscourt Park overlooking Stamford Brook common. Stamford Brook Underground station (District line) is approximately 0.2 miles. Turnham Green Underground station (District & Piccadilly lines) is approximately 0.5 miles and has excellent access to the shops on Turnham Green Terrace and Chiswick High Road. There is also easy access to central London via the A4, and to Heathrow Airport and the west of England via the M4.

Description

Park Mansions is a modern development adjacent to Stamford Brook Common.

The reception room benefits from double doors with a Juliet balcony which provides an abundance of natural light and fabulous views across the common.

There is a separate kitchen / breakfast room.

The bedroom is of a good size with fitted wardrobes and a separate well-appointed bathroom.

The flat offers gated off-street parking at the back of the building with one designated parking space.

Local Authority

Hounslow

Energy Performance

EPC Rating = C

Viewing

All viewings will be accompanied and are strictly by prior arrangement through Savills Chiswick Office. Telephone: +44 (0) 20 8987 5550.

Park Mansions, 14 Stamford Brook Avenue, London, W6
Gross Internal Area 528 sq ft, 49.1 m²

OnTheMarket.com | savills | savills.co.uk

Euan Rollo
Chiswick
+44 (0) 20 8987 5550
euan.rollo@savills.com



Score	Energy rating	Current	Potential
92+	A		
81-91	B		
69-80	C	78 C	78 C
55-68	D		
39-54	E		
21-38	F		
1-20	G		

Park Mansions,
Stamford Brook Avenue, W6
Approximate Gross Internal Area
49.03 sq m / 528 sq ft
(CH = Ceiling Heights)



First Floor

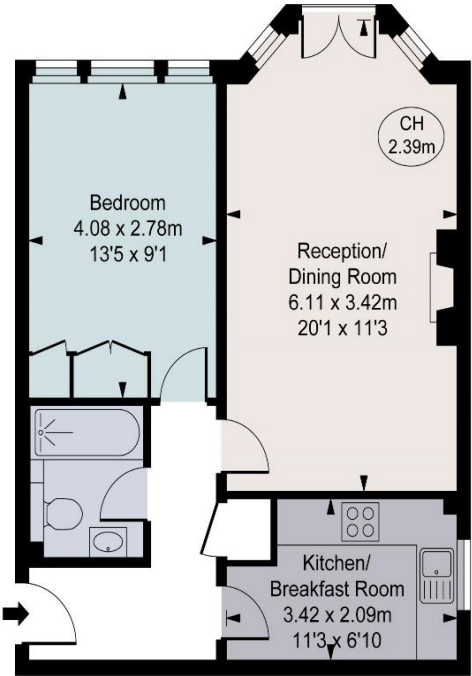

This plan is not to scale. It is for guidance and not for valuation purposes.
All measurements and areas are approximate only, and have been prepared in accordance with the current edition of the RICS Code of Measuring Practice.
© Fulham Performance



Important Notice Savills, its clients and any joint agents give notice that 1: They are not authorised to make or give any representations or warranties in relation to the property either here or elsewhere, either on their own behalf or on behalf of their client or otherwise. They assume no responsibility for any statement that may be made in these particulars. These particulars do not form part of any offer or contract and must not be relied upon as statements or representations of fact. 2: Any areas, measurements or distances are approximate. The text, photographs and plans are for guidance only and are not necessarily comprehensive. It should not be assumed that the property has all necessary planning, building regulation or other consents and Savills have not tested any services, equipment or facilities. Purchasers must satisfy themselves by inspection or otherwise. Formatter.GetFullDateString(DateTime.Now, "yyyyMMdd")>EEFM

