



Spacious two bedroom apartment with secure parking

Vitae Apartments, Goldhawk Road, London, W6

Leasehold



2 bedrooms • open-plan kitchen / reception room • bathroom • shower room (en suite) + walk in wardrobe • 2 balconies • allocated parking space + communal gardens • first floor • 95.04 sq m (1,023 sq ft)

Local information

Goldhawk Road is situated on the borders of Chiswick and Hammersmith. The many boutiques and restaurants of Chiswick High Road and King Street are close by. Stamford Brook underground station (District Line) is approximately 0.3 miles away.

The A4 gives rapid access into Central London and out to the West.

About this property

An ideal opportunity to acquire this secluded spacious two bedroom apartment superbly located to local amenities on Chiswick High Road, Kings Street and the sought after Ravenscourt Park.

The tastefully presented two bedroom apartment set within a sought after gated development with allocated parking. The apartment is situated on the first floor and the entertaining space provides a large kitchen / dining room with access out to a balcony overlooking the communal gardens.

The accommodation offers a large master bedroom with an en suite shower room, a separate walk in wardrobe and access to a balcony overlooking the gardens. The second bedroom is of a good size and offers a large amount of storage.

This would make a wonderful home or long term investment.

Tenure

Leasehold

EPC rating = C

Viewing

Strictly by appointment with Savills





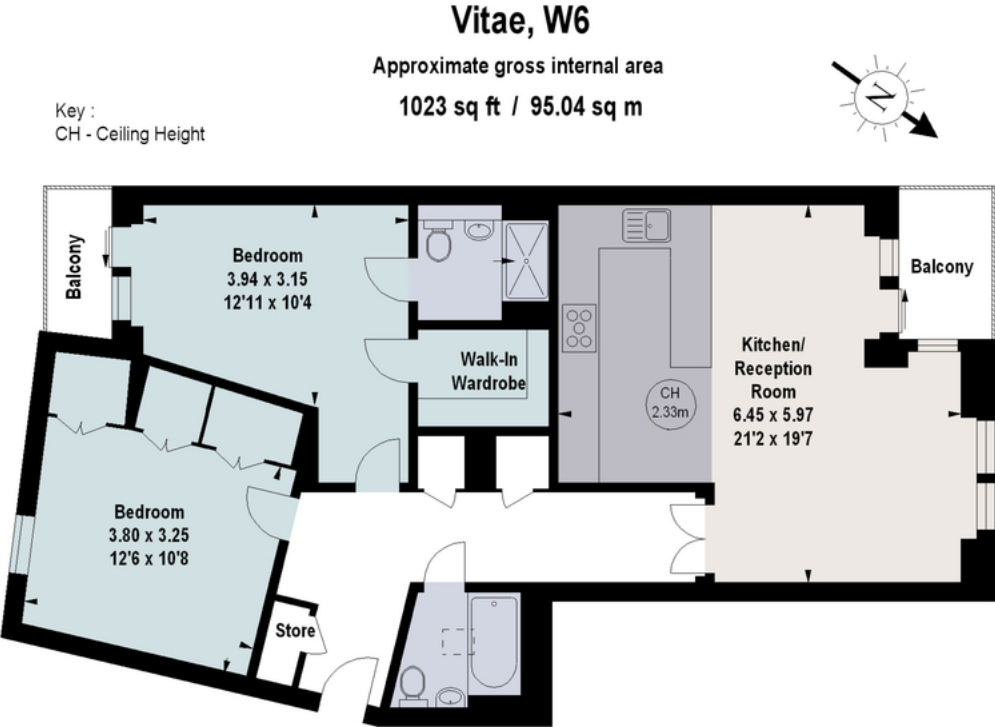

First Floor

The floor plan is not to scale and measurements and areas shown are approximate and therefore should be used for illustrative purposes only. The plan has been prepared in accordance with the RICS code of Measuring Practice and whilst we have confidence in the information produced, it must not be relied on. If there is any aspect of particular importance, you should carry out or commission your own inspection of the property.
Copyright of FeaturePRO.

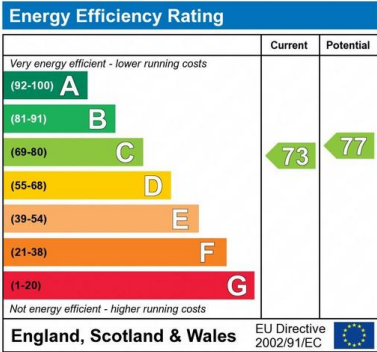

Important notice: Savills, their clients and any joint agents give notice that 1: They are not authorised to make or give any representations or warranties in relation to the property either here or elsewhere, either on their own behalf or on behalf of their client or otherwise. They assume no responsibility for any statement that may be made in these particulars. These particulars do not form part of any offer or contract and must not be relied upon as statements or representations of fact. 2: Any areas, measurements or distances are approximate. The text, photographs and plans are for guidance only and are not necessarily comprehensive. It should not be assumed that the property has all necessary planning, building regulation or other consents and Savills have not tested any services, equipment or facilities. Purchasers must satisfy themselves by inspection or otherwise. 02026030 Job ID: 142128 User initials: EF